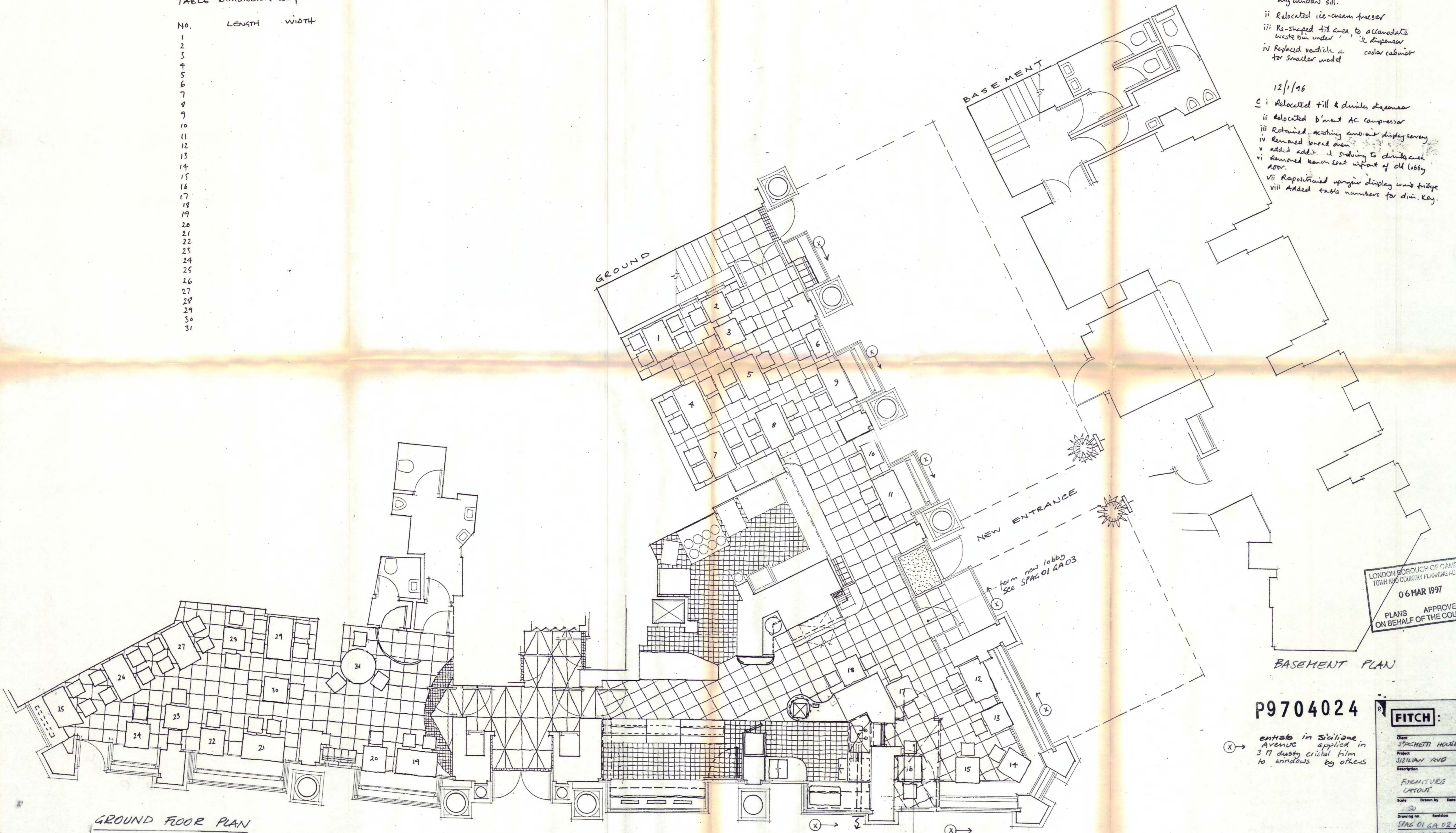

TABLE DIMENSION KEY

NO.	LENGTH	WIDTH
1		
2		
3		
4		
5		
6		
7		
8		
9		
10		
11		
12		
13		
14		
15		
16		
17		
18		
19		
20		
21		
22		
23		
24		
25		
26		
27		
28		
29		
30		
31		

- REVISIONS
 A original des.
 B 5/1/96
- i Relocated coffee machine into bay window sill.
 - ii Relocated ice-cream freezer
 - iii Re-shaped till area to accommodate waste bin under till dispenser
 - iv Replaced vertical cooler cabinet for smaller model

- 12/1/96
- C i Relocated till & drinks dispenser
 - ii Relocated bin & AC compressor
 - iii Retained existing ambient display screen
 - iv Removed bench oven
 - v added add'l seating to drinks area
 - vi Removed bench seat in front of old lobby door.
 - vii Repositioned upright display units & fridge
 - viii Added table numbers for dim. key.



LONDON BOROUGH OF CAMDEN
 TOWN AND COUNTRY PLANNING ACTS
 06 MAR 1997
 PLANS APPROVED
 ON BEHALF OF THE COUNCIL

BASEMENT PLAN

P9704024

entab in Sialiane Avenue applied in 3 M dusty crystal film to windows by others

remove existing lobby enclosure exclusive of soffit over - form new window - see SPAG 01-GA 03

FITCH:

Client: SPAGHETTI HOUSE
 Project: SIALIAN AVE
 Description: FURNITURE LAYOUT
 Scale: 1:50
 Drawing no.: SPAG 01 GA 02 A
 Revision: 1
 Dimensions to be verified on site. Figured dimensions to be taken in preference to those scaled.
 This drawing is the copyright of Fitch. This drawing cannot be copied, reproduced, retained or disclosed in any unauthorised period.
 Fitch, Commonwealth House, 1 New Oxford Street, London WC1A 1TFW
 Tel: (0171) 208 8000
 Fax: (0171) 208 0200

GROUND FLOOR PLAN