

1 Proposed - South-East Elevation

1:100

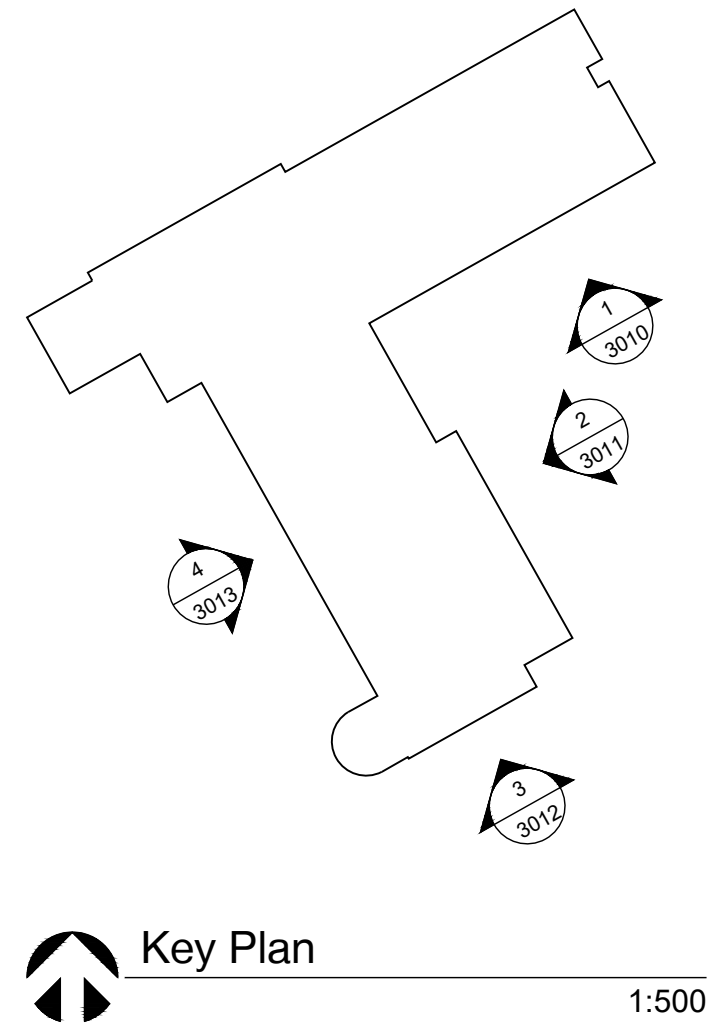

Key Plan

1:500

MATERIAL KEY

A	white aluminium windows
B	red brickwork
C	black cast iron rainwater and foulwater goods
D	parapet coping
E	white render

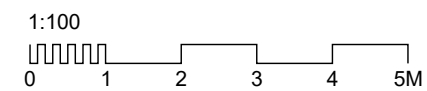

PLEASE NOTE
 FOR CONSTRUCTION PURPOSES USE ONLY FIGURED DIMENSIONS. THIS DRAWING MUST ALWAYS BE READ IN CONJUNCTION WITH ALL RELEVANT PROJECT DETAILS. ALL DIMENSIONS MUST BE CHECKED ON SITE PRIOR TO COMMENCEMENT. PLEASE REPORT ANY DISCREPANCY TO THE ARCHITECT OR CONTRACT ADMINISTRATOR
 © COPYRIGHT HMY 2015

Revisions		
P1	29.06.2020	TT PLANNING ISSUE

Drawing Proposed Elevations - Huntley Centre Sheet 01		Date 06 2020
Project/Client Huntley Centre NHS Foundation Trust, Camden		Scale @ A3 1:100
Job reference 02338	Drawing number 3010	Revision P1
		Purpose of Issue Approval



HazleMcCormackYoung LLP/Chartered Architects/
 3 Turnagain Lane/ Palace Street/ Canterbury/ Kent/
 CT1 2ED/ t 01227 454497/ f 01227 451372