

B BASEMENT

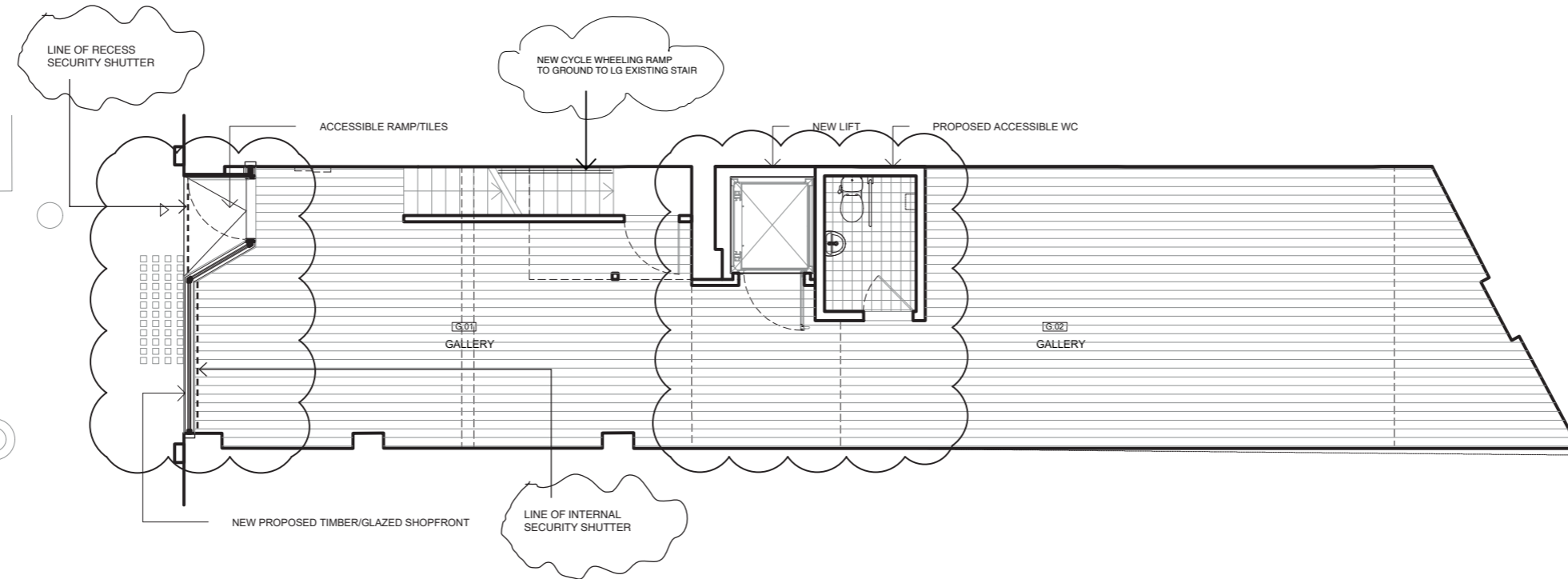

G GROUND FLOOR

THEOBALD'S ROAD

MATHESON WHITELEY
 Unit 2, Culford House,
 1-7 Orsman Road
 London N1 5RA
 T: +44 (0) 207 033 3589
 studio@mathesonwhiteley.com

- Notes:
- All dimensions are from structure-to-structure unless indicated otherwise.
 - Elements of structure and services are indicated for coordination purposes. For full structural and services layouts refer to Structural and Services Engineer's drawings.
 - Do not scale directly from drawing. All dimensions to be checked on site prior to construction or fabrication of any elements.
 - Any discrepancies between figured dimensions to be reported to architect for clarification prior to commencing work.

- Revision:
- 20.12.2019 PLANNING-APPLICATION
 - A** 04.03.2020 PLANNING-APPLICATION
 - B** 28.05.2020 BIKE-STORAGE
 - C** 01.07.2020 SECURITY SHUTTER POSITION INDICATED

Client:	CSII (UK) LTD.	Scale:	1:100	Drw:	EV
		Date:	MARCH 2020	Chk:	DM
Project:	113 MIMOSA HOUSE	Title:	PROPOSED FLOOR PLANS - BASEMENT & GROUND FLOOR		
Status:	PLANNING	Drawing no:	014	Rev:	C