

Note:
This drawing is to be read in connection with the scope of works and drawings 3870(03)143/ 144/ 243/ 244, 3870(04)143 and 3870(05)143.

Site visit required to confirm extent of works undertaken.

Grilles removed from all windows.

New stair to be fitted in accordance with Buildings regulations.

AS PROPOSED

Unit 29 Ground Floor
100.09
36.1 m²

- 1 EXISTING STAIRCASE REMOVED, WALLS & FLOOR MADE GOOD - AS EXISTING
- 2 EXISTING STAIRCASE REMOVED, FLOORING MADE GOOD - AS EXISTING

PLANS APPROVED
01 MAY 2007

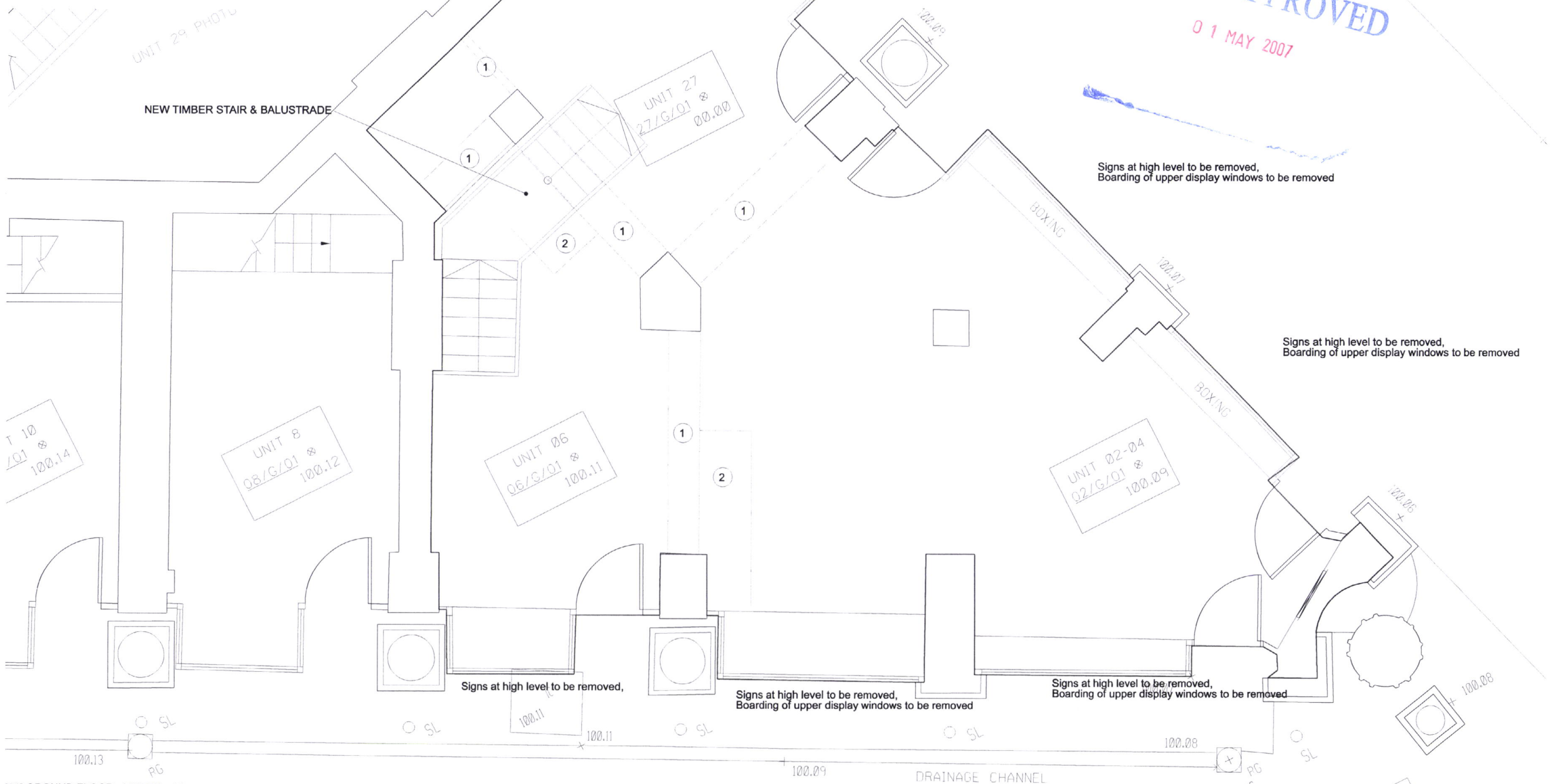

[01] GROUND FLOOR - UNIT 02 - 04

no	description	date	by	check	status
01	FOR PLANNING	12.12.06	JO		
02	FOR PLANNING	01.03.07	IC		

DRAWING: UNIT 02 - 06 & 27: GROUND FLOOR PROPOSED PLAN PROJECT: SICILIAN AVENUE DRAWN BY: [blank] DATE: MAY 2006 SCALE: 1:25 @ A1 1:50 @ A3 PROJECT NO: 3870 DWG NO: (03)143 DATE: 02 T A T E		HINDLE
FOR PLANNING <small>DATE & HINDLE DESIGN LIMITED 1 Lindsey Street, Smithfield, London EC1A 9PP. T 020 7342 4800 F 020 7342 4890 E mail@hindle.co.uk W www.hindle.co.uk</small>		