

BD 01

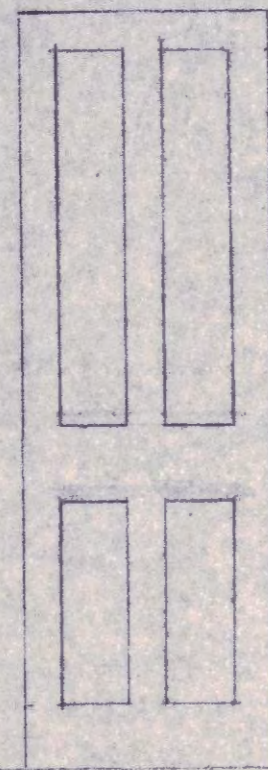

BD 02

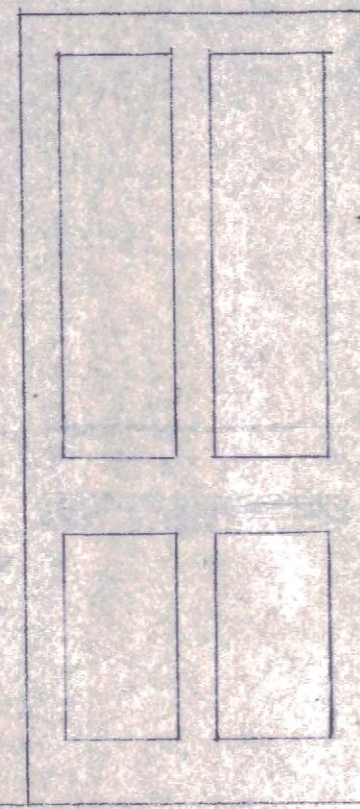

BD 03

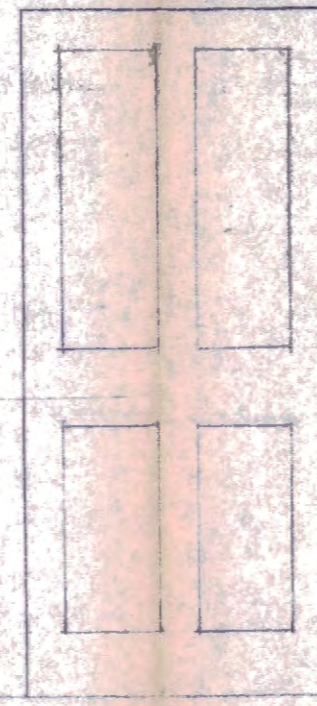

3D 01

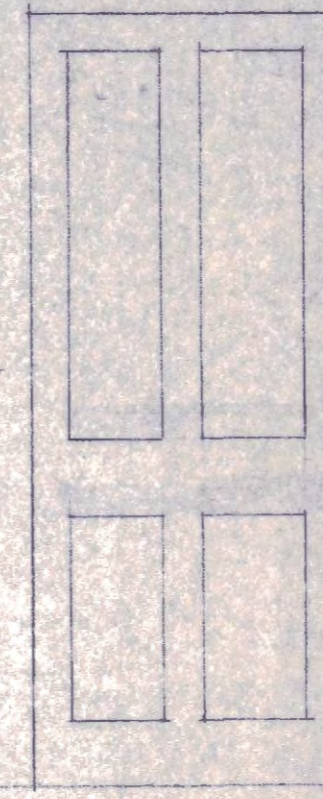

3D 03

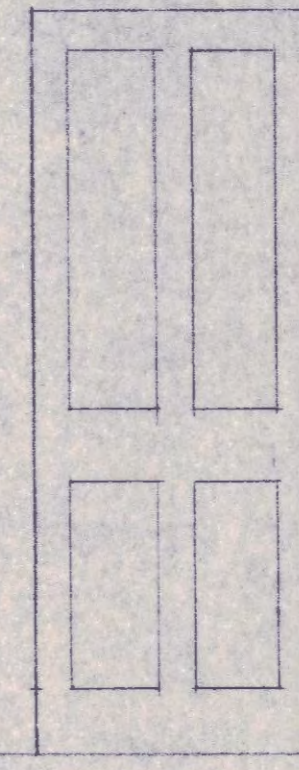

3D 07

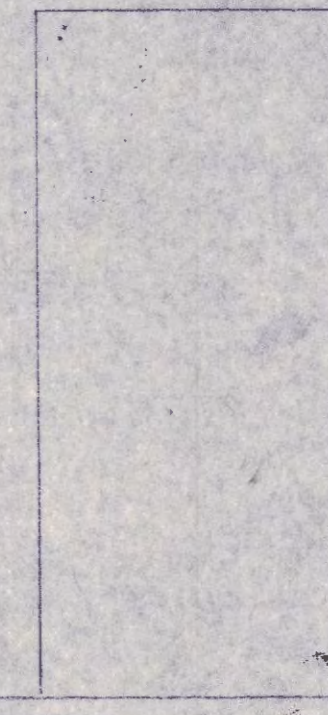

RD 01

- 1) DO NOT SCALE FROM THIS DRAWING. ALL DIMENSIONS TO BE CHECK ON SITE PRIOR TO MANUFACTURE, FABRICATION OR INSTALLATION.
- 2) FOR DETAILS OF FINISHES SEE FINISHES SCHEDULE.
- 3) REPLACEMENT DOORS BD01, 02, 03, 08, 3D06, 07, 4D01, 02, 3, 7 TO MATCH DOORS 2D01. REFER TO DRAWING NO 7656 F 006 (DETAILS OF DOOR AND ARCHITRAVE PROFILE). REPLACEMENT DOORS 4D05, 06 AND RD01 ARE TO BE FLUSH PANEL DOORS. ALL DOOR SIZES ARE TO MATCH EXISTING OPENINGS. ALL NEW PANELLED DOORS TO HAVE ARCHITRAVES TO MATCH DOOR 2D01.
- 4) CHECK EXISTING FRAMES AND STOPS FOR FIRE RATINGS AND UPGRADE AS NECESSARY. DOORS TO ACHIEVE FIRE RATINGS AS DESCRIBED ON GENERAL PLANS.
- 5) FOR DOOR IRONMONGERY REFER TO IRONMONGERY SCHEDULE.
- 6) REFER ALSO TO SCOPE OF WORKS AND SPECIFICATION.
- 7) PREPARE NEW DOOR FRAMES, LEAFS AND ARCHITRAVES, PRIME, UNDERCOAT AND DECORATE WITH FINISHCOAT, REFER TO FINISHES SCHEDULE.

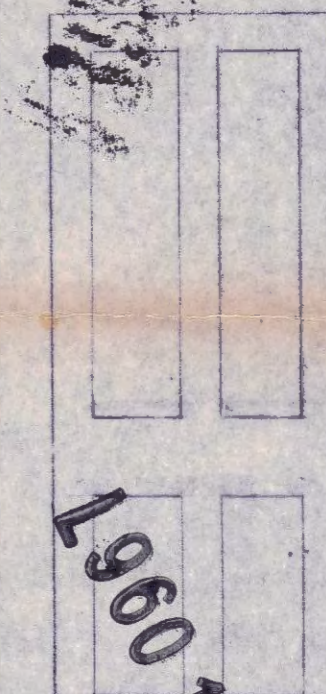

BD 08

revisions A NOTES ADDED AND AMENDED BY ME 11/11/96

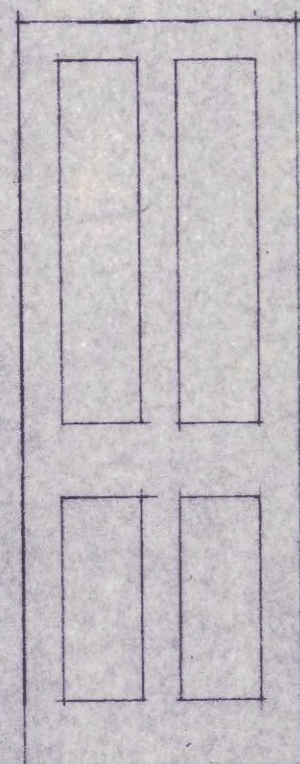

4D 01

DOOR MOLDINGS TO PANELLED DOORS TO MATCH DOOR 2D01.

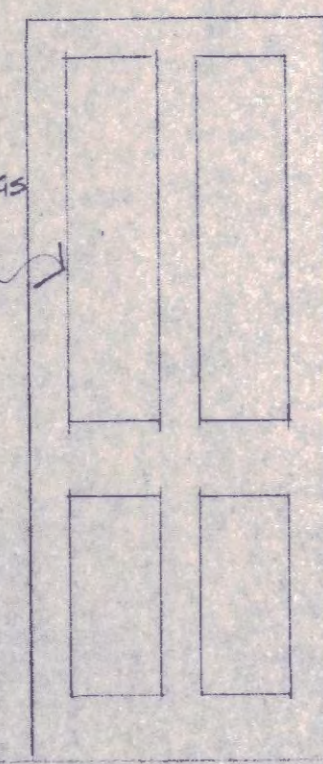

4D 02

IN GENERAL APPEARANCE, DEPTHS OF RAILS AND WIDTHS OF STILES TO MATCH DOOR 2D01, REFER TO NOTE 3.

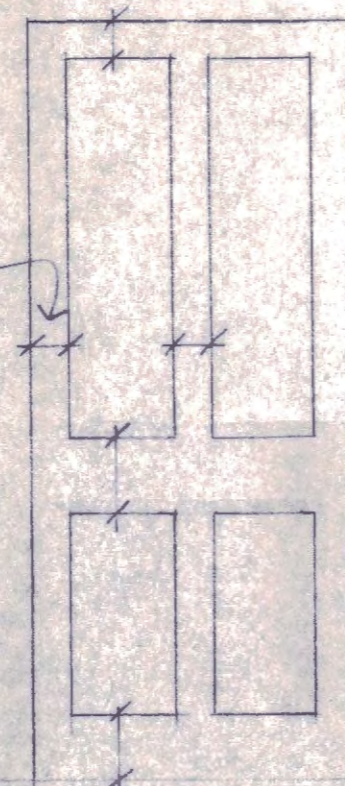

4D 03



4D 05



4D 06

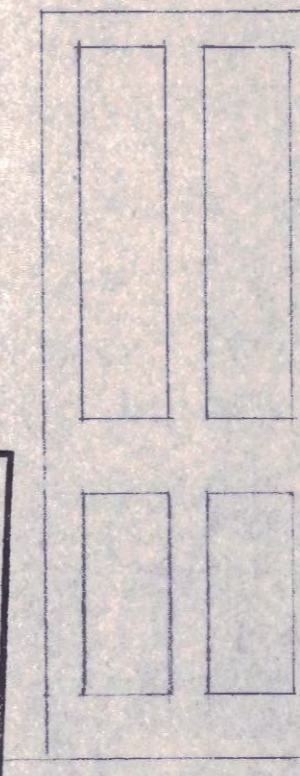

4D 07

LONDON BOROUGH OF CAMDEN
TOWN AND COUNTRY PLANNING ACTS
17 OCT 1996
APPROVED
ON BEHALF OF THE COUNCIL

TP BENNETT

TP Bennett Partnership
Architects and Planning Consultants
262 High Holborn
London WC1V 7DU

Telephone: 071-405 9277
Facsimile: 071-405 3568

contract title
45 BLOOMSBURY SQUARE

checked

drawing title
NEW DOOR LEAF ELEVATIONS.

scale 1:20

date MAY 96

drawn T.S.

contract drawing number
7656 Q 012

revision

A