

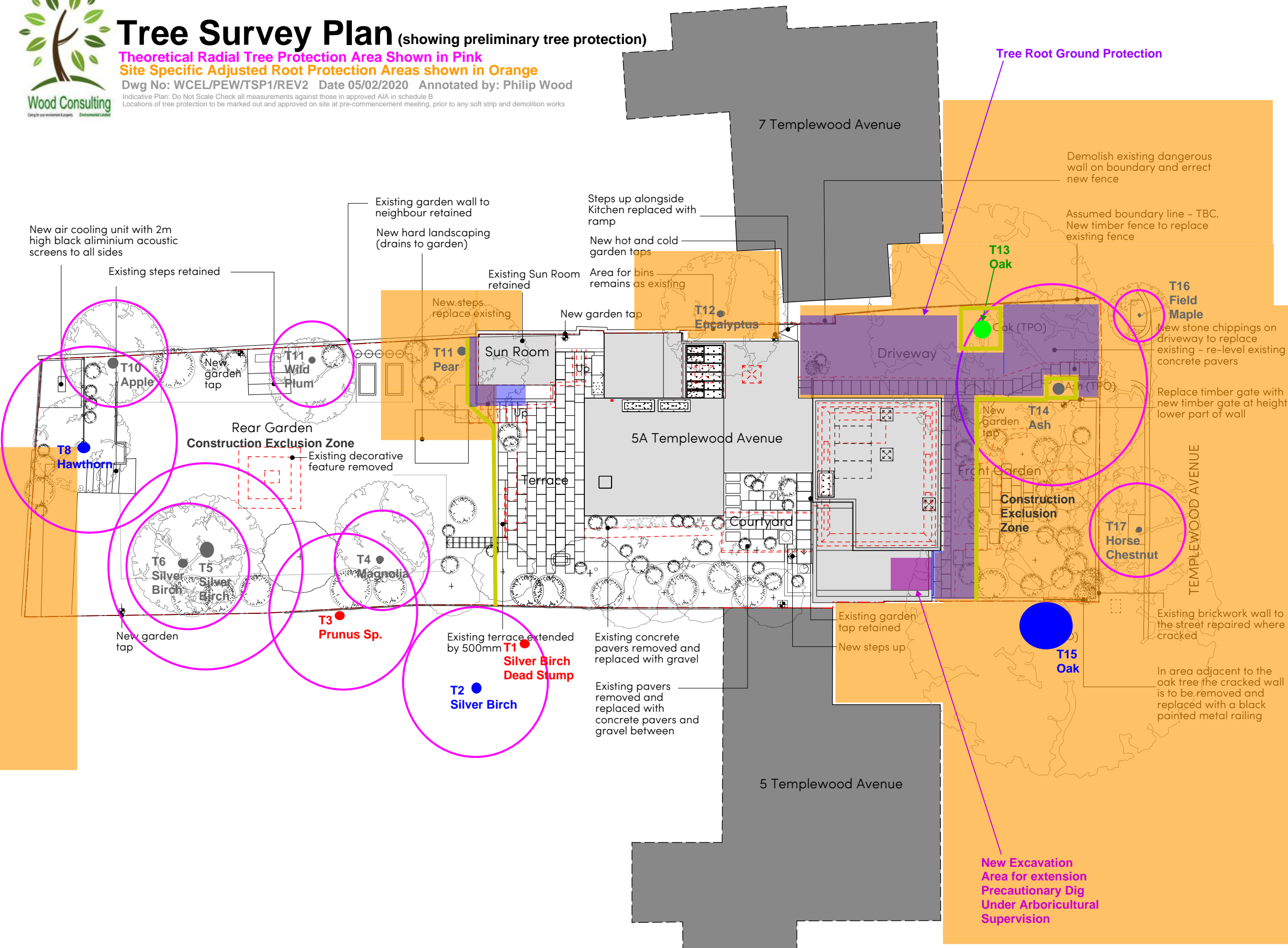

# Tree Survey Plan (showing preliminary tree protection)

**Theoretical Radial Tree Protection Area Shown in Pink**  
**Site Specific Adjusted Root Protection Areas shown in Orange**  
 Dwg No: WCEL/PEW/TSP1/REV2 Date 05/02/2020 Annotated by: Philip Wood  
 Indicative Plan: Do Not Scale Check all measurements against those in approved AIA in schedule B  
 Locations of tree protection to be marked out and approved on site at pre-commencement meeting, prior to any soft strip and demolition works



Notes  
 © Coppin Dockray Architecture & Design  
 Do not scale from this drawing use figured dimensions only  
 All dimensions are to be checked on site by the Contractor and such dimensions are to be their responsibility  
 This drawing should not be used to calculate areas for the purposes of valuation  
 Report any discrepancies, drawing errors and omissions to the Architect immediately  
 All structural elements are to be designed by the Structural Engineer  
 All work must comply with relevant British Standards and Building Regulations requirements

--- Site Boundary  
 --- Demolitions

**T? Tree Number**  
 ● BS5837 Category A Tree  
 ● BS5837 Category B Tree  
 ● BS5837 Category C Tree  
 ● BS5837 Category U Tree  
 □ Tree Protection Fence/Barrier  
 □ Tree Root Ground Protection  
 □ Precautionary Dig Location

Revisions	
A	03/02/20 Master Bedroom extension stepped back courtyard paving revised and gravel added.

**C D**  
 Coppin Dockray  
 Architecture & Design  
 56 Highpoint, North Hill  
 London N6 4AZ  
 mail@coppindockray.co.uk  
 www.coppindockray.co.uk  
 +44 (0)7906 025 428

Project Name  
**Dannatt House, Templewood Avenue**

Client  
**Ruby and Julian Furman**

Scale @ A1	1:250 @ A3	Status	For Planning
Date	23/10/19	Drawn By	BD
Job Number	1803	Checked By	SC

Title	Rev
Proposed Site Plan	
Drawing No.	
<b>1803-PL-01</b>	<b>A</b>

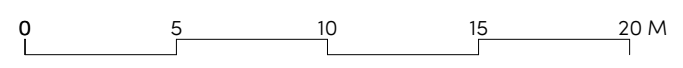

**A** PROPOSED SITE PLAN 1:250 @ A3

