

LEASE



See plan on back page.

9th August

2006

LR1. Date of lease

LR2. Title number(s)

LR2.1 Landlord's title number(s)
NGL861316

LR2.2 Other title numbers
NONE

LR3. Parties to this lease

Landlord
REDVIEW LIMITED whose registered office is
at 21 Bedford Square London WC1B 3HH
(company registration number 4654184)

Tenant
NICK KEARVELL of West Ridge Tinwell
Stamford Lincolnshire

LR4. Property

In the case of a conflict between this clause
and the remainder of this lease then, for the
purposes of registration, this clause shall
prevail.

All that fifth floor flat as the same is more
particularly described in Part II of the First
Schedule hereto and known as Flat 3 Camden
Place 106-110 Kentish Town Road London
NW1 9PX

LR5. Prescribed statements etc.

LR5.1 NONE

LR5.2 NONE

LR6. Term for which the Property
is leased

The term is as follows:
125 years from 25 March 2006

LR7. Premium

£250,000.00

LR8. Prohibitions or restrictions
on disposing of this lease

This lease contains a provision that prohibits
or restricts dispositions.



FIFTH FLOOR
GROSS INTERNAL
FLOOR AREA 667 SQ FT

GROSS INTERNAL FLOOR AREA 667 SQ FT / 62 SQ M
Ref: BGWH- 110-116 KENTISH TOWN ROAD Copyright photo-plan.co.uk

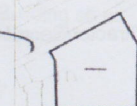

SITE PLAN NOT TO SCALE

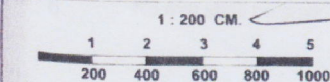

Scale : For the plan to be in scale, the above
scale bar must measure correct e.g 5 centimeters when printed.

Photo-plan Limited,
Northumberland House,
11 The Pavement, Popes Lane,
Ealing,
London, W5 4NG
T.020 8832 7450

106-110 KENTISH TOWN ROAD

Drawing title

BGWH- 106-110 KENTISH TOWN ROAD, FLAT 3

scale

1 : 200 AT A4

date

drawing no.

revision

DO NOT SCALE FROM DRAWING. ALL DIMENSION TO BE CHECKED ON SITE

This official copy is incomplete without the preceding notes page.