

ER1F – WILD FLOWERS FOR GREEN ROOFS

Composition

This wild flower mixture is suitable for sowing onto engineered substrates of green roof schemes.

Wild Flowers

%	Latin name	Common name
3	<i>Agrimonia eupatoria</i>	Agrimony
5	<i>Anthyllis vulneraria</i>	Kidney Vetch
1	<i>Calluna vulgaris</i>	Ling - (Common Heather)
7.5	<i>Centaurea nigra</i>	Common Knapweed
3	<i>Filipendula vulgaris</i>	Dropwort
10	<i>Galium verum</i>	Lady's Bedstraw
1	<i>Helianthemum nummularium</i>	Common Rock-rose
3.5	<i>Hippocrepis comosa</i>	Horseshoe Vetch
5	<i>Hypericum perforatum</i>	Perforate St John's Wort
2.5	<i>Knautia arvensis</i>	Field Scabious
5	<i>Leontodon hispidus</i>	Rough Hawkbit
7.5	<i>Leucanthemum vulgare</i>	Oxeye Daisy - (Moon Daisy)
2.5	<i>Lysimachia arvensis - (Anagallis arvensis)</i>	Scarlet Pimpernel
5	<i>Malva moschata</i>	Musk Mallow
1.5	<i>Ononis spinosa</i>	Spiny Restharrow
6	<i>Organum vulgare</i>	Wild Marjoram
5	<i>Plantago media</i>	Hoary Plantain
5	<i>Primula veris</i>	Cowslip
2.5	<i>Prunella vulgaris</i>	Selfheal
2.5	<i>Ranunculus bulbosus</i>	Bulbous Buttercup
0.5	<i>Reseda lutea</i>	Wild Mignonette
2.5	<i>Rumex acetosella</i>	Sheep's Sorrel
3.5	<i>Salvia verbenaca</i>	Wild Clary
2.5	<i>Scabiosa columbaria</i>	Small Scabious
2.5	<i>Silene vulgaris</i>	Bladder Campion
1	<i>Teucrium scorodonia</i>	Wood Sage
3.5	<i>Verbascum nigrum</i>	Dark Mullein
100		

Note:

1. Metal guarding around access hatch entry. To be same colour as plant screen
2. Metal balustrade and fixing.
3. -
4. -
5. -
6. -
7. -
8. -
9. -
10. -
11. -
12. Roof deck
13. Root-resistant waterproofing membrane
14. Blackdown moisture/protection mat.
15. 20mm Blackdown drainage layer
16. Blackdown filter sheet.
17. Blackdown biodiverse substrate. Min 80mm depth
18. Biodiverse planting, plant material: Wild Flower Seed Mix ER1F, Species and density as per detail no. 4
19. Blackdown perimeter pebbles ballast
20. Additional Blackdown moisture/protection mat to sit on top of drainage layer and continue onto upstand.

Drawing for approval of Condition 12 of consented scheme 2019/6088/P

For details on maintenance refer to Section 4 of the 'Green Roof Biodiversity Management Plan' attached to this application.

01 Reference Plan for extent of Biodiverse roof - See drawing 20.210 Rev P8 of consented scheme 2019/6088/P
27.601 1:200@A3

- Green roof
- Acoustic plant screen
- Fall restraint

04 Details of planting species and density
27.601 Plant material : Wild Flower Seed Mix ER1F

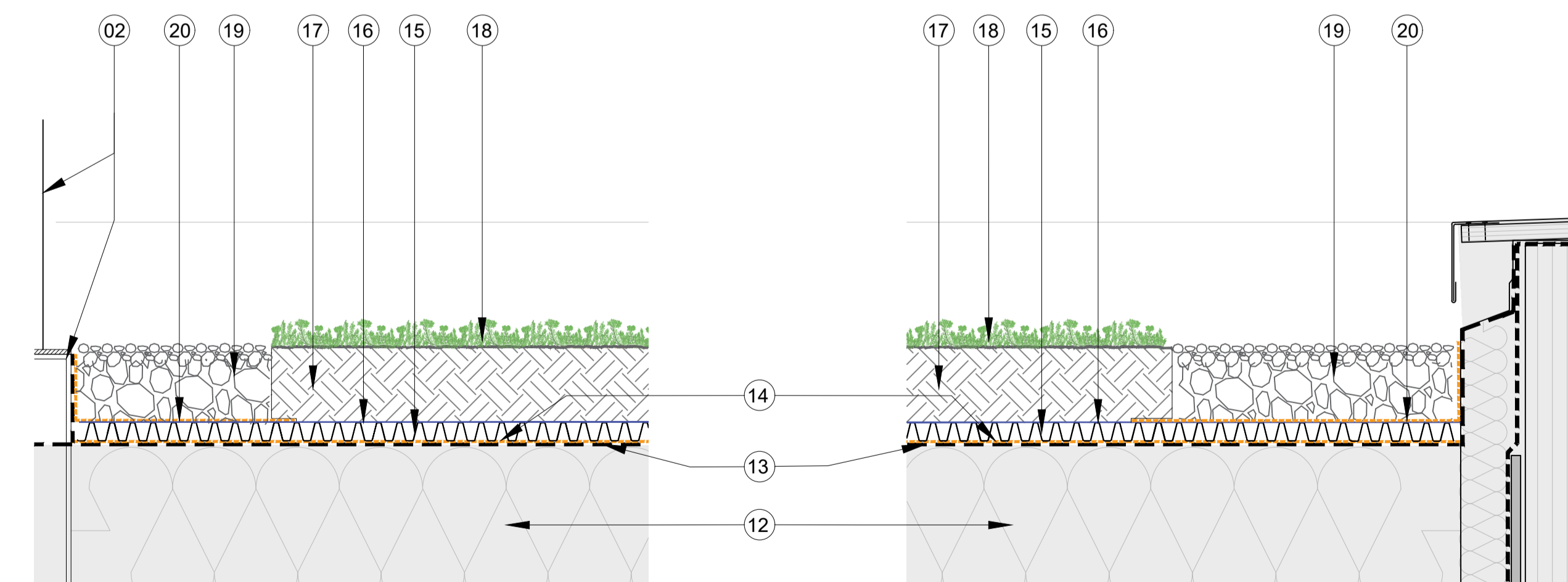

02 Typical Biodiverse Roof Build-up - Section Detail
27.601 1:10@A3

02 Typical Biodiverse Roof Abutment/Perimeter Detail
27.601 1:10@A3

0 50 100 150 300mm
1:5

P1 Issued For Planning AC 08.06.20

Rev. Description. By Date

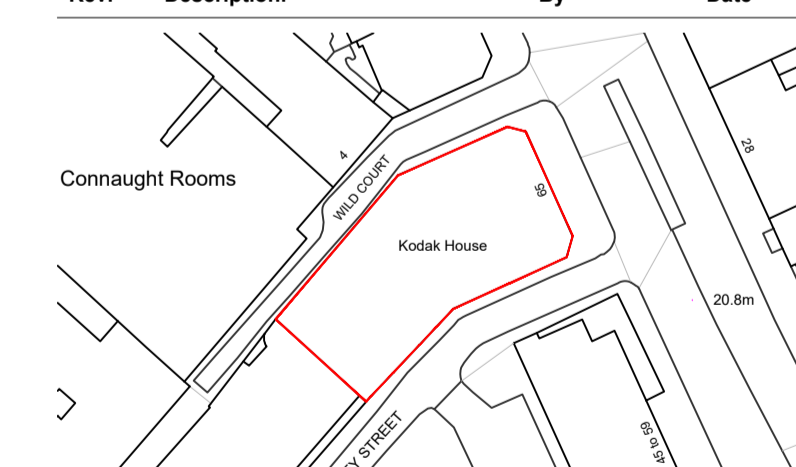

Client
Kings Keeley Limited C/o Clearbell Capital LLP
Project
65 Kingsway - Base Scheme

Status	Purpose of issue	RIBA stage		
S2	For Planning	2		
Project No.	Drawn	Checked	Scale	Rev.
1914	FB	TJ/GV	AS SHOWN	P1

Drawing No.
1914-BG-01-ZZ-DR-A-27.601

Do not scale from this drawing. The Contractor is to take and check all dimensions on site before work commences. Discrepancies must be reported to the Architect. Subcontractors must verify all dimensions on site before making a shop drawing or commencing manufacturing. This drawing is copyright. ©

© Copyright Barr Gazetas Ltd.
A 10 Heddon Street, London, W1B 4BG
T 0207 638 5981
W www.barrgazetas.com