

23015(5)
HB 1480(5)

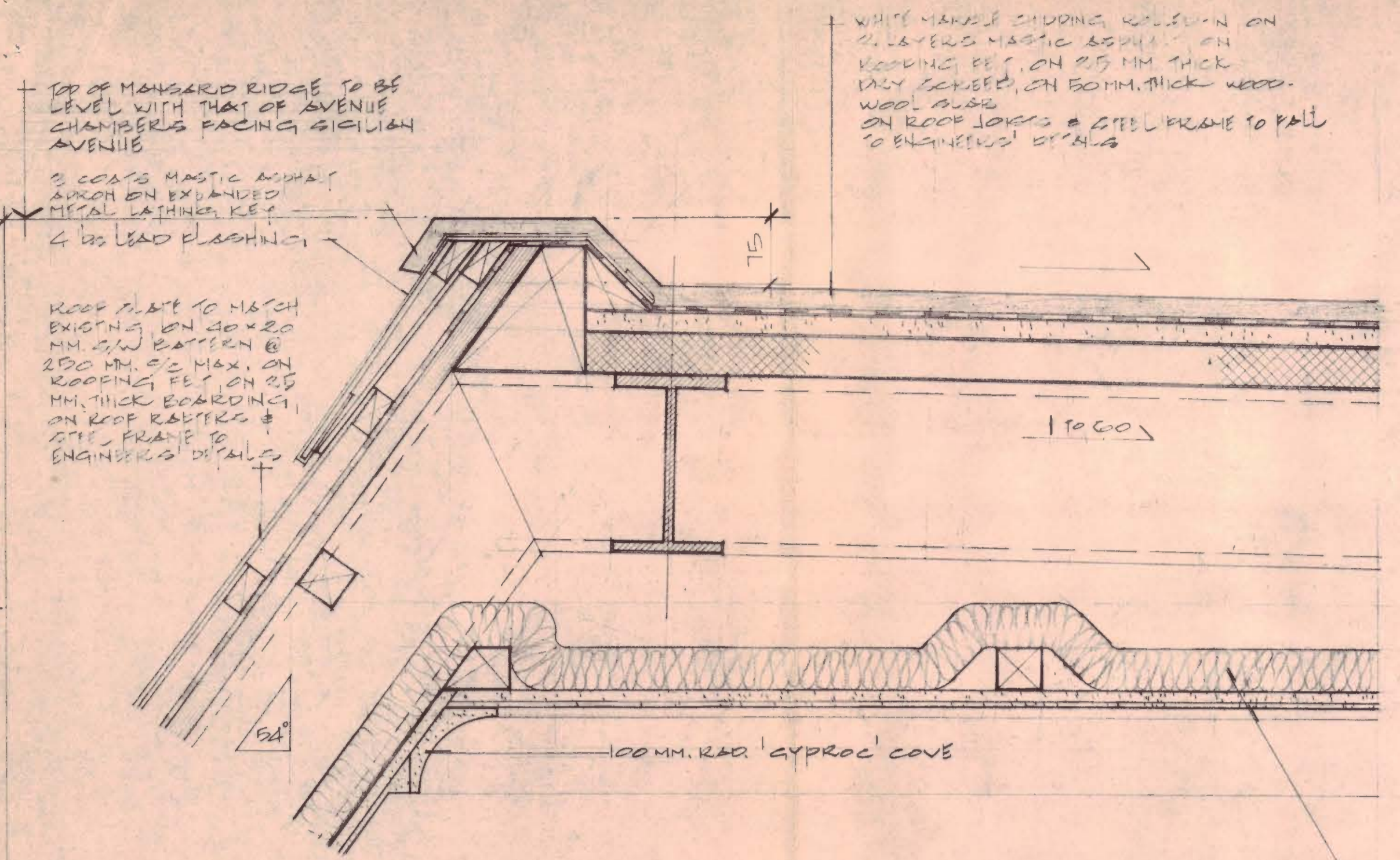

TYPICAL RIDGE DETAIL 'A'
SCALE: 1:5

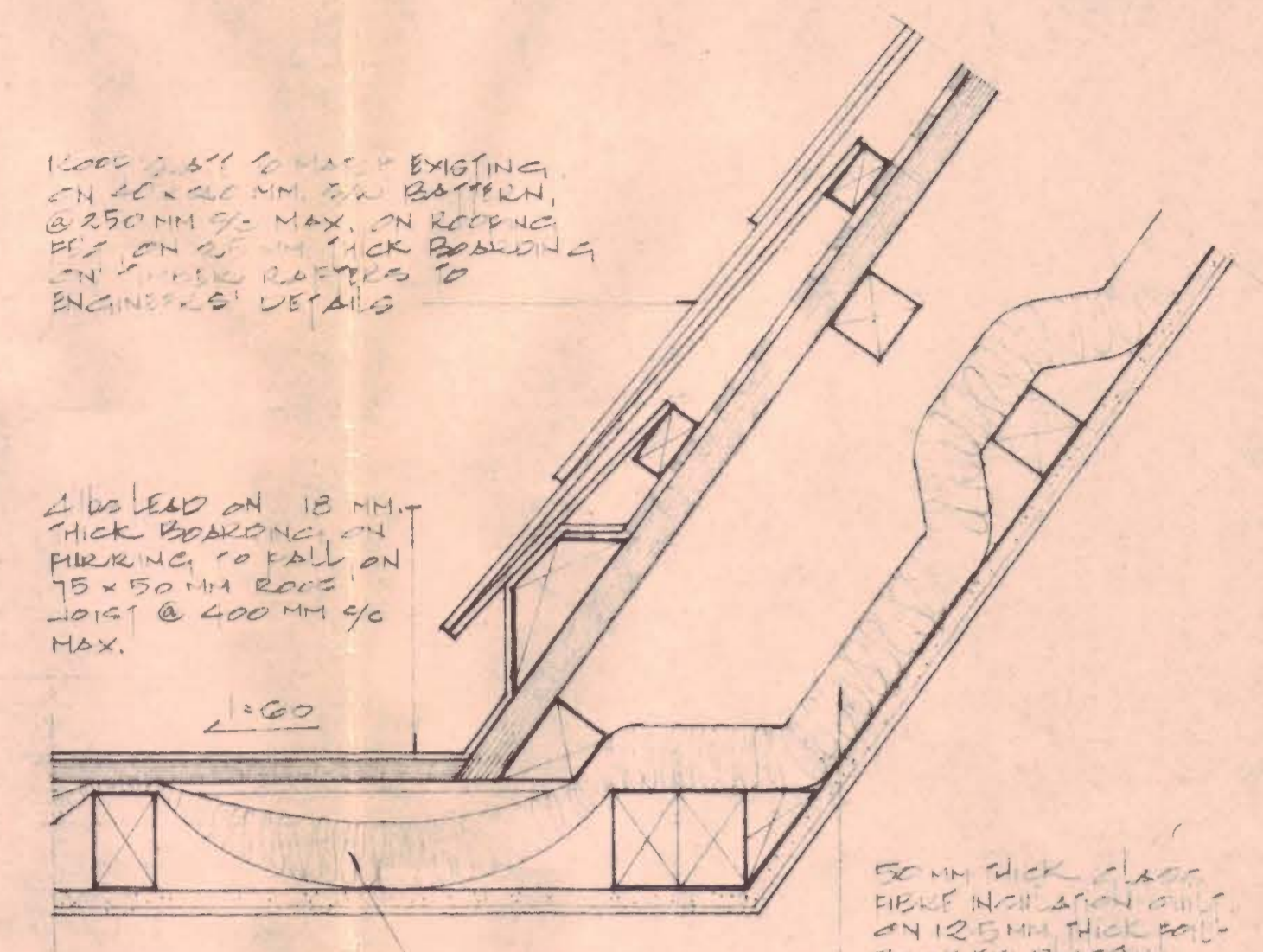

TYPICAL CORNER WINDOW DETAIL 'B'
SCALE: 1:5

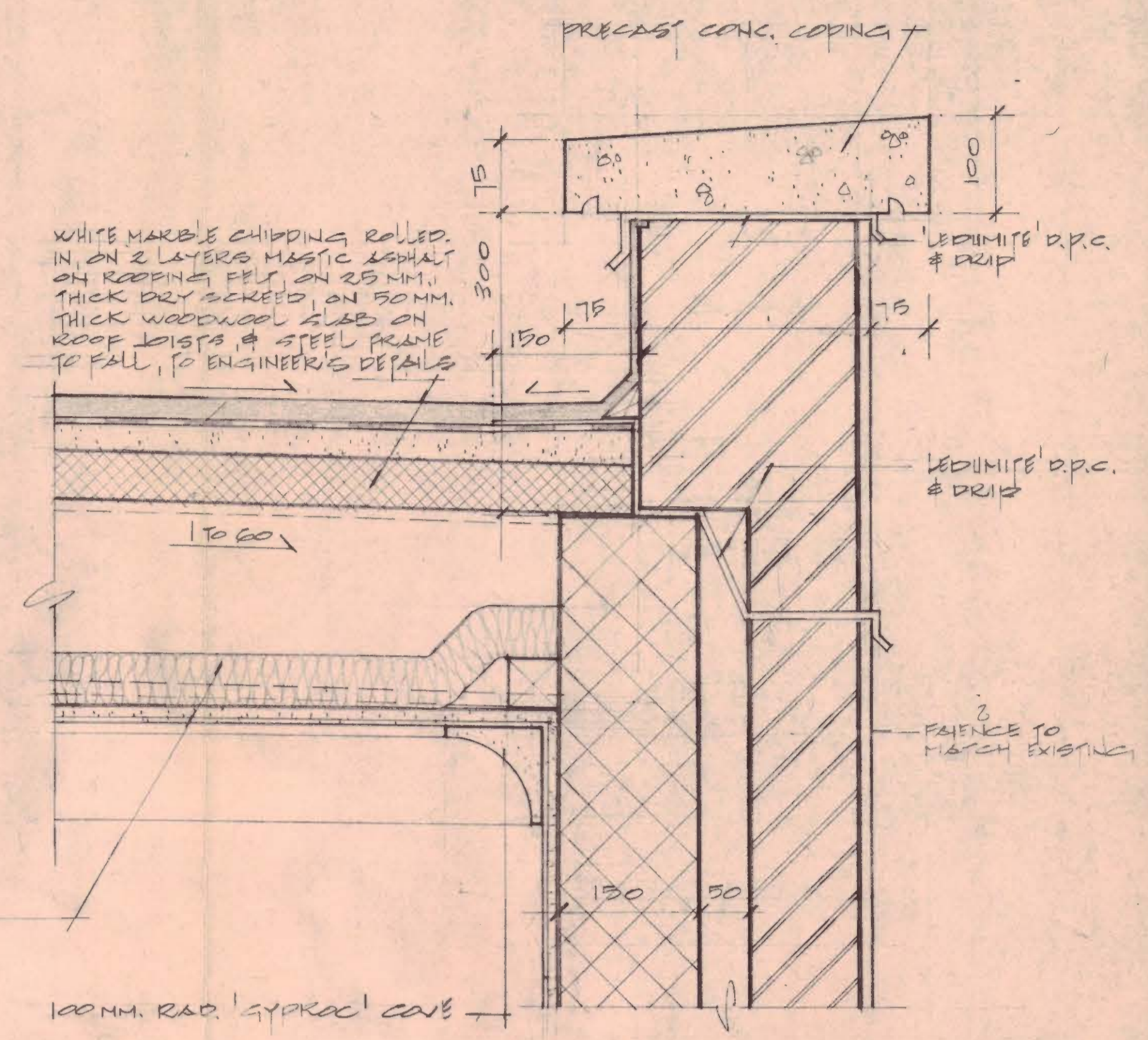

TYPICAL REAR PERSPECTIVE DETAIL 'D'
SCALE: 1:5

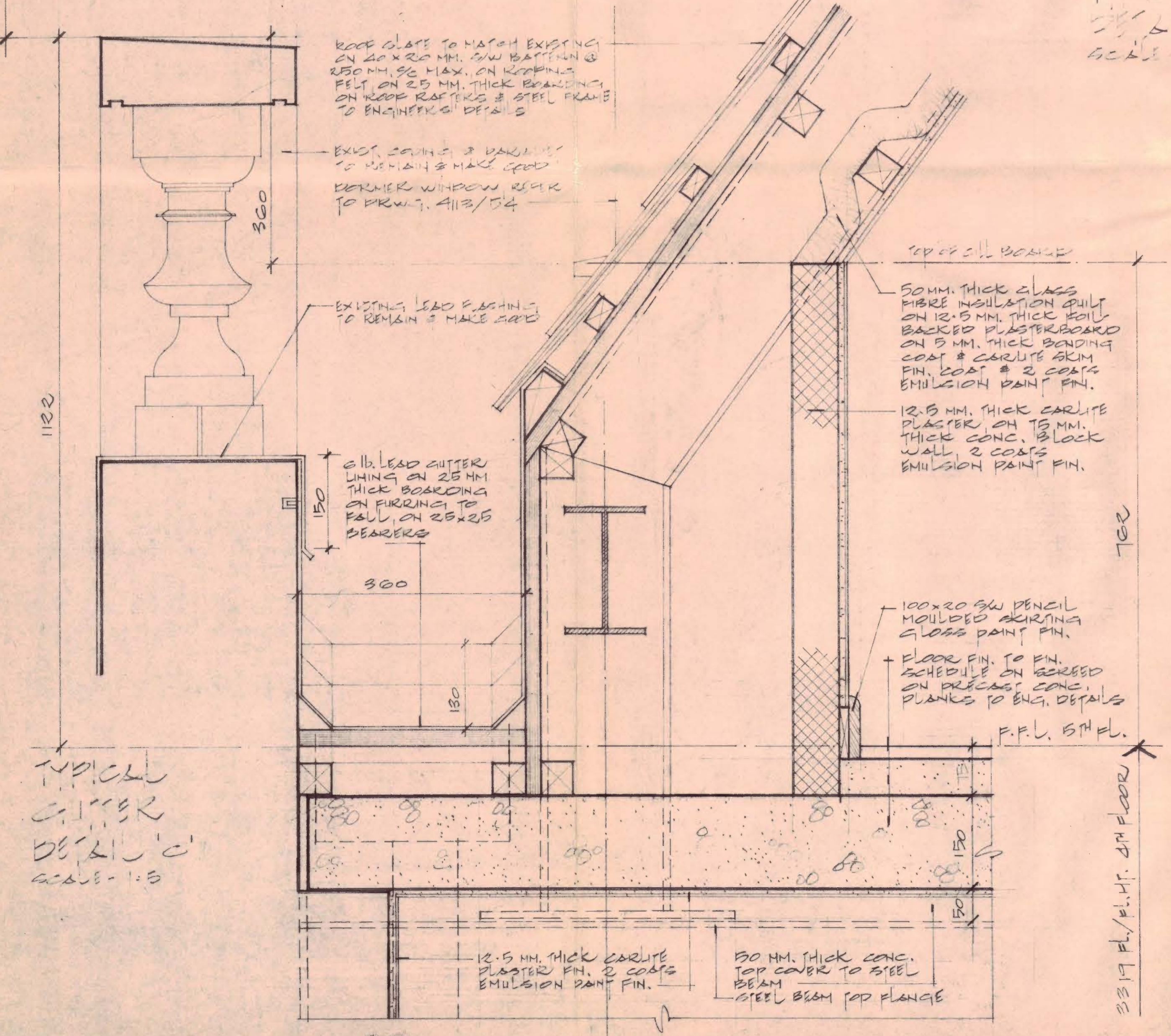

TYPICAL CORNER DETAIL 'C'
SCALE: 1:5

LONDON BOROUGH OF CAMDEN
TOWN AND COUNTRY PLANNING ACTS
- 9 NOV 1976
PLANS APPROVED
~~NOT APPROVED~~
ON BEHALF OF THE COUNCIL

CTP/N 14/24/57.23015
HB 1480

contract title SICILIAN & VERNON HOUSES SICILIAN AVENUE, LONDON, W.C.1.	drawing title ROOF DETAILS	scale as shown
T P Bennett & Son Chartered Architects 262 High Holborn WC1V 7DU Telephone: 01 405 9277	contract 4209	date 6-2-76
	drawing number 9	drawn K.C. FU
		revision