

Note: Do not scale from this drawing. Contractor to take and check all dimensions on site before work commences. Discrepancies to be reported to architect. Subcontractors to verify all dimensions on site before making shop drawings or commencing manufacture. This drawing is copyright.

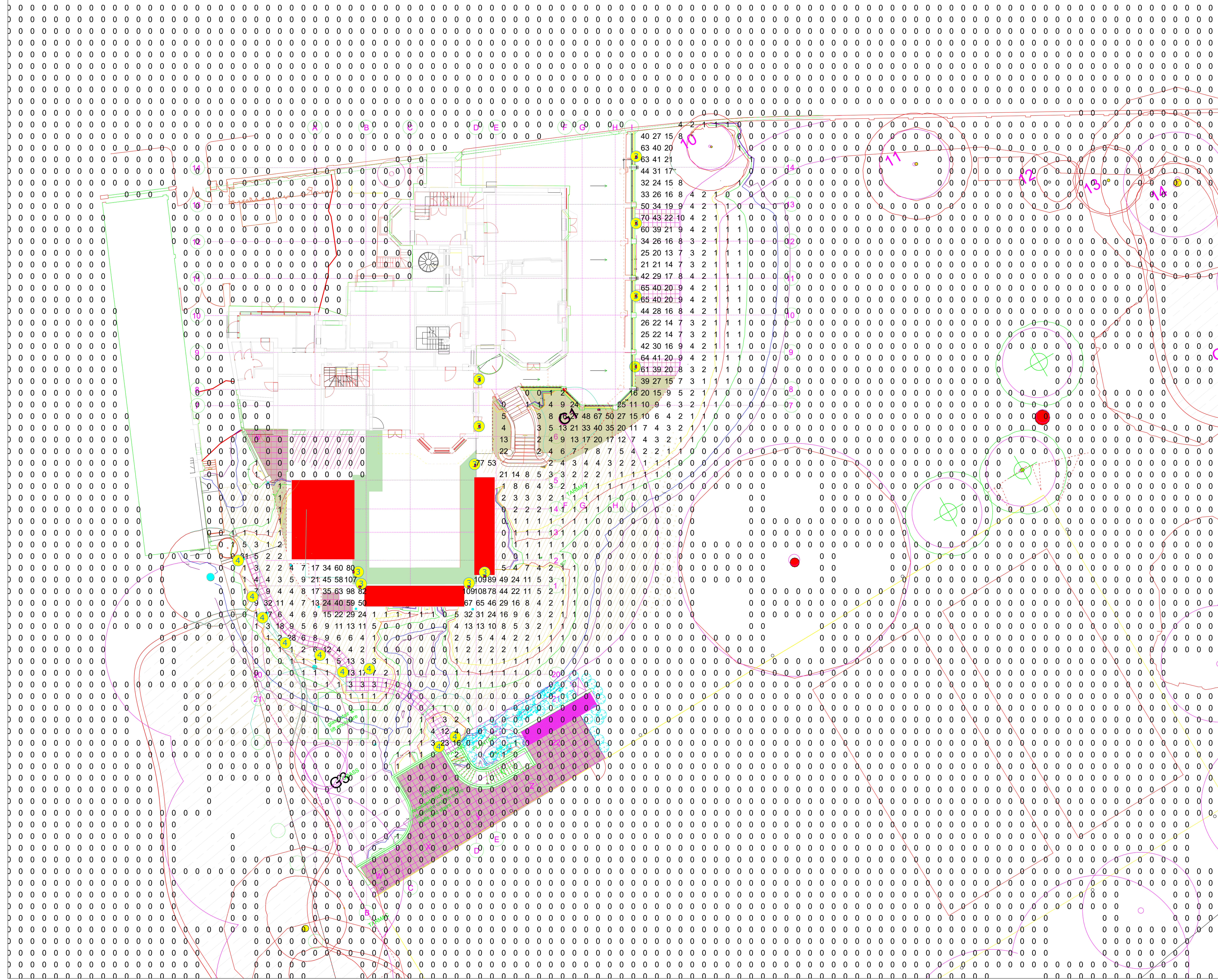

LIGHTING LEGEND	
	BOXTSER - 5410 - 057 - 3M AFFL
	IN-GROUND MARKER LIGHT

Rev	Description	Date	Initial



Second Floor T 020 7494 3522 The Priory, Draycott Rd T 01749 54 66 99
8th Ginter Street F 020 7494 3533 Shapton Mallor F 01749 54 66 77
London W1F 7JZ Somerset BA1 6HS
info@prime-meridian.co.uk www.primemeridian.co.uk

Client: CHANNING SCHOOL

Project: CHANNING SCHOOL

Title: EXTERNAL LIGHTING

Date: _____
Scale: 1:125 @A0
Drawn: SH
No. _____

