

GENERAL NOTES:

ALL DIMENSIONS TO BE CHECKED ON SITE AND ANY DISCREPANCIES TO BE REPORTED TO RSS.

ALL FINISHES, SAMPLES, AND MOCK-UPS TO BE APPROVED BY RSS PRIOR TO MANUFACTURE.

FOR SANITARYWARE AND LIGHTING REFER TO RSS SPECIFICATION INDEX FOR FURTHER INFORMATION.

FOR FINISHES REFER TO RSS FINISHES SCHEDULE.

REFER TO RSS SPEC INDEX FOR A LIST OF ALL ITEMS INCLUDED IN FF&E.

ALL EXISTING FURNITURE TO BE REMOVED FROM SITE UNLESS STATED OTHERWISE BY THE CLIENT

| REVISIONS: | | |
|------------|----------|-------------------|
| CODE: | DATE: | DESCRIPTION: |
| - | 14.04.20 | ISSUED FOR TENDER |
| A | 22.04.20 | ISSUED FOR TENDER |

NOTES:

TENDER SUBJECT TO CLIENT SIGN OFF

THIS DRAWING HAS NOT BEEN PRODUCED FROM A MEASURED SURVEY

CONTRACTOR TO CHECK ALL DIMS PRIOR TO COMMENCEMENT OF WORK

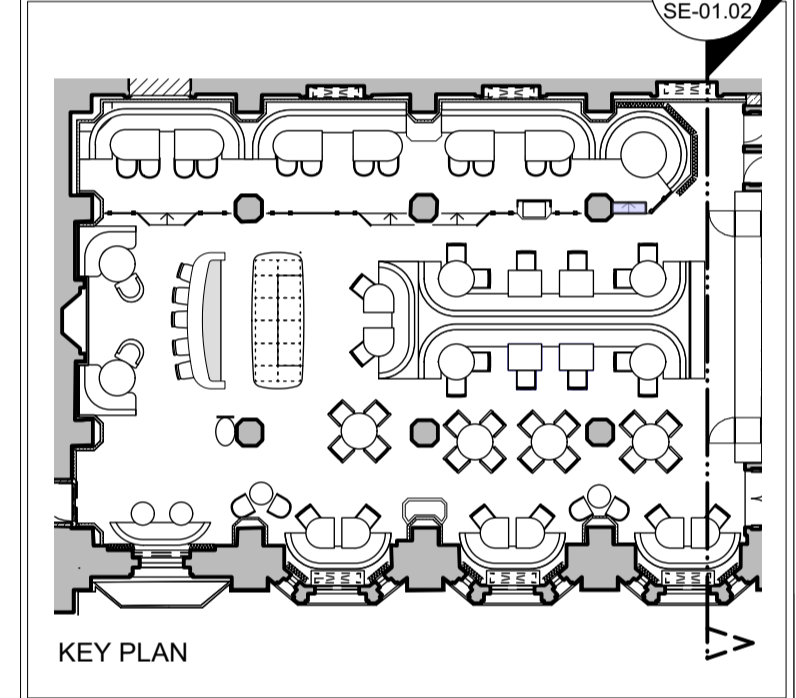

RussellSageStudio

St Michael's House | 2 Elizabeth Street | London | SW3W 9RB | T: +44 (0) 20 7730 3958
russellsagestudio.co.uk

THIS DRAWING IS THE PROPERTY OF RUSSELL SAGE STUDIO. COPYRIGHT IS RESERVED TO THEM AND THE DRAWING IS ISSUED ON THE CONDITION THAT IT IS NOT COPIED EITHER WHOLLY OR IN PART WITHOUT THE CONSENT IN WRITING OR RUSSELL SAGE STUDIO.

- ALL DIMENSIONS, DRAWINGS AND SPECIFICATIONS ARE TO BE VERIFIED ON SITE BY THE CONTRACTOR AND ANY DISCREPANCIES REPORTED TO RSS PRIOR TO THE COMMENCEMENT OF WORK.
- THIS PLAN HAS BEEN EXTRACTED FROM SUPPLIED DRAWINGS AND HENCE IS SUBJECT TO SURVEY AND CONTRACTOR SETTING OUT PLAN.
- CONTRACTOR TO TAKE RESPONSIBILITY AND ENSURE ALL CONSTRUCTION METHODS, TECHNIQUES, FITTINGS AND FINISHES ETC CONFORM TO THE REQUIRED BUILDING REGULATIONS IN THE APPLICABLE COUNTRY, AND TO THE RELEVANT BUILDING CONTROL OFFICERS SATISFACTION.
- ALL SPECIFIED ITEMS ARE TO BE INSTALLED IN ACCORDANCE WITH THE MANUFACTURERS RECOMMENDATIONS.
- ALL FINISHES ARE TO BE CARRIED OUT TO A HIGH STANDARD.

THIS DRAWING IS TO BE READ IN CONJUNCTION WITH ALL OTHER RELEVANT CONSULTANTS DRAWINGS. ALL REQUESTED DRAWINGS SHOWING FIXINGS AND CONSTRUCTION DETAILS TO BE APPROVED BY RSS PRIOR TO COMMENCEMENT OF WORK. CONTRACTORS TO CHECK AND APPRAISE DESIGN, FITTING OUT AND CONSTRUCTION DETAILS AND OFFER SUITABLE ALTERNATIVES TO THE DESIGNERS FOR APPROVAL PRIOR TO MANUFACTURE AND INSTALLATION. CONTRACTOR TO PROVIDE A SUITABLE WORKING ENVIRONMENT WHICH CONFORMS TO THE CURRENT HEALTH AND SAFETY CONDITIONS AND LOCAL AUTHORITY REGULATIONS.

| | | | |
|---|----------------------------------|---------------|------------------------|
| DRAWING STATUS: | | TENDER | |
| CLIENT: | | | |
| IHG | | | |
| PROJECT NO: | PROJECT: | | |
| 5196 | NEPTUNE RESTAURANT REFURBISHMENT | | |
| DATE: | DRAWN: | CHECKED: | SCALE: |
| 14th APR 20 | ET | TH | 1:25 @ A1 1:50 @ A3 |
| TITLE: | | | |
| GROUND FLOOR RESTAURANT SECTION (SERVERY) | | | |
| DWG. NO: | | | REV: |
| 5196-SE-01.02 | | | A |

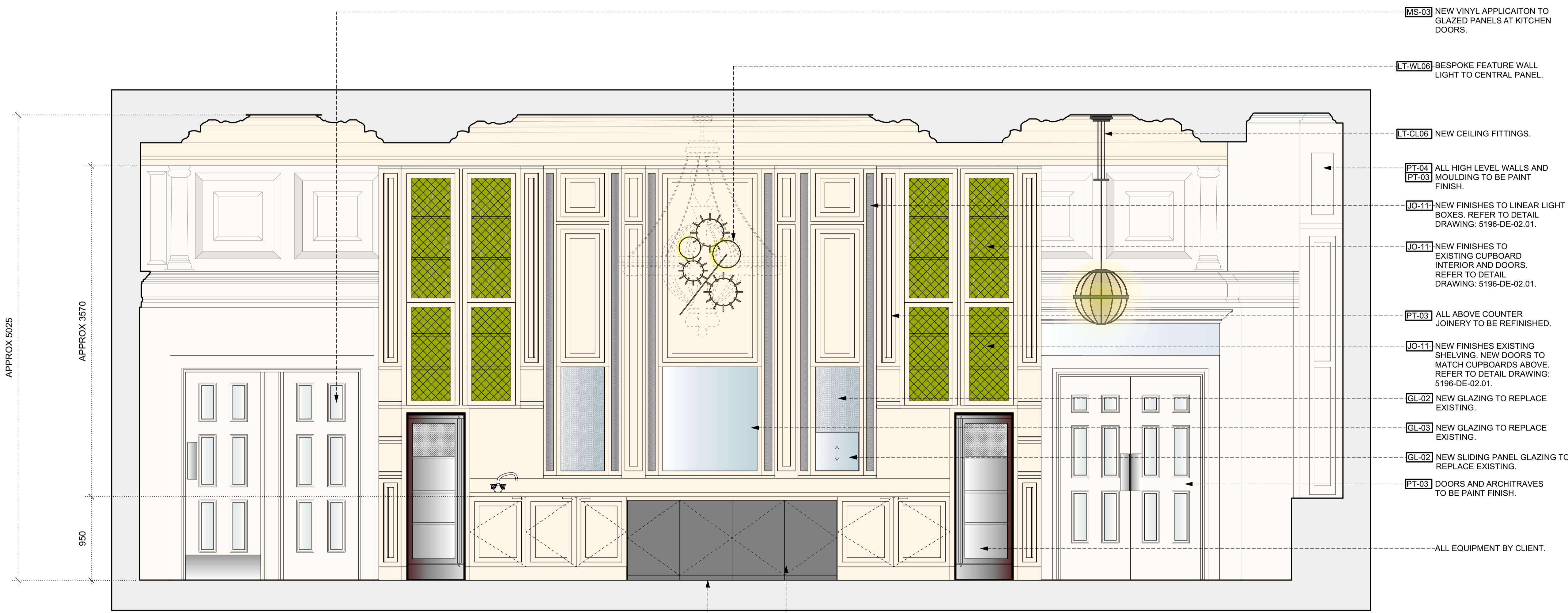

MS-03 NEW VINYL APPLICATION TO GLAZED PANELS AT KITCHEN DOORS.

LT-WL06 BESPOKE FEATURE WALL LIGHT TO CENTRAL PANEL.

LT-CL06 NEW CEILING FITTINGS.

PT-04 ALL HIGH LEVEL WALLS AND **PT-03** MOULDING TO BE PAINT FINISH.

JO-11 NEW FINISHES TO LINEAR LIGHT BOXES. REFER TO DETAIL DRAWING: 5196-DE-02.01.

JO-11 NEW FINISHES TO EXISTING CUPBOARD INTERIOR AND DOORS. REFER TO DETAIL DRAWING: 5196-DE-02.01.

PT-03 ALL ABOVE COUNTER JOINERY TO BE REFINISHED.

JO-11 NEW FINISHES EXISTING SHELVEING. NEW DOORS TO MATCH CUPBOARDS ABOVE. REFER TO DETAIL DRAWING: 5196-DE-02.01.

GL-02 NEW GLAZING TO REPLACE EXISTING.

GL-03 NEW GLAZING TO REPLACE EXISTING.

GL-02 NEW SLIDING PANEL GLAZING TO REPLACE EXISTING.

PT-03 DOORS AND ARCHITRAVES TO BE PAINT FINISH.

ALL EQUIPMENT BY CLIENT.

MS-01 NEW VINYL APPLICATION TO EXISTING FRIDGE DOORS.

JO-11 BELOW COUNTER JOINERY TO BE ADAPTED TO SUIT NEW OPERATIONS AND EQUIPMENT. REFER TO DETAIL DRAWING: 5196-DE-02.01.

APPROX 5025

APPROX 3570

950

01 GF RESTAURANT SECTION (SERVERY)
 SE-01.02 Scale 1:25 @ A1, 1:50 @ A3