







CEILING FINISHES KEY	
(REFER TO RSS FINISHES SCHEDULE FOR FURTHER DETAILS)	
	PT-04 - PAINT

LIGHTING LEGEND	
REFER TO RSS LIGHTING SCHEDULE & DATA SHEETS FOR SPECIFICATION & DETAILS	
HIGH LEVEL LIGHTING + ELECTRICAL	
	PENDANT FITTING
LOW LEVEL LIGHTING + ELECTRICAL	
	WALL LIGHT
	PICTURE LIGHT
	TABLE LAMP
	FLOOR LAMP

GENERAL NOTES:

ALL DIMENSIONS TO BE CHECKED ON SITE AND ANY DISCREPANCIES TO BE REPORTED TO RSS.

ALL FINISHES, SAMPLES, AND MOCK-UPS TO BE APPROVED BY RSS PRIOR TO MANUFACTURE.

FOR SANITARYWARE AND LIGHTING REFER TO RSS SPECIFICATION INDEX FOR FURTHER INFORMATION.

FOR FINISHES REFER TO RSS FINISHES SCHEDULE.

REFER TO RSS SPEC INDEX FOR A LIST OF ALL ITEMS INCLUDED IN FF&E.

ALL EXISTING FURNITURE TO BE REMOVED FROM SITE UNLESS STATED OTHERWISE BY THE CLIENT

REVISIONS:		
CODE	DATE	DESCRIPTION
-	14.04.20	ISSUED FOR TENDER
A	22.04.20	ISSUED FOR TENDER
B	29.04.20	LBC APPLICATION

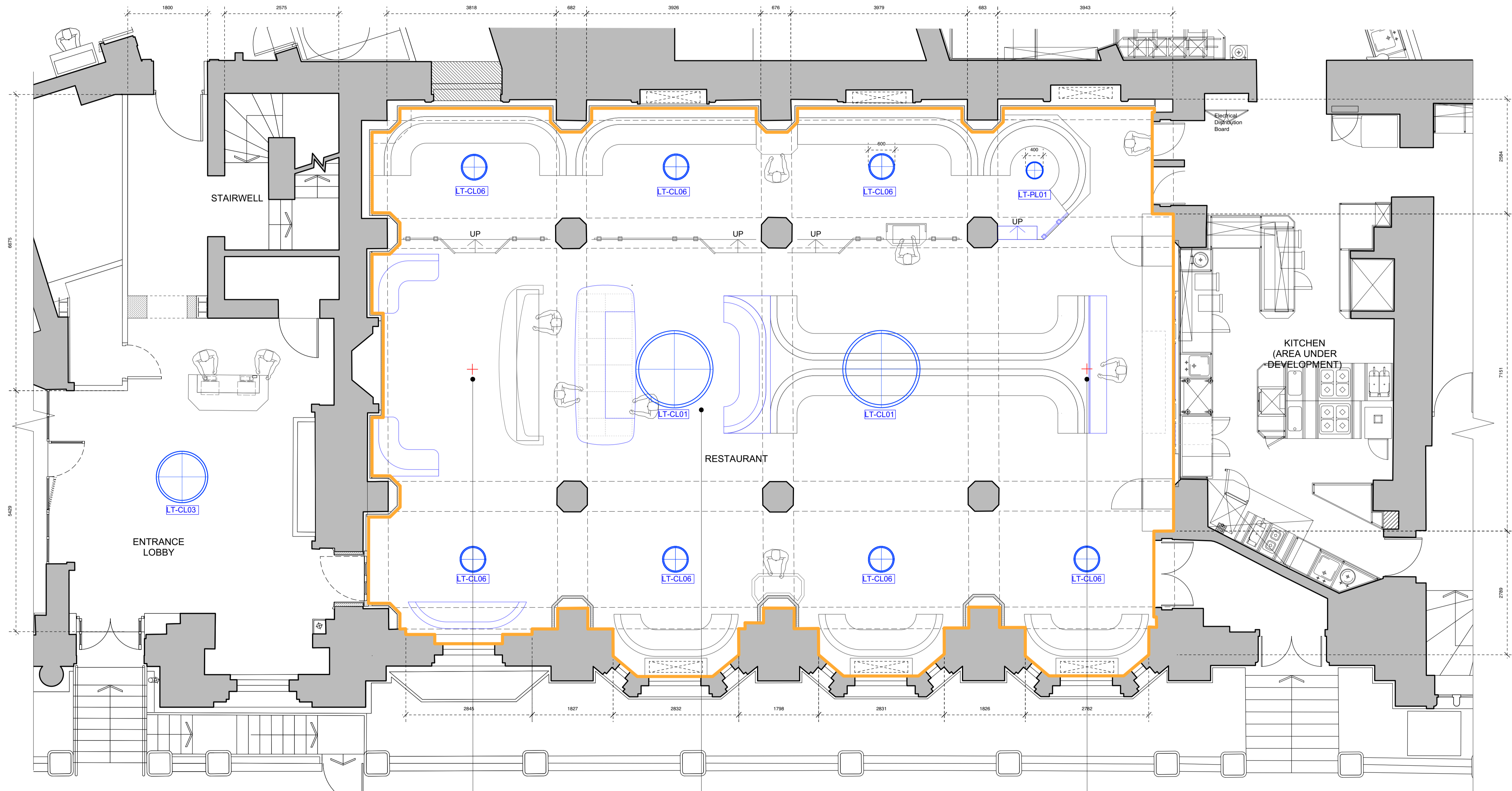

NOTES:

TENDER SUBJECT TO CLIENT SIGN OFF

THIS DRAWING HAS NOT BEEN PRODUCED FROM A MEASURED SURVEY

CONTRACTOR TO CHECK ALL DIMS PRIOR TO COMMENCEMENT OF WORK

Russell Sage Studio

St Michael's House | 2 Elizabeth Street | London | SW1W 9RB | T: +44 (0) 20 7730 3258
russellsagestudio.co.uk

THIS DRAWING IS THE PROPERTY OF RUSSELL SAGE STUDIO. COPYRIGHT IS RESERVED TO THEM AND THE DRAWING IS ISSUED ON THE CONDITION THAT IT IS NOT COPIED EITHER WHOLLY OR IN PART WITHOUT THE CONSENT IN WRITING OR RUSSELL SAGE STUDIO.

- ALL DIMENSIONS, DRAWINGS AND SPECIFICATIONS ARE TO BE VERIFIED ON SITE BY THE CONTRACTOR AND ANY DISCREPANCIES REPORTED TO RSS PRIOR TO THE COMMENCEMENT OF WORK.
- THIS PLAN HAS BEEN EXTRACTED FROM SUPPLIED DRAWINGS AND HENCE IS SUBJECT TO SURVEY AND CONTRACTOR SETTING OUT PLAN.
- CONTRACTOR TO TAKE RESPONSIBILITY AND ENSURE ALL CONSTRUCTION METHODS, TECHNIQUES, FITTINGS AND FINISHES ETC CONFORM TO THE REQUIRED BUILDING REGULATIONS IN THE APPLICABLE COUNTRY, AND TO THE RELEVANT BUILDING CONTROL OFFICERS SATISFACTION.
- ALL SPECIFIED ITEMS ARE TO BE INSTALLED IN ACCORDANCE WITH THE MANUFACTURERS RECOMMENDATIONS.
- ALL FINISHES ARE TO BE CARRIED OUT TO A HIGH STANDARD.

THIS DRAWING IS TO BE READ IN CONJUNCTION WITH ALL OTHER RELEVANT CONSULTANTS DRAWINGS. ALL REQUESTED DRAWINGS SHOWING FIXINGS AND CONSTRUCTION DETAILS TO BE APPROVED BY RSS PRIOR TO COMMENCEMENT OF WORK. CONTRACTORS TO CHECK AND APPRAISE DESIGN, FITTING OUT AND CONSTRUCTION DETAILS AND OFFER SUITABLE ALTERNATIVES TO THE DESIGNERS FOR APPROVAL PRIOR TO MANUFACTURE AND INSTALLATION. CONTRACTOR TO PROVIDE A SUITABLE WORKING ENVIRONMENT WHICH CONFORMS TO THE CURRENT HEALTH AND SAFETY CONDITIONS AND LOCAL AUTHORITY REGULATIONS.

DRAWING STATUS:		TENDER	
CLIENT:			
IHG			
PROJECT NO:	PROJECT:	NEPTUNE RESTAURANT REFURBISHMENT	
5196			
DATE:	DRAWN:	CHECKED:	SCALE:
14th APR 20	ZL	TH	1:50 @ A1 1:100 @ A3
TITLE:			
GROUND FLOOR RCP			
DWG. NO:			REV:
5196-PL-06			B

01 GROUND FLOOR RCP PLAN
PL-06 Scale 1:50 @A1

EXISTING CEILING LIGHT TO BE REMOVED. CEILING TO BE MADE GOOD READY TO BE REPAINTED

ALL NEW LIGHTS TO BE HUNG FROM EXISTING FIXINGS. WEIGHT ALLOWANCE CONFIRMED AS MAX 150KG, WITH NO INTRUSIVE INVESTIGATIONS REQUIRED. CONTRACTOR TO ADVISE ANY FURTHER REMEDIAL WORKS ON SITE.

EXISTING CEILING LIGHT TO BE REMOVED. CEILING TO BE MADE GOOD READY TO BE REPAINTED