

BASEMENT FLOOR

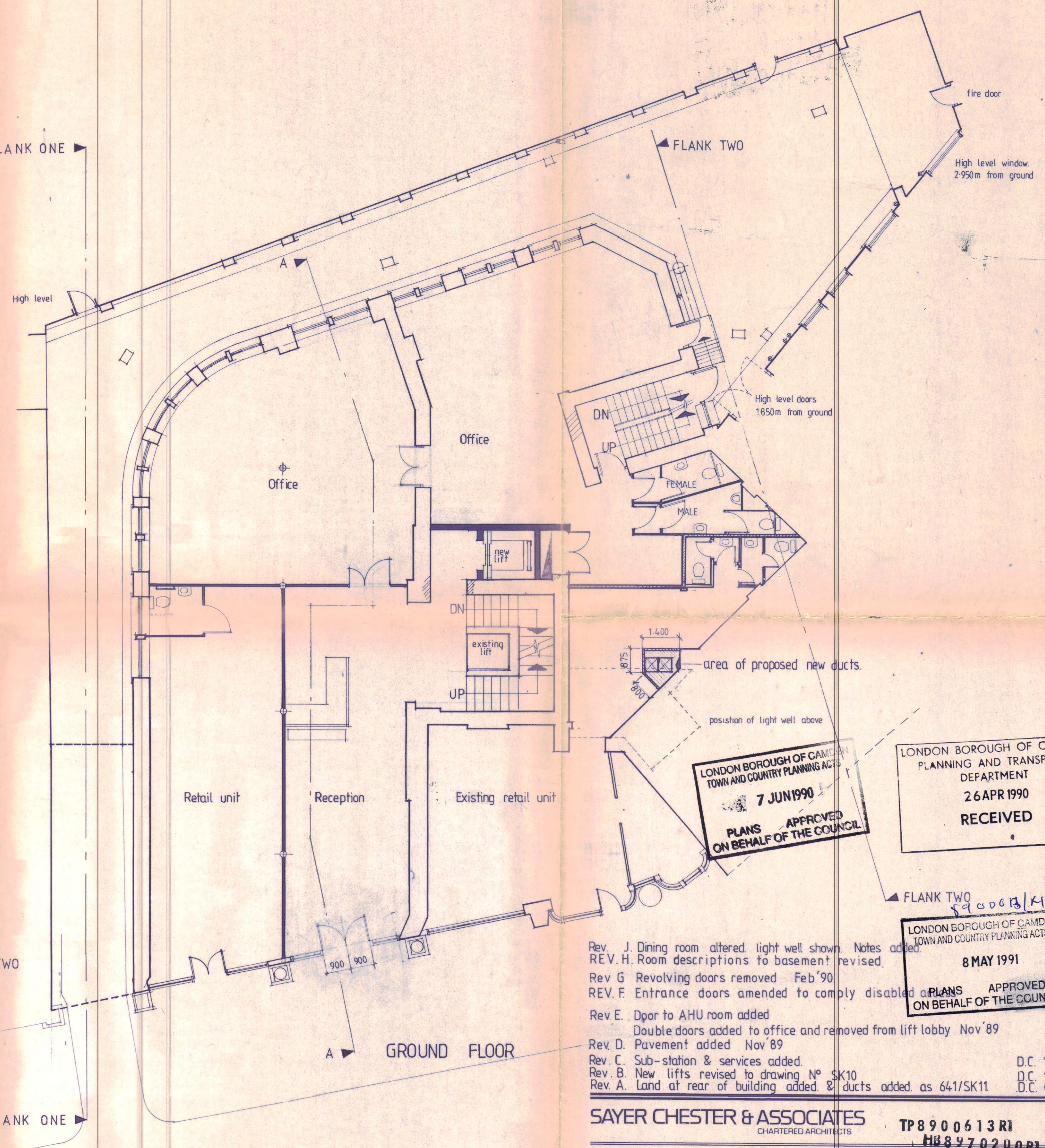

GROUND FLOOR

LONDON BOROUGH OF CAMDEN
TOWN AND COUNTRY PLANNING ACTS
7 JUN 1990
PLANS APPROVED
ON BEHALF OF THE COUNCIL

LONDON BOROUGH OF CAMDEN
PLANNING AND TRANSPORT
DEPARTMENT
26 APR 1990
RECEIVED

Rev. J. Dining room altered light well shown. Notes added.
REV. H. Room descriptions to basement revised.
Rev. G. Revolving doors removed Feb '90
REV. F. Entrance doors amended to comply disabled access.
Rev. E. Door to AHU room added.
Double doors added to office and removed from lift lobby Nov '89
Rev. D. Pavement added Nov '89
Rev. C. Sub-station & services added. D.C. 15/11/89
Rev. B. New lifts revised to drawing N° SK10 D.C. 13/11/89
Rev. A. Land at rear of building added & ducts added as 641/SK11 D.C. 08/11/89

SAYER CHESTER & ASSOCIATES
CHARTERED ARCHITECTS
TP8900613R1
HB8970200R1

PROJECT
Refurbishment of 17-23
SOUTHAMPTON ROW
LONDON WC1

DRAWING Proposed Basement & Ground floor plans		
SCALE 1:100	DATE OCT '89	
JOB NO 641	DRAWING NO 21	REV J

FIGURED DIMENSIONS TO BE USED IN PREFERENCE TO SCALING. ALL DIMENSIONS TO BE CHECKED ON SITE AND CONTRACTOR IS TO BE RESPONSIBLE FOR THE ACCURACY THEREOF.