

General notes:

1. Shading indicates new construction.
2. All existing bathroom, kitchen and sanitaryware fittings to be removed.
3. Original joinery to be recorded and set aside for resale where removal necessary.
4. No original door survived throughout the house. New door details to follow those of WA drawings.
5. Fireplaces and hearth surrounds to be retained unless noted otherwise. Existing chimney flues to be unblocked and lined.
6. Existing services and drains removed and replaced throughout.
7. Overhaul and repair all windows/shutters and mouldings, including paneled aprons (except where stated as new items).
8. All rooms to be fitted with smoke/heat detectors and sounders at ceiling level with air sampling detection system in fire rooms
9. Repair floor joists as necessary. Consult with Architect and Structural Engineer. Strengthen existing joists where new stone floor finish to be installed.
10. Provide new appropriately detailed and sized cornices of traditional design throughout to replace existing modern cornices.

Notes on Fourth Floor:

- Internal doors: S/F new traditionally detailed painted SW door and architraves throughout except where indicated otherwise.

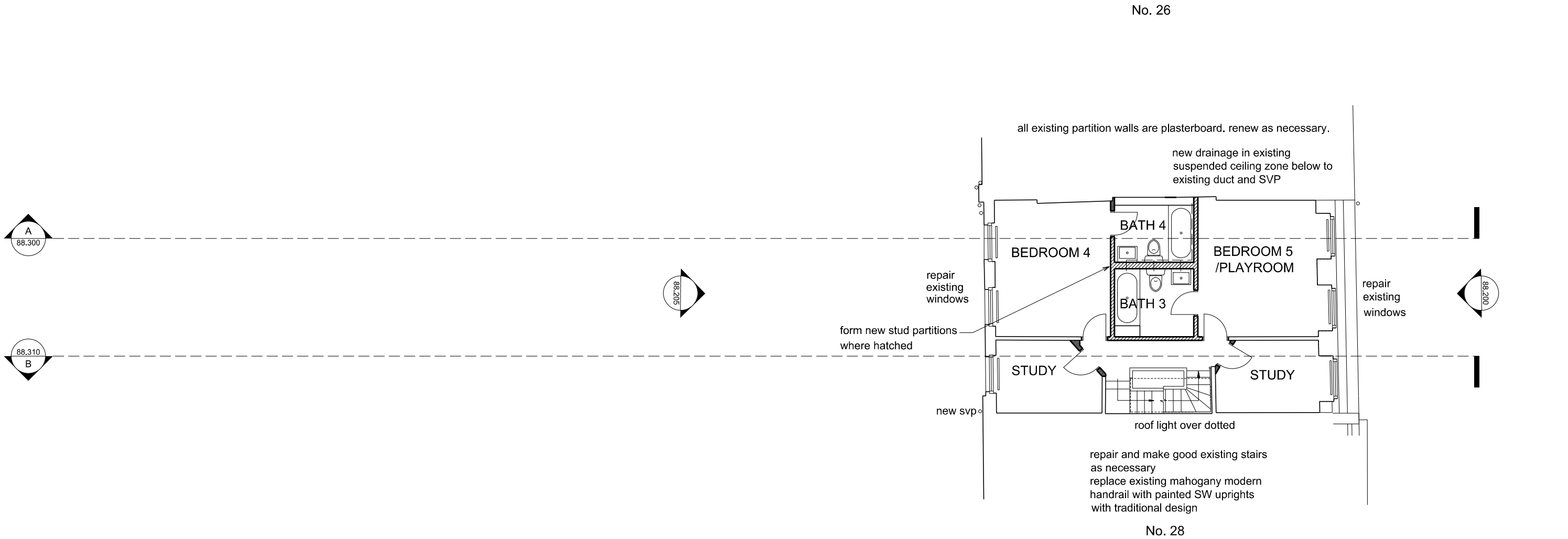

**WEST**  
**ARCHITECTURE**

West Architecture  
Unit 319  
Screenworks  
22 Highbury Grove  
London, N5 2EF  
Telephone +44 (0)203 859 0211  
Email info@westarchitecture.co.uk  
www.westarchitecture.co.uk

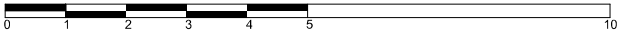

PROPOSED FOURTH FLOOR PLAN

Project JOHN STREET	Job No 088	Drg No 88.104	Rev P1
Title PROPOSED FOURTH FLOOR PLAN	Scale 1:125	Date 22.05.20	Sheet A3
Client JB	Drawn hm	Check gw	

Illustrated material subject to copyright  
All dimensions to be checked on site and errors to be reported to architect