

NOTES

DO NOT SCALE FROM THIS DRAWING

PLANNING

NOTE:

This drawing is submitted as part of a planning, listed building or conservation area consent application and is not intended for any other purpose.

All plans, sections & elevations are based on measured readings and any scaled dimension should not be relied upon to give an accurate measurement.

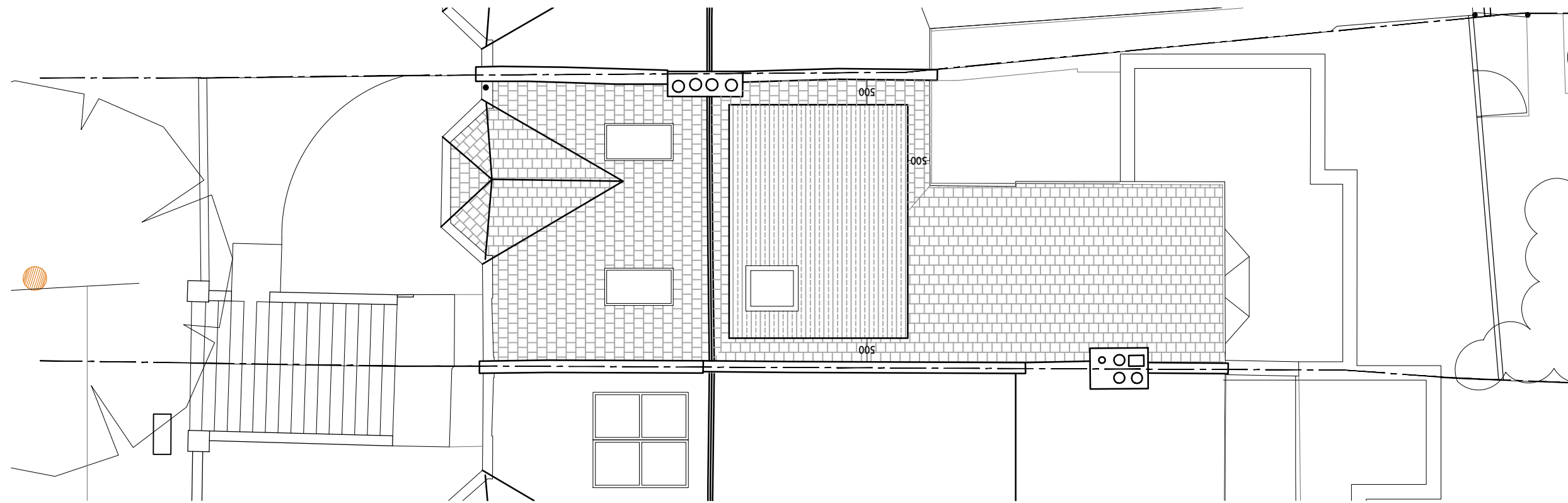

Proposed Roof Plan - 1:100@A3

| | | |
|-------------------|-------------------------------|----------|
| Revision A | Adaptations to rear dormer | 18.09.19 |
| Revision B | Adaptations to dormer | 04.10.19 |
| Revision C | Removal of dormer | 16.12.19 |
| Revision D | Adaptations to front entrance | 07.01.20 |
| Revision E | Adaptations to front entrance | 17.02.20 |
| Revision F | Adaptations to lightwell | 20/03/20 |
| Revision G | Adaptations to lightwell | 07/05/20 |
| Revision H | Dims included | 15/05/20 |
| Revision I | Removal of rear terrace | 20.05.20 |

Martin Evans
Architects

18 Charlotte Road
London EC2A 3PB
tel 020 7729 2474

JOB
Hillfield Road
London
NW6

TITLE
Proposed
Roof Plan

| | |
|--------------|------------|
| DATE | 21.05.2019 |
| SCALE | 1:100 @ A3 |
| DRAWN | G.R. |

DRAWING NO. HFR-PL-PRO_06I

