

NOTES:

- Drawing is based on record drawings provided by UCL.
- Layout is for discussion purposes only.
- Layouts are subject to development and review against relevant guidelines and regulations.

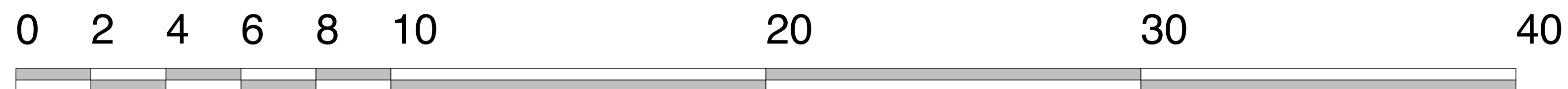
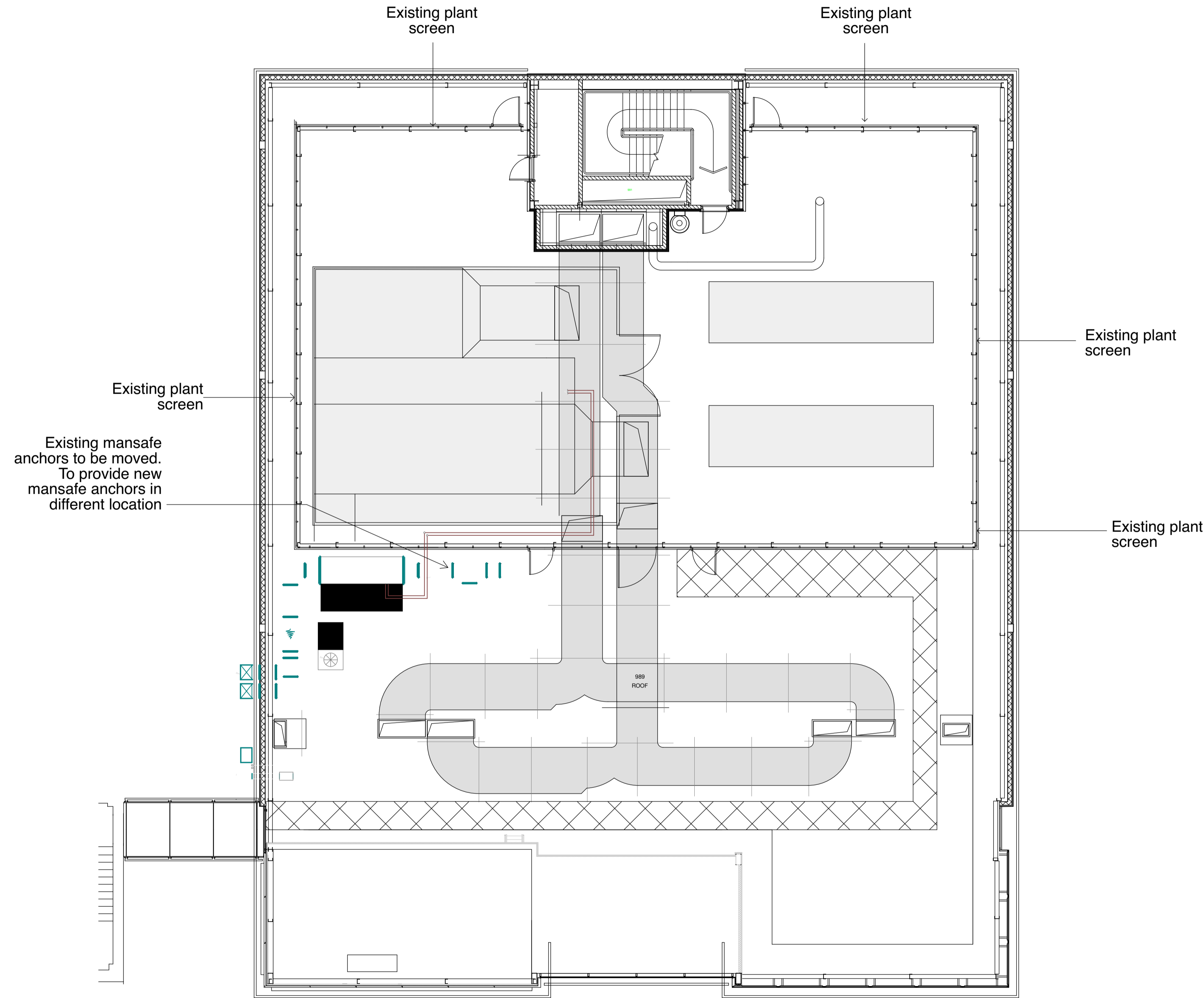
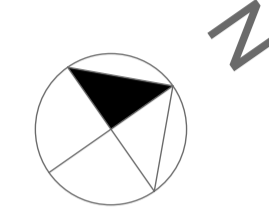

bmj
architects

Glasgow / London
Boswell Mitchell & Johnston +44 141 271 3200
The Hub, 70 Pacific Quay glasgow@bmjarchitects.co.uk
Glasgow, G51 1DZ www.bmjarchitects.co.uk

Client
University College London **UCL**

Project
Malet Place
Engineering Building (MPEB)
Sixth Floor - EEE Laboratory

Document Title
Planning Application
Existing Roof Plan

Scale(s) @ 1:100 BMJ Project Ref: [3782]

Drawn by SS Approved by NB Date 12/05/2020

Job No. Drawings No. Revision
3782 PL03 P1