

- Existing 1990's conservatory to be removed.
- Roof fabric to original Council Chamber plant enclosure to be demolished. Surrounding parapet retained.
- Raised access floor to the existing conservatory removed to expose original slab level.
- Existing lift motor room to be removed.
- Section of pitched roof to 1940's extension to be removed.
- Existing gallery raked seating removed. Existing structure retained

Notes:

Drawings are based on survey data and may not accurately represent what is physically present.

All dimensions are to be verified on site before proceeding with the work.

All dimensions are in millimeters unless noted otherwise.

Purcell shall be notified in writing of any discrepancies.

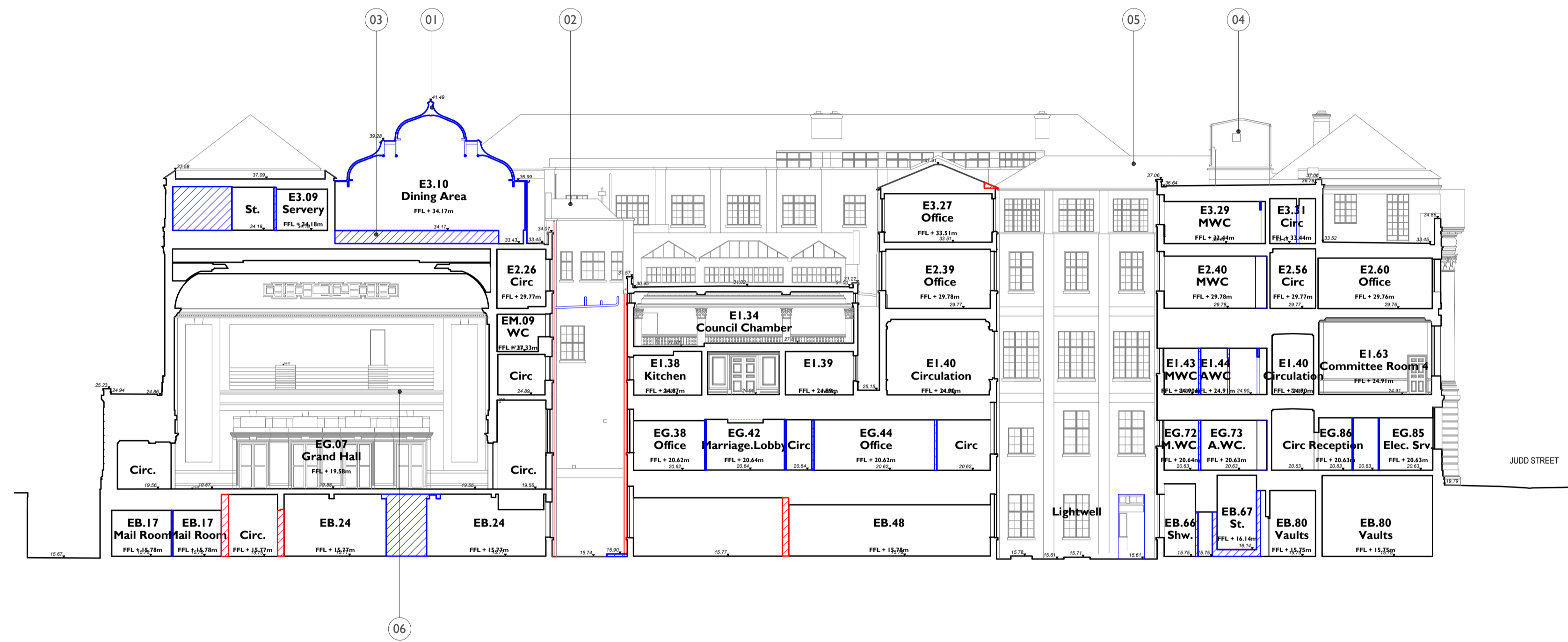
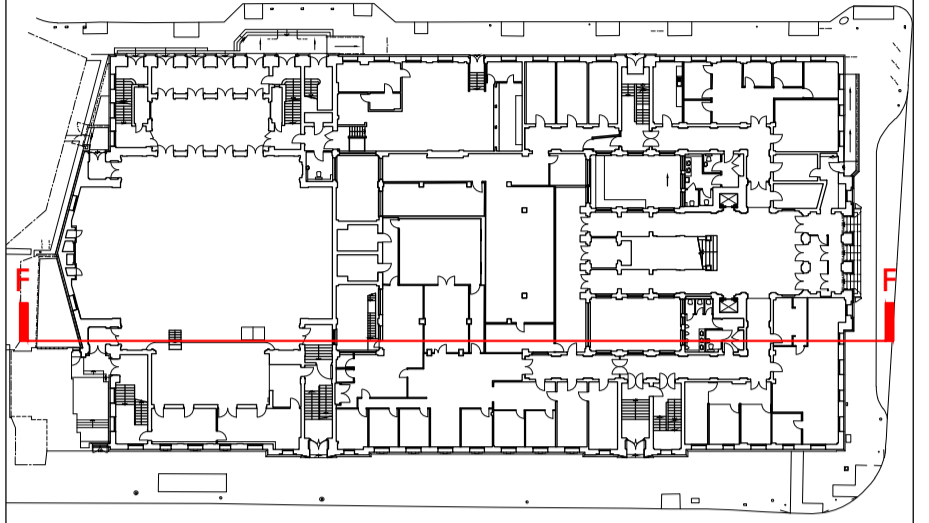

Demolitions & Alterations Key

Original fabric defined as that documented in Archive Drawings. Where date of fabric is unknown, it is assumed as original.

- Original Fabric: Section of Wall/Slab to be Demolished
- Original Fabric: Item to be Demolished
- Overhead - 300mm wide opening to ceiling for high level concealed cable distribution - make good after installation
- Overhead: Whole bay of vaulted ceiling to be removed for cabling distribution and reinstated
- Original Fabric: High level opening in wall for services distribution
- Floor trenches in slab for cable distribution
- Manhole: Opening in slab
- Non-Original Fabric: Section of Wall to be Demolished
- Non-Original Fabric: Item to be Demolished
- Window Number
- Door Number
- Annotation Item

Drawings to be read in conjunction with:

- Internal Repairs & Builder's Works drawing series (93)000 for key spaces
- Conservation Strategy Report CTH-PUR-MP-00-SP-A-00005

1:200 Scale



SS P00 18 Apr 2019 OB NS

ISSUE	DATE	DRAWN	CHECKED	DESCRIPTION
DRAWING TITLE		GA PROPOSED DEMOLITIONS AND STRIP OUT SECTION F-F		
DRAWING NO.		CTH-PUR-MP-ZZ-DR-A-91205		
REVISION		SS P00		
SIZE & SCALE		A1L	1:200	
DRAWING STATUS		SS SUITABLE FOR PLANNING		

CLIENT	Lendlease	
PROJECT	Camden Town Hall	
JOB NUMBER	238664	

I SECTION F-F PROPOSED DEMOLITIONS AND STRIP OUT
91205 1:200 @ A1