

1. New fire doors inserted to create a refuge lobby to staircase and fire compartment to lift lobby. New doors to match existing
2. Two new passenger lifts servicing all floors inserted into South East Lightwell. Secondary glazing introduced to existing windows to achieve 60min fire rating
3. Façade of 2nd floor pavilion above to enclose South East Lightwell at Second Floor level.
4. Existing lantern structures and rooflights over Council Chamber to be retained.
5. New WCs inserted
6. Open office space created to CAT A finish. New services sensitively integrated into historic fabric
7. Existing wall retained, keeping original plan form of corridor. Doors removed into Open office space.
8. Existing archways retained.
9. New WCs inserted within existing location.
10. Council Chamber roof to be thermally upgraded externally.
11. Existing passenger lifts to be closed up and not accessed at Level 2.
12. Acoustic dry lining to walls separating open office space and Camden centre.
13. Service gantry and staircase to be inserted in lightwell for access to plant at each level.
14. Parquet floors in location of existing corridors to be retained.
15. Overhead downstand retained to delineate existing wall position.
16. New sliding screens that closely match the existing, to replace the existing single glazed windows - to facilitate safe access & maintenance to Council Chamber rooflight.

Notes:

Drawings are based on survey data and may not accurately represent what is physically present.

All dimensions are to be verified on site before proceeding with the work.

All dimensions are in millimeters unless noted otherwise.

Purcell shall be notified in writing of any discrepancies.

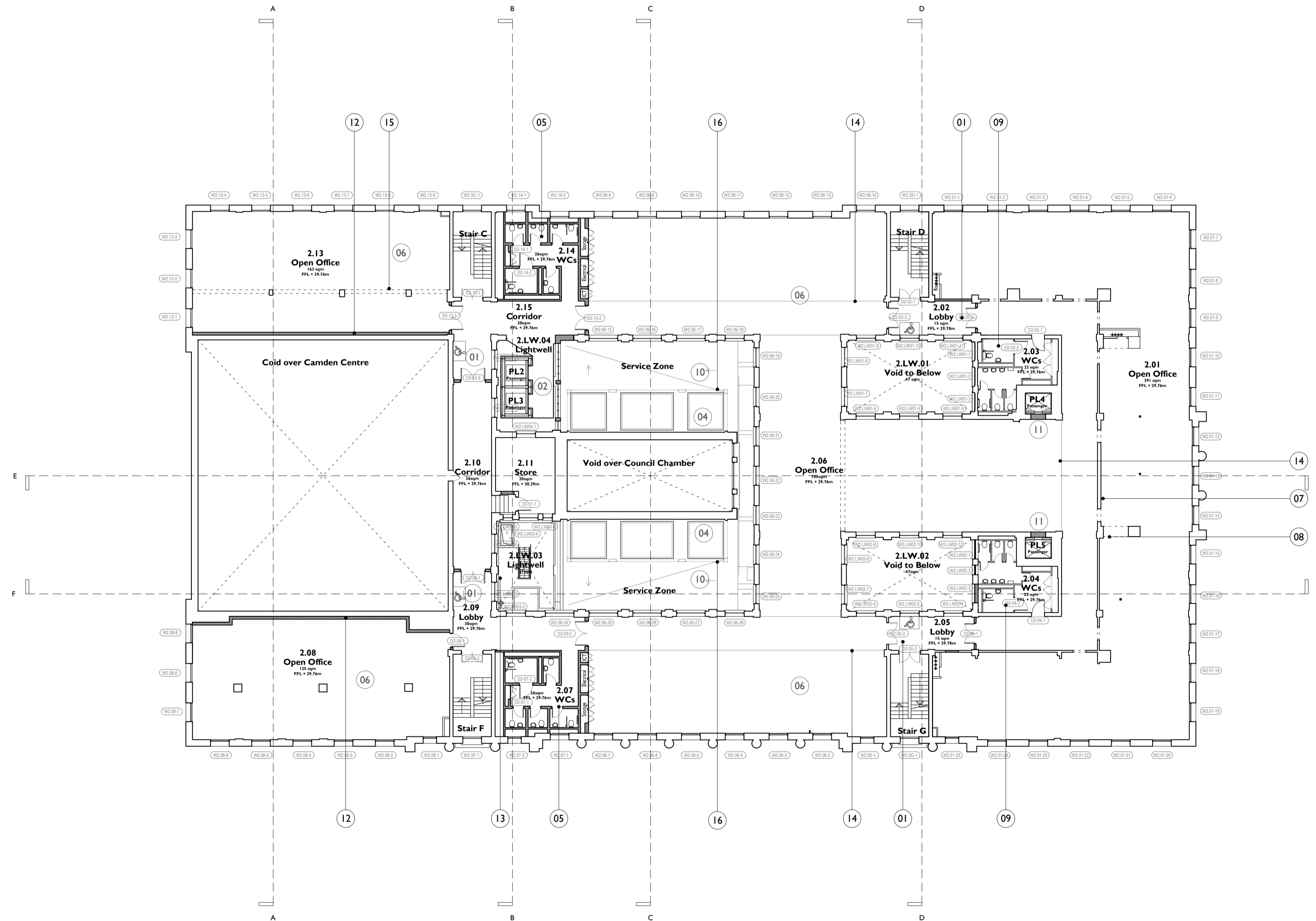

Proposed Works Key

- Proposed Wall
- Window Number
- Door Number
- Refuge Point
- Annotation Item
- Manhole Location

Drawings to be read in conjunction with:

Use Designation Plans: Drawing Series (92)900
 Conservation Strategy Report CTH-PUR-MP-00-SP-A-00005
 Window Strategy Report CTH-PUR-XX-XX-RP-A-00012

1:200 Scale



SS P00 18 Apr 2019 OB NS

ISSUE	DATE	DRAWN	CHECKED	DESCRIPTION
DRAWING TITLE	GA PLAN PROPOSED SECOND FLOOR LEVEL PLAN			
DRAWING NO.	CTH-PUR-MP-02-DR-A-92004			
REVISION	SS P00			
SIZE & SCALE	A1L 1:200 @A1			
DRAWING STATUS	SS SUITABLE FOR PLANNING			

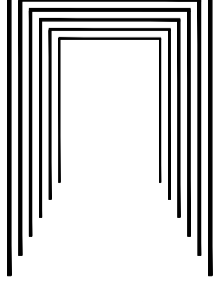
CLIENT	Lendlease	
PROJECT	Camden Town Hall	
JOB NUMBER	238664	