

- Existing 1990's conservatory to be removed.
- Roof fabric to original Council Chamber plant enclosure to be demolished. Surrounding parapet retained.
- Raised access floor to the existing conservatory removed to expose original slab level.
- Existing lift motor room retained and reused as pump room - cladding replaced.
- Section of pitched roof to 1940's extension to be removed.
- Existing gallery raked seating removed. Existing structure retained.
- Existing fabric removed for the insertion of Camden centre passenger lifts and dumbwaiters. New slab structural opening for lift pits.
- Floor lowered for new stepped entrance from Tonbridge Walk.

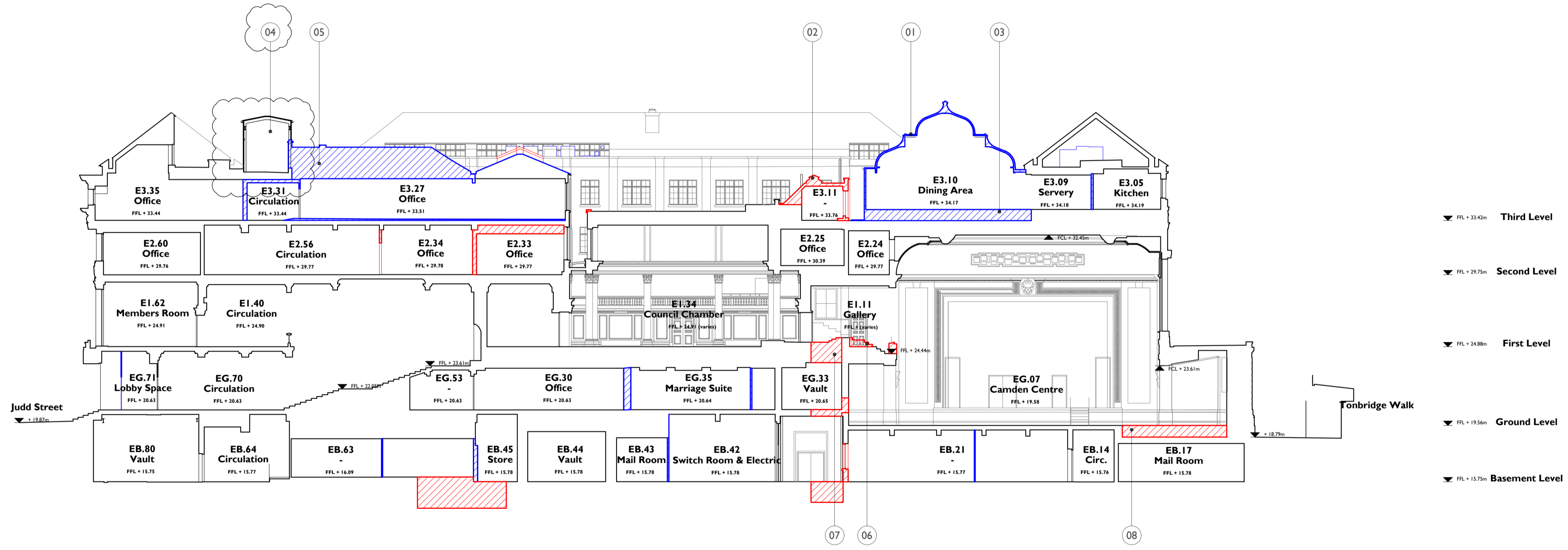
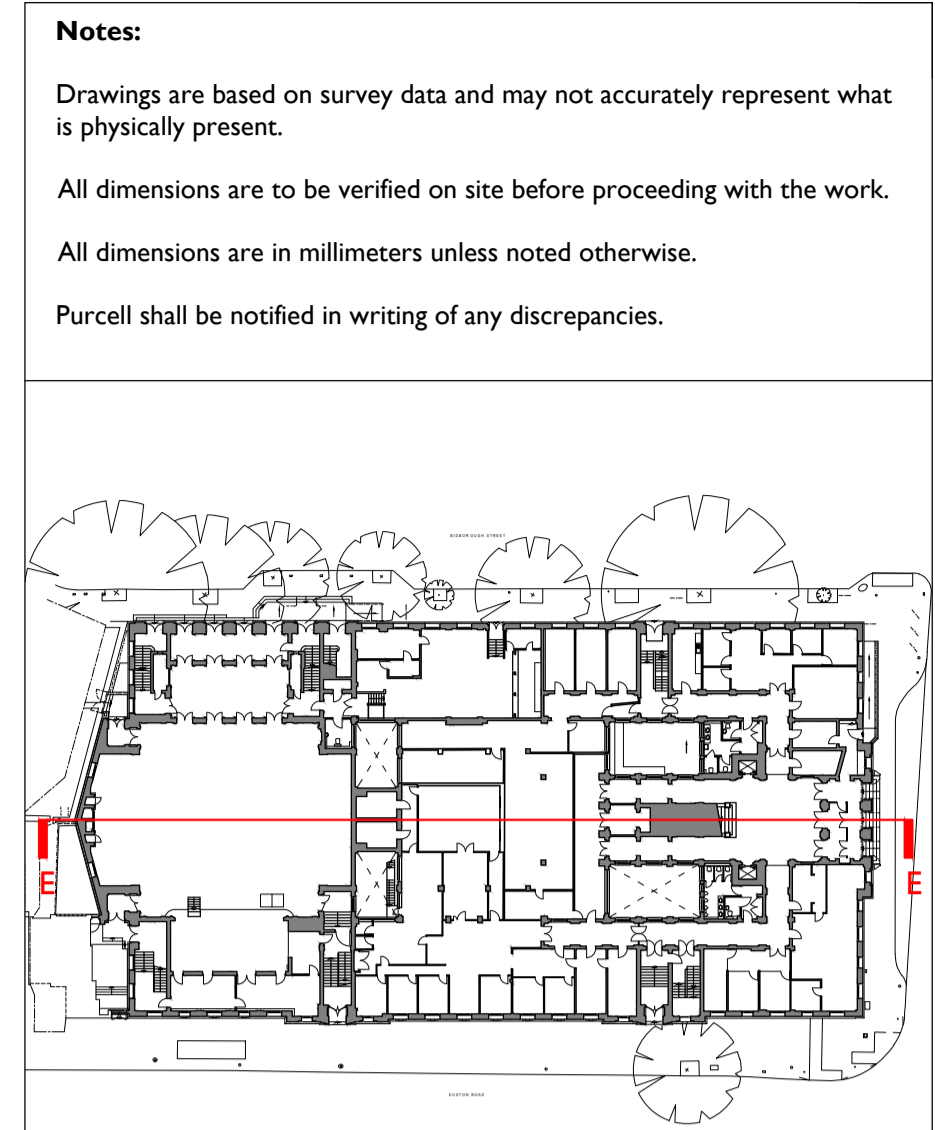

Demolitions & Alterations Key

- Original fabric defined as that documented in Archive Drawings. Where date of fabric is unknown, it is assumed as original.
- Original Fabric: Section of Wall/Slab to be Demolished
 - Original Fabric: Item to be Demolished
 - Overhead - 300mm wide opening to ceiling for high level concealed cable distribution - make good after installation
 - Overhead: Whole bay of vaulted ceiling to be removed for cabling distribution and reinstated
 - Original Fabric: High level opening in wall for services distribution
 - Floor trenches in slab for cable distribution
 - Manhole: Opening in slab
 - Non-Original Fabric: Section of Wall to be Demolished
 - Non-Original Fabric: Item to be Demolished
 - Window Number
 - Door Number
 - Annotation Item

Drawings to be read in conjunction with:
Internal Repairs & Builder's Works drawing series (93)000 for key spaces
Conservation Strategy Report CTH-PUR-MP-00-SP-A-00005

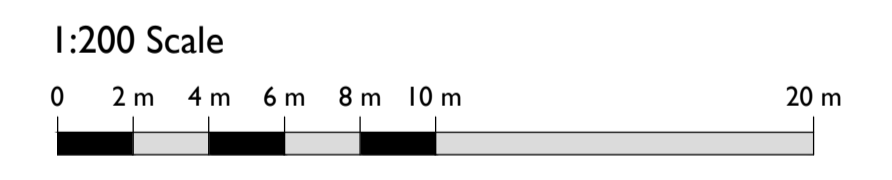

SS P00	17 Apr 2019	OB	NS
SS P01	07 Apr 2020	OB	NS

ISSUE	DATE	DRAWN	CHECKED	DESCRIPTION
DRAWING TITLE	GA PROPOSED DEMOLITIONS AND STRIP OUT SECTION E-E			
DRAWING NO.	CTH-PUR-MP-ZZ-DR-A-91204			
REVISION	P01			
SIZE & SCALE	A1L 1:200			
DRAWING STATUS	Issued for Planning			

CLIENT	Lendlease	
PROJECT	Camden Town Hall	
JOB NUMBER	238664	

I SECTION E-E PROPOSED DEMOLITIONS AND STRIP OUT
91204 1:200 @ A1