

- Existing slab to be demolished to introduce new lowered slab to align with external level.
- Section of lightwell façade to be removed to provide access into lightwell.
- Removal of detrimental non-original fabric for reordering of Civic democratic spaces
- Fabric of existing record stores removed for reorientation. 1No. record store door retained for reinsertion in new location.
- Judd street draft lobby removed
- Intrusive non original partitions to Judd street disabled entrance removed
- Builders work openings for services risers - refer to services engineers drawings for sizes of holes. Note: as existing structural layout is unknown, additional fabric may need to be removed to facilitate structural reinforcement.
- Section of existing slab to be demolished to introduce new lowered slab to align with external level.
- Existing panelling to be carefully removed and to be reinstated in front of new plenum for AHU on floor below.
- Bidborough street existing stepped ramped arrangement to Camden centre removed.
- Stepped arrangement to corner of Tonbridge Walk to be removed and floor level lowered to match external street level
- Existing windows removed and 2No. new openings created below for new entrance doors.
- Area of extensive damage (red outline). Significant repairs to stone door surrounds required - likely replaced to match existing. Plastic matting to floor removed.
- Non-original asphalt roof to Lightwell LW.01 removed between ground and basement floor. Extensive repairs to glazed brick at junctions required.

Notes:
 Drawings are based on survey data and may not accurately represent what is physically present.
 All dimensions are to be verified on site before proceeding with the work.
 All dimensions are in millimeters unless noted otherwise.
 Purcell shall be notified in writing of any discrepancies.

Demolitions & Alterations Key

- Original fabric defined as that documented in Archive Drawings. Where date of fabric is unknown, it is assumed as original.
- Original Fabric: Section of Wall/Slab to be Demolished
 - Original Fabric: Item to be Demolished
 - Overhead - 300mm wide opening to ceiling for high level concealed cable distribution - make good after installation
 - Overhead: Whole bay of vaulted ceiling to be removed for cabling distribution and reinstated
 - Original Fabric: High level opening in wall for services distribution
 - Floor trenches in slab for cable distribution
 - Manhole: Opening in slab
 - Non-Original Fabric: Section of Wall to be Demolished
 - Non-Original Fabric: Item to be Demolished
 - Window Number
 - Door Number
 - Annotation Item

Drawings to be read in conjunction with:
 Internal Repairs & Builder's Works drawing series (93)000 for key spaces
 Conservation Strategy Report CTH-PUR-MP-00-SP-A-00005

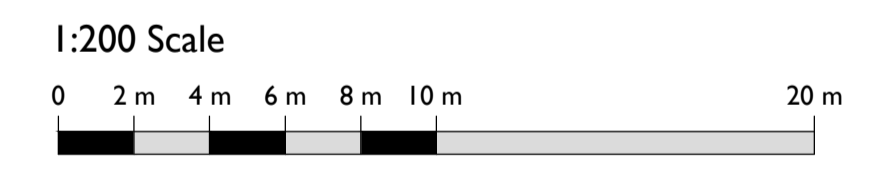

SS P00	17 Apr 2019	OB	NS
SS P01	07 Apr 2020	OB	NS

ISSUE	DATE	DRAWN	CHECKED	DESCRIPTION
DRAWING TITLE	GA PROPOSED DEMOLITIONS AND STRIP OUT GROUND LEVEL FLOOR PLAN			
DRAWING NO.	CTH-PUR-MP-G0-DR-A-91001			
REVISION	P01			
SIZE & SCALE	A1L 1:200			
DRAWING STATUS	Issued for Planning			

CLIENT	Lendlease	
PROJECT	Camden Town Hall	
JOB NUMBER	238664	

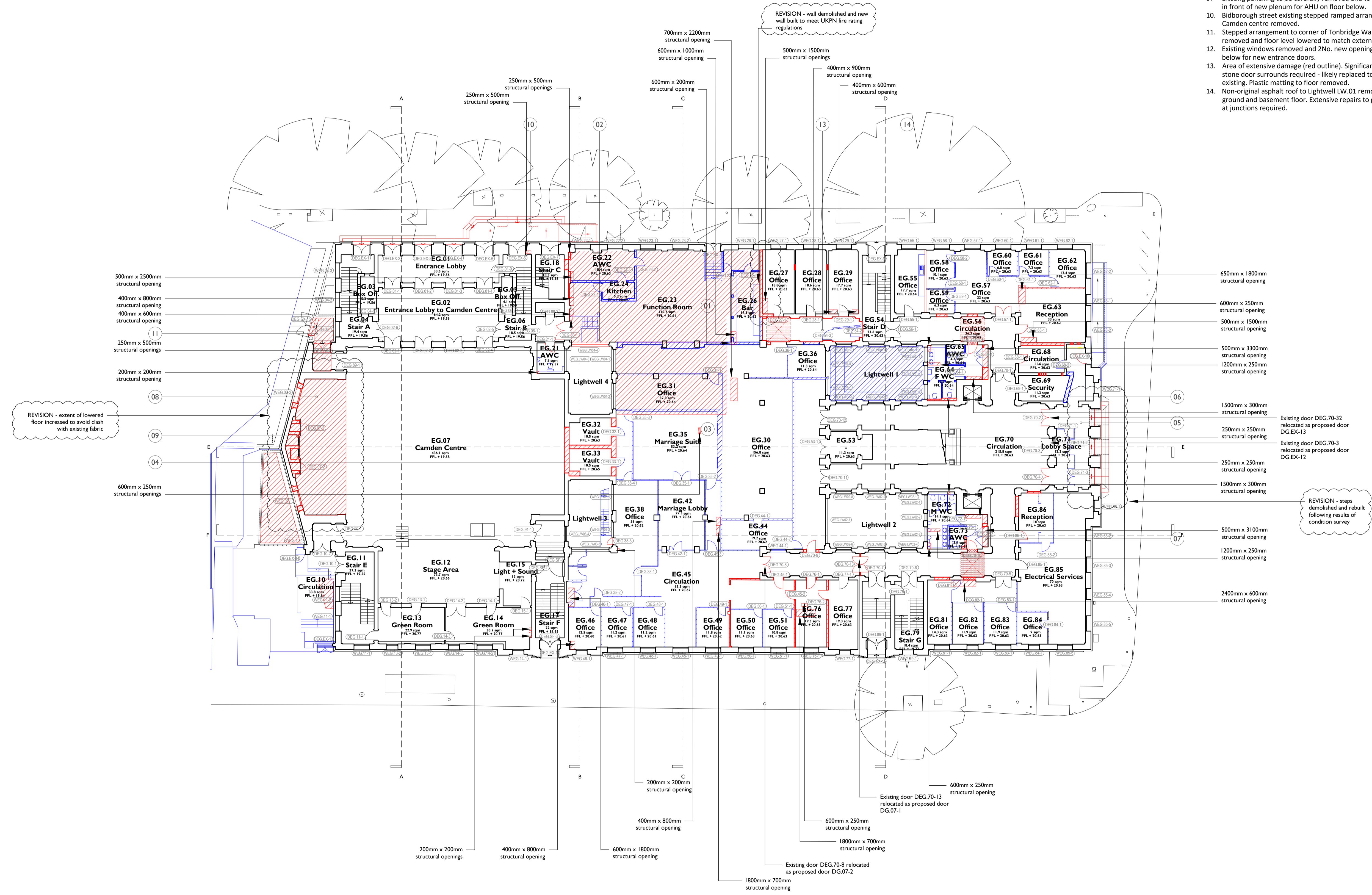

I 91001 1:200 @ A1
GROUND FLOOR LEVEL PLAN PROPOSED DEMOLITIONS AND STRIP OUT