

**1 LW.02 - NORTH ELEVATION**  
92106 1:50 @ A1

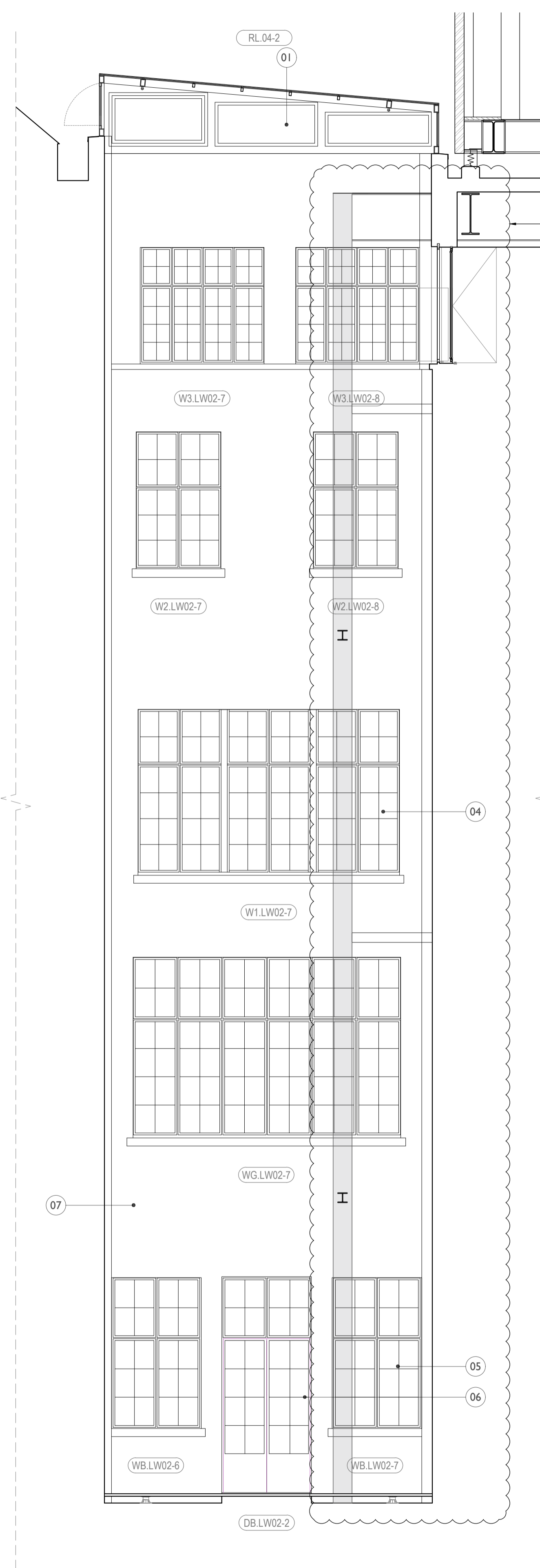

**2 LW.02 - EAST ELEVATION**  
92106 1:50 @ A1

1. Glazed roof lights over lightwells constructed with steel portal frame and with inset glazing
2. Outward opening AOVs for smoke ventilation integrated into rooflights
3. Upstand created on new roof construction to receive new rooflight
4. Existing windows to be retained and refurbished. Secondary glazing to be installed internally in specific locations at second and third for acoustic separation.
5. Secondary glazing to be installed at basement to achieve a 60min FR.
6. Doors to be replaced with new 60min FR doors with automatic openings for smoke ventilation.
7. Removal of redundant services and repair and cleaning of glazed brick façade
8. Number not used
9. AOVs to be integrated to side of rooflights

REVISION - New steel columns on new foundations supporting steel beams to form roof structure beneath ASHP units

**Notes:**  
Drawings are based on survey data and may not accurately represent what is physically present.  
All dimensions are to be verified on site before proceeding with the work.  
All dimensions are in millimeters unless noted otherwise.  
Purcell shall be notified in writing of any discrepancies.

**Proposed Works Key**

- Proposed Wall
- Window Number
- Door Number
- Refuge Point
- Annotation Item
- Manhole Location

Drawings to be read in conjunction with:  
Use Designation Plans: Drawing Series (92)900  
Conservation Strategy Report CTH-PUR-MP-00-SP-A-00005  
Window Strategy Report CTH-PUR-XX-XX-RP-A-00012

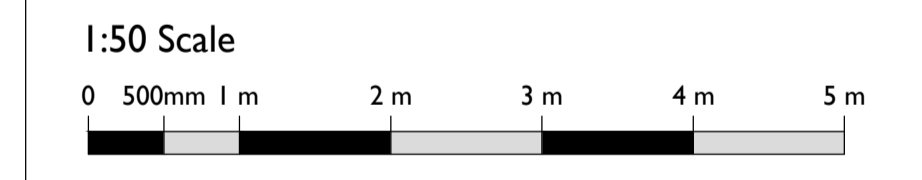

SS P01	07 Apr 2020	NS	NS
SS P00	17 Apr 2019	NS	NS

ISSUE	DATE	DRAWN	CHECKED	DESCRIPTION
<b>DRAWING TITLE</b>	GA PROPOSED NORTH-WEST LIGHTWELL 2 - ELEVATIONS			
<b>DRAWING NO.</b>	CTH-PUR-MP-ZZ-DR-A-92106			
<b>REVISION</b>	P01			
<b>SIZE &amp; SCALE</b>	A1L 1:50			
<b>DRAWING STATUS</b>	Issued for Planning			

<b>CLIENT</b>	Lendlease	
<b>PROJECT</b>	Camden Town Hall	
<b>JOB NUMBER</b>	238664	