

PROPOSED SITE PLAN - READ IN CONJUNCTION WITH DD-030

TO BE READ IN CONJUNCTION WITH ARBORICULTURAL METHOD STATEMENT AND ALL TREES AND LANDSCAPING PROTECTED ACCORDINGLY

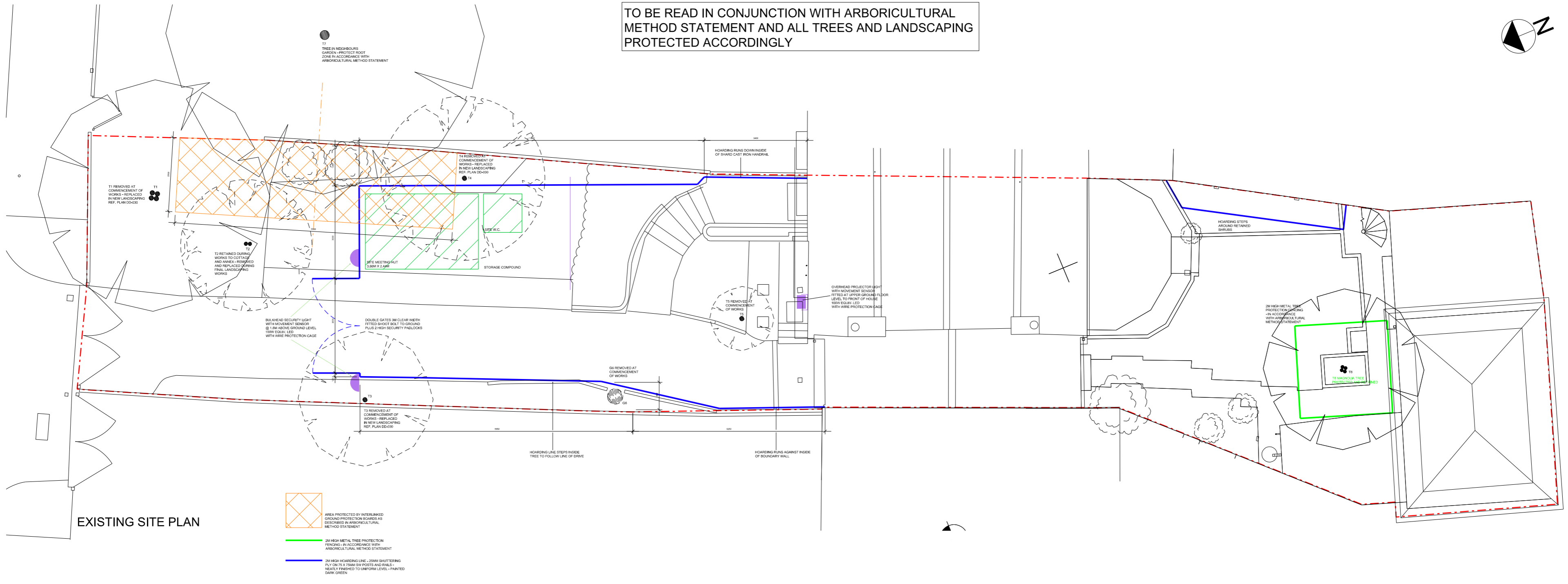

EXISTING SITE PLAN

- AREA PROTECTED BY INTERLOCKED GRADING PROTECTION BOARDS AS DESCRIBED IN ARBORICULTURAL METHOD STATEMENT
- 20M HIGH METAL TREE PROTECTION FENCING IN ACCORDANCE WITH ARBORICULTURAL METHOD STATEMENT
- 20M HIGH HOARDING LINE - 20MM BRACKETING 150x75x75mm (300x300x300mm) HEAVY FINISHED TO UNIFORM LEVEL - PAINTED DARK GREEN

DLA
DAVID LONG ARCHITECTS LTD
Architecture and Development Management
Fordsams, Littley Green, Chelmsford, Essex, CM1 1BU
Tel +44(0) 206 533 5555 / 07476 722554
e-mail dlong@dlatd.com
www.dlatd.com

NOTES:
1. DO NOT SCALE
2. ALL DIMENSIONS ARE IN METERS OR MILLIMETERS UNLESS NOTED OTHERWISE
3. ALL DISCREPANCIES TO BE NOTIFIED TO THE ARCHITECT IMMEDIATELY
4. ALL CONSTRUCTION WORK TO COMPLY WITH LOCAL AUTHORITY CODES AND BUILDING REGULATIONS, BRITISH STANDARDS AND OTHER REGULATIONS APPLICABLE TO BOTH DESIGN AND EXECUTION OF THE WORK.

CLIENT:
Elizabeth Birch

STRUCTURAL ENGINEERS:
BUILDING SERVICE ENGINEERS:
QUANTITY SURVEYOR:
PLANNING SUPERVISOR:

Rev	Date	Comment	By	Chk
A	03.04.20	PROPOSED SITE PLAN UPDATED	DL	
B	20.04.20	PROPOSED SITE PLAN UPDATED	DL	
C	04.05.20	ENTRANCE PATH AND BINSTORE AMENDED	DL	

PROJECT:
99 South End Road
LONDON NW3 2RJ

SCALE:	DRAWING NO:	REVISION:	ORIGINAL PAPER SIZE:
1:100	DD-001	C	A2

STATUS:
DETAIL DESIGN