

SECTION E-E

2

1:50 @ A3

GLR-P-203

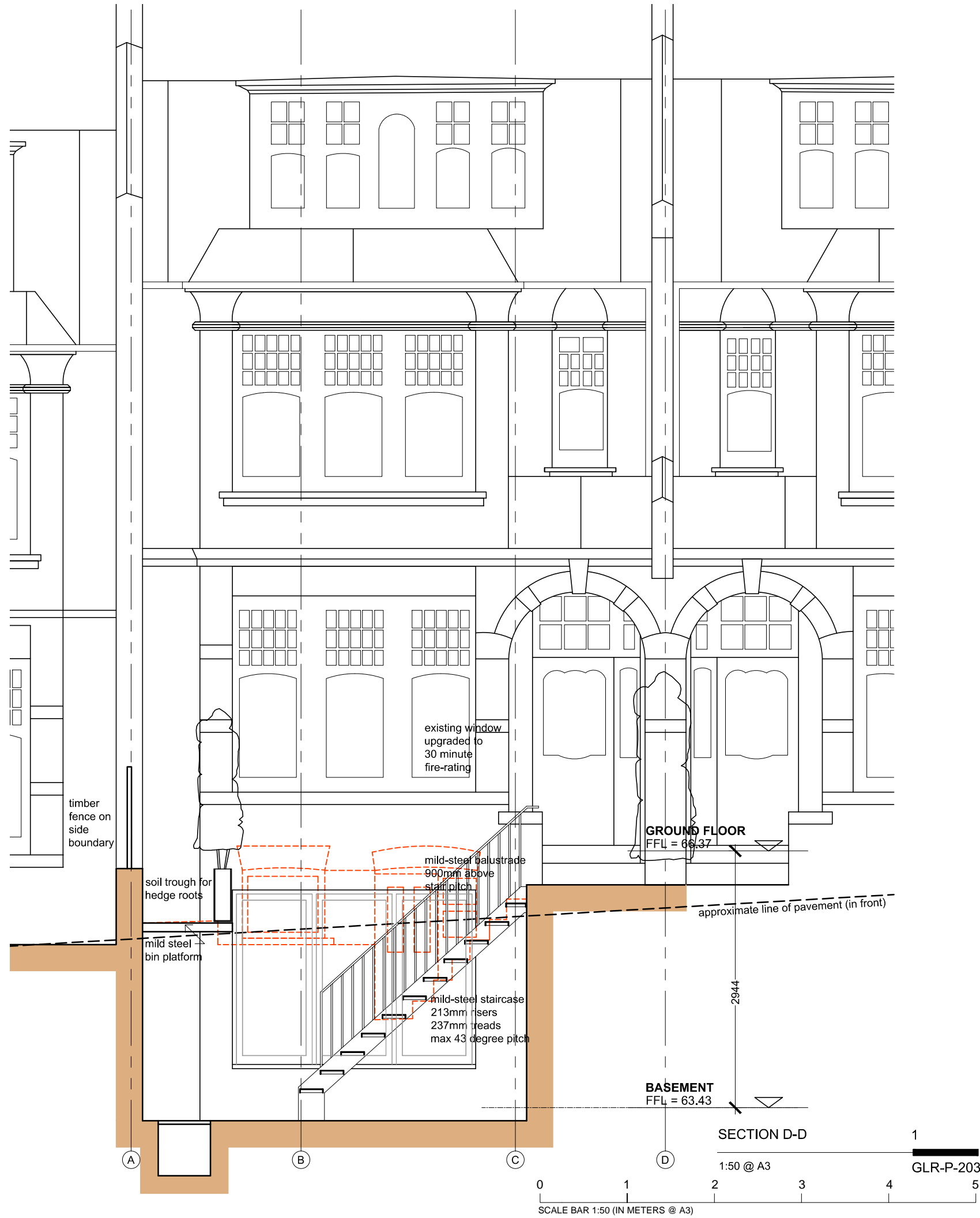

SECTION D-D

1

1:50 @ A3

GLR-P-203

SCALE BAR 1:50 (IN METERS @ A3)

general notes

THIS DRAWING IS COPYRIGHT OF STUDIO MARK RUTHVEN. THIS DRAWING MUST BE READ IN CONJUNCTION WITH THE DESIGNER'S RISK ASSESSMENT, SPECIFICATION AND ALL OTHER RELEVANT DOCUMENTATION AND DRAWINGS. STUDIO MARK RUTHVEN ACCEPTS NO LIABILITY FOR ANY EXPENSE, LOSS OR DAMAGE OF WHATSOEVER NATURE AND HOWEVER ARISING FROM ANY VARIATION MADE TO THIS DRAWING OR IN THE EXECUTION OF THE WORK TO WHICH IT RELATES WHICH HAS NOT BEEN REFERRED TO THEM AND THEIR APPROVAL OBTAINED. FOR THE PURPOSE OF CONSTRUCTION DO NOT SCALE FROM THIS DRAWING OR THE COMPUTER DIGITAL DATA, ONLY FIGURED DIMENSIONS ARE TO BE USED. IF IN DOUBT ASK.

purpose of issue

PLANNING

notes

CLIFTON INTERIORS LTD
 168 Regents Park Road
 Primrose Hill, London NW1 8XN
 t : 020 7586 5533
 f : 020 7586 1987
 e : info@cliftoninteriors.com
 www.cliftoninteriors.com

C	TIMBER FENCE OMITTED.	30/04/20	PW
B	SECTION E-E THROUGH FRONT LIGHTWELL ADDED.	31/01/20	PW
A	PLANNING APPLICATION.	02/09/19	PW

rev	notes	date	by	checked
-----	-------	------	----	---------

* for construction do not scale from this drawing.
 * check all dimensions on site.

StudioMarkRuthven
 architecture
 92 Prince of Wales Road, London, NW5 3NE
 11 & 13 Patwell Street, Bruton, BA10 0EQ
 T 020 7485 0050

project name

**10 GLENMORE ROAD
 LONDON
 NW3 4DB**

drawing title

**PROPOSED
 SECTION D-D &
 SECTION E-E**

scale	1:50 @ A3	date	14.01.19
-------	-----------	------	----------

drawn by	PW	checked	MR
----------	----	---------	----

project ref.	drawing no.	revision
--------------	-------------	----------

GLR	GLR-P-203	C
-----	-----------	---