

It is recommended that clients and builders use a JCT small works contract. Note that building control can change details on site so that the build conforms to the building regulations. These notes are general purpose construction notes for building regulation approval and are in no way detailed to specification standard. The clients attention is drawn to the Party Wall Act 1996 with regards to works taking place near adjoining owners land and buildings. It is the Building owners responsibility that the act is complied with. This plan should not be scaled and careful check measurements should be made on site by the contractor with any major discrepancies being reported to the client or his building surveyor before the start of works. Any changes in the design are at the clients and contractors own risk. Oswicks Property Professionals holds no responsibility for any mis-measurements on site as these should be checked before the start of works by the contractor or in the case of any changes in design.

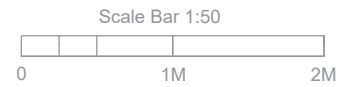

**LEGEND**

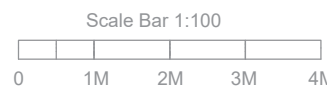
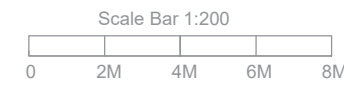
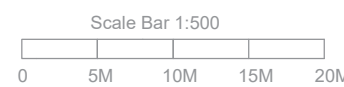
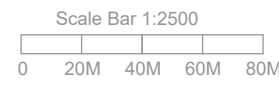
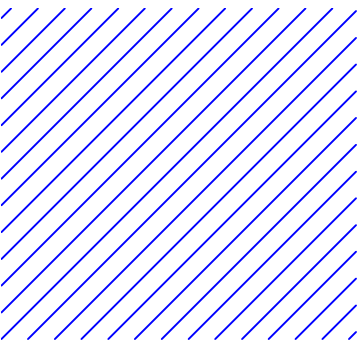

**Roof 1 - Dormer Roof**  
Renewal complete of roof construction. New deck to receive built-up mineral felt waterproofing system complete with joists, 18mm plywood deck, PUR insulation and all associated detailing.

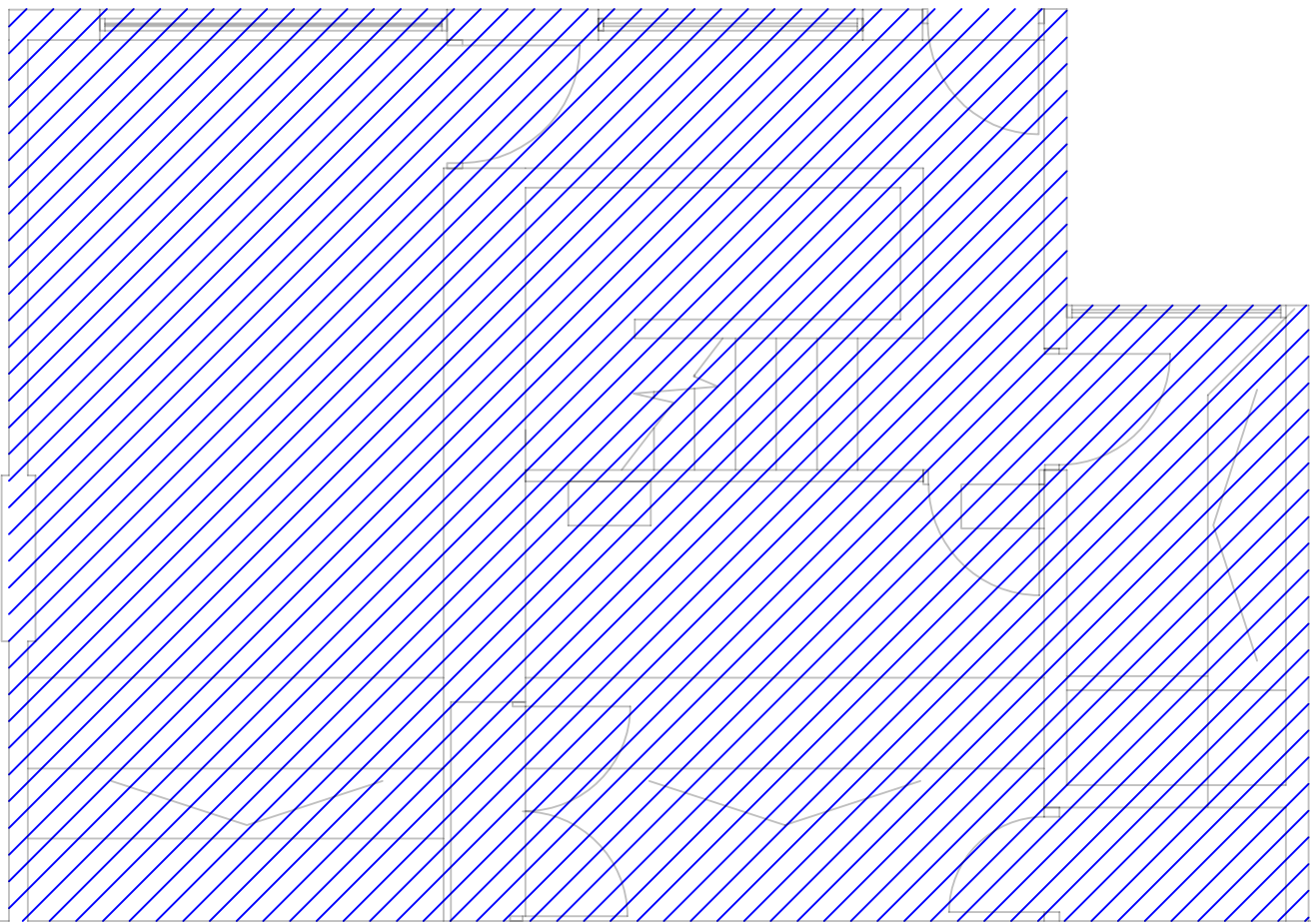

**Roof Plan - Fourth Floor (Roof 1)**  
**Scale - 1:50**

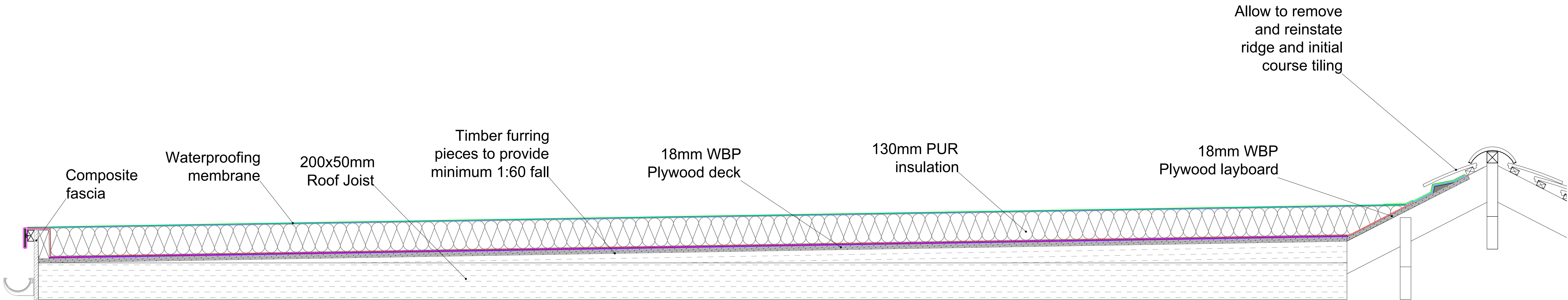

**Proposed Roof Construction**  
**Scale - 1:10**

Oswicks Ltd (Head Office)  
5/7 Head Street, Halstead  
Essex, C09 2AT



Tel: 01787 477559  
Email: [info@oswick.co.uk](mailto:info@oswick.co.uk)  
Web: [www.oswicks.co.uk](http://www.oswicks.co.uk)

Client :- **Overbury**  
Site :- **Natwest Branch, 212 - 214 High Holborn, Holborn, London, WC1V 7BF**

Plan Type :- **T**  
Start Date :- **17-03-2020**  
Drawn By :- **RC / PW**

Paper Size :- **A1**  
Revision :- **-**  
Note :- **-**

Scale :- **As indicated**  
Updated :- **-**

Project :- **Proposed Roofing Works**

Detail Shown :- **Roof Plan - Area 1**

Plan No. :- **20-080-AS-02**