

1 DETAIL SECTION AA
DD-027

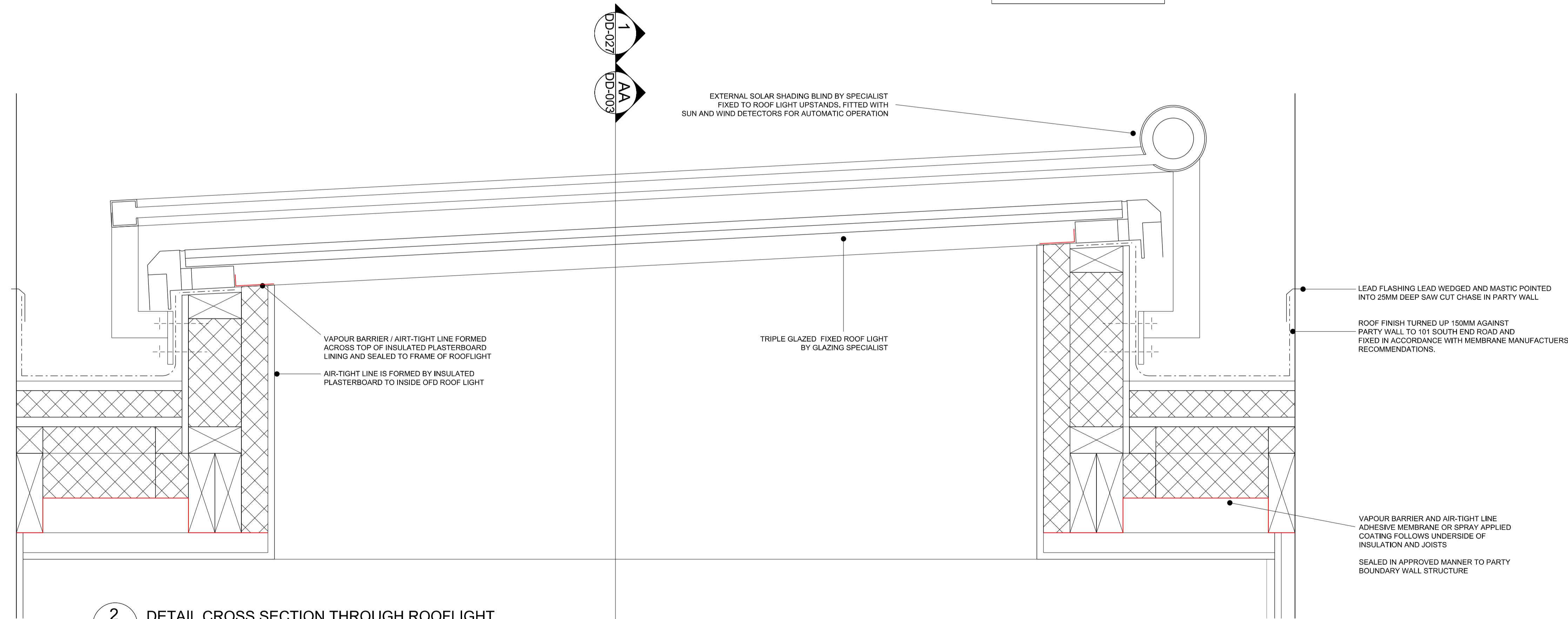

2 DETAIL CROSS SECTION THROUGH ROOFLIGHT WITH ROOF ABUTMENT TO PARTY WALL
DD-027

DLA
 DAVID LONG ARCHITECTS LTD
 Architecture and Development Management
 Fordhams, Littley Green, Chelmsford, Essex, CM3 1BU
 Tel +44(0) 208 533 5555 / 07478 722554
 e-mail dlong@dlatd.com
 www.dlatd.com

NOTES:
 1. DO NOT SCALE
 2. ALL DIMENSIONS ARE IN METERS OR MILLIMETERS UNLESS NOTED OTHERWISE
 3. ALL DISCREPANCIES TO BE NOTIFIED TO THE ARCHITECT IMMEDIATELY
 4. ALL CONSTRUCTION WORK TO COMPLY WITH LOCAL AUTHORITY CODES AND BUILDING REGULATIONS, BRITISH STANDARDS AND OTHER REGULATIONS APPLICABLE TO BOTH DESIGN AND EXECUTION OF THE WORK.

CLIENT:
 Elizabeth Birch

STRUCTURAL ENGINEERS:

BUILDING SERVICE ENGINEERS:

QUANTITY SURVEYOR:

PLANNING SUPERVISOR:

ISSUE RECORD				
Rev.	Date	Comment	by	ch
-	10.04.20	FIRST ISSUE	DL	

PROJECT:
 99 South End Road
 LONDON NW3 2RJ

STATUS:
 DETAIL DESIGN

TITLE: SIDE EXTENSION FLAT ROOF, GLASS ROOF AND ACCESS HATCH DETAILS			
SCALE:	DRAWING No:	REVISION:	ORIGINAL PAPER SIZE:
1:5	DD-027	-	A1
JOB NO: 177			