

ORIGINAL TIMBER JOISTS  
220mm x 60mm @ 400mm C/C.  
BEARING ONTO STEP IN MASONRY  
WALL.

VAULTED MASONRY  
CELLARS

VAULTED MASONRY FLOOR  
WITH RUBBLE FILL OVER.

MONTAGUE PLACE

RUSSELL SQUARE

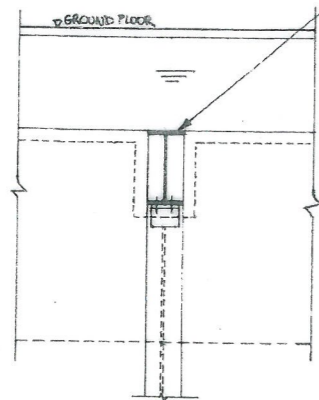

DETAIL A-A  
(1:10)

EXISTING TIMBER  
JOISTS ASSUMED  
TO BE SUPPORTED  
ON STEEL FRAME

ORIGINAL TIMBER JOISTS  
220 x 60mm @ 350mm C/C  
WITH PUSSING.

S.2.2.- CONTRACTOR TO  
DETERMINE EXISTING  
FLOOR ARRANGEMENT  
FOR NEW SERVICE  
RISERS. ALLOW FOR 6 NO.  
OPENINGS FOR GROUND TO SECOND  
FLOOR

FLOOR STRUCTURE ASSUMED  
BASED ON RECORDED DRAWINGS  
OF PROPERTY 42.

- NOTE
- DO NOT SCALE FROM THIS DRAWING.
  - THE STRUCTURAL ARRANGEMENT SHOWN ON THESE DRAWINGS ARE BASED ON PRELIMINARY SITE INVESTIGATIONS CARRIED OUT JANUARY 2018, AND ARCHIVE DRAWINGS OF NEIGHBOURING PROPERTY No. 42.

A	21/1/18	REV REMOVED.	AL
-	21/1/18	ISSUED FOR TENDER	LK

BRITISH MUSEUM,  
38 RUSSELL SQUARE

EXISTING STRUCTURE  
GROUND FLOOR PLAN

drawn RG	checked LK
date FEB'18	scale (original - A1) 1:50

Alan Baxter

75 Cowcross Street London EC1M 6EL  
tel 020 7250 1555  
email aba@alanbaxter.co.uk

www.alanbaxter.co.uk

fig. no. C1756702/ S02	rev. A
---------------------------	-----------