

Note:

- 1100mm Metal guarding around hatch entry. To be same colour finish as plant screen
- New projecting PPC black metal entrance canopy with integrated signage and lighting.
- New crittal style metal framed, glazed entrance doors. Black colour.
- New structural infill supported by new steel beams.
- New double glazed crittal style metal slim line windows. Black colour.
- New 7th floor mansard storey. Standing seam zinc cladding. Bronze colour finish.
- Existing 6th floor structure retained and re-clad with new standing seam zinc cladding - bronze colour finish
- New double glazed, metal framed full height windows. Black colour
- New PPC black metal spandrel panels.
- New louvered metal plant screen. PPC Grey colour
- Existing slab and structure retained.
- New structural infill.
- New lift shaft.
- New vertical core extension. Glazed bricks to match existing Wild Court facade.
- New raised plant deck

KEY :

- Existing Walls
- Proposed Walls
- Existing roof profile
- Indicative MEPH services

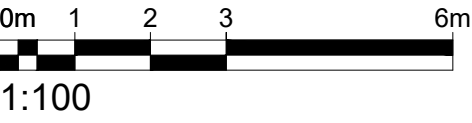

P8	Issued for Planning - Plant screen amended	AC	08.04.20
P7	Issued for Planning - Plant screen annotations updated	AC	24.03.20
P6	Issued for Planning - Plant screen set back	AC	18.03.20
P5	Issued for Planning - Plant screen amended	AC	06.03.20
P4	Issued for Planning	AC	28.11.19
Rev.	Description.	By	Date

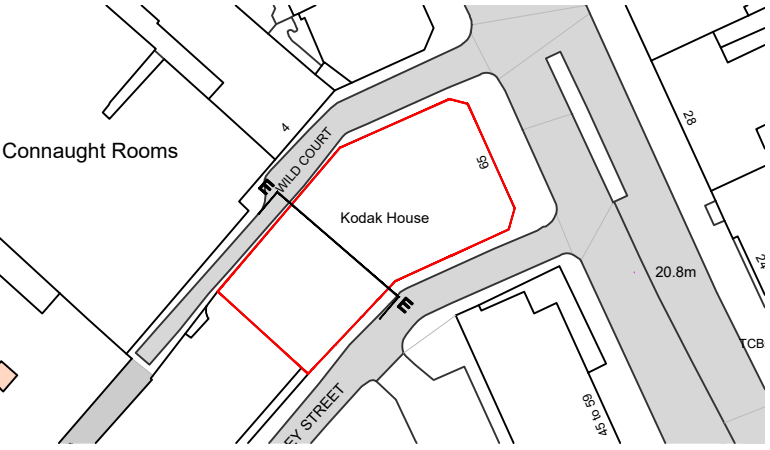

Client
Kings Keeley Limited C/o Clearbell Capital LLP
Project
65 Kingsway - Base Scheme

Proposed Section EE				
Status	Purpose of issue		RIBA stage	
S2	For Planning		2	
Project No.	Drawn	Checked	Scale	Rev.
1914	FB	TJ	1:100 @ A1 1:200 @ A3	P8

Drawing No.

1914-BG-01-ZZ-DR-A-20.255

Do not scale from this drawing. The Contractor is to take and check all dimensions on site before work commences. Discrepancies must be reported to the Architect. Subcontractors must verify all dimensions on site before making a shop drawing or commencing manufacturing. This drawing is copyright. ©

© Copyright Barr Gazetas Ltd.
A 10 Heddon Street, London, W1B 4BG
T 0207 636 5561
W www.barrgazetas.com

Original position of plant screen, as rev P4 28.11.19

Rev P5 06.03.20: Keeley street Plant screen reduced in height by 300mm, and sloped above 2m.

Rev P6 18.03.20: Keeley St plant screen set back 1.7m

Rev P8 08.04.20:
Plant screen set back on Wild Court. See Roof Plan Rev P8

Original position of plant screen beyond , as rev P4 28.11.19

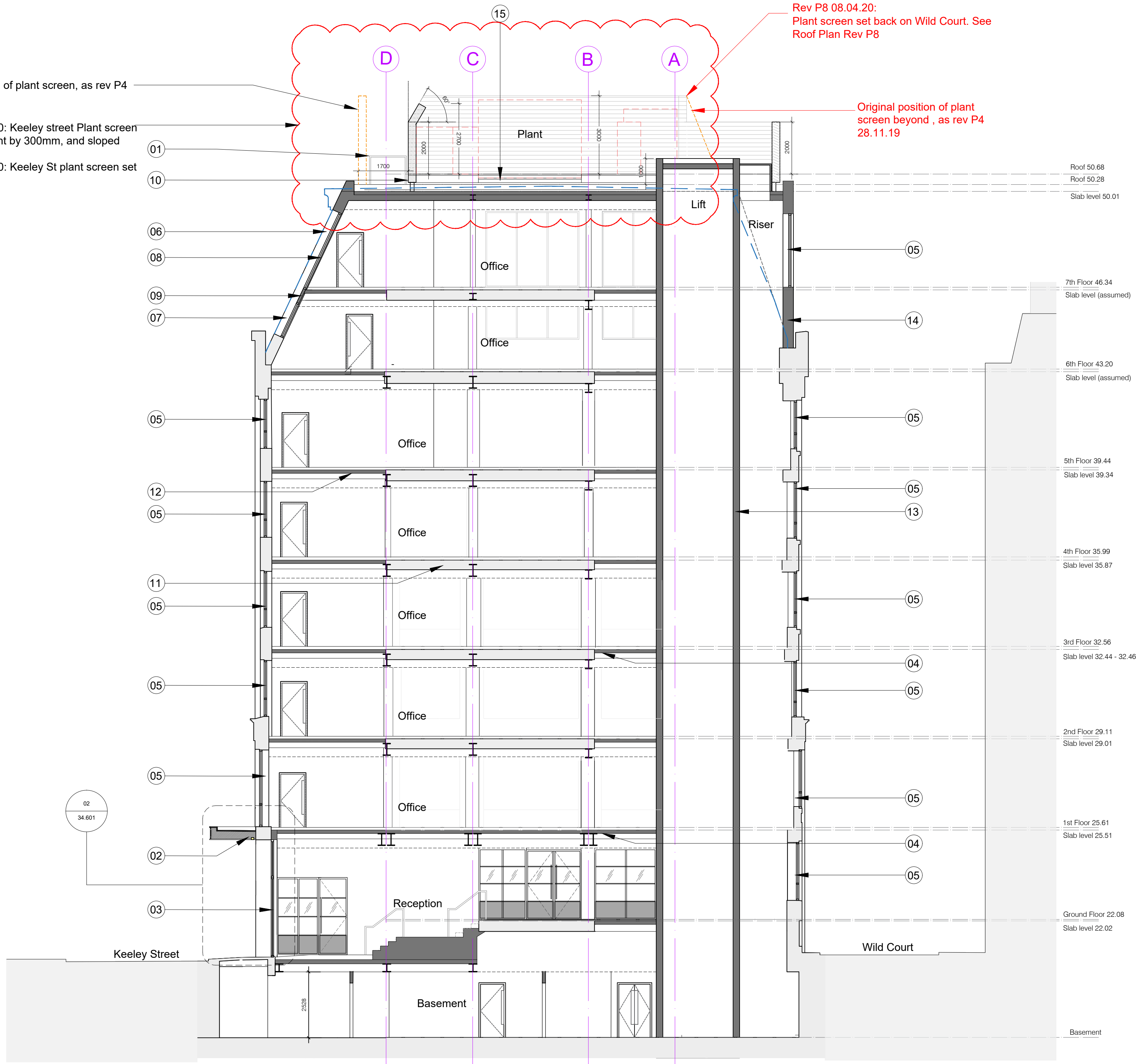

EE
20.202
Proposed Section EE
1:100@A1, 1:200@A3