

PROPOSED ROOF PLAN

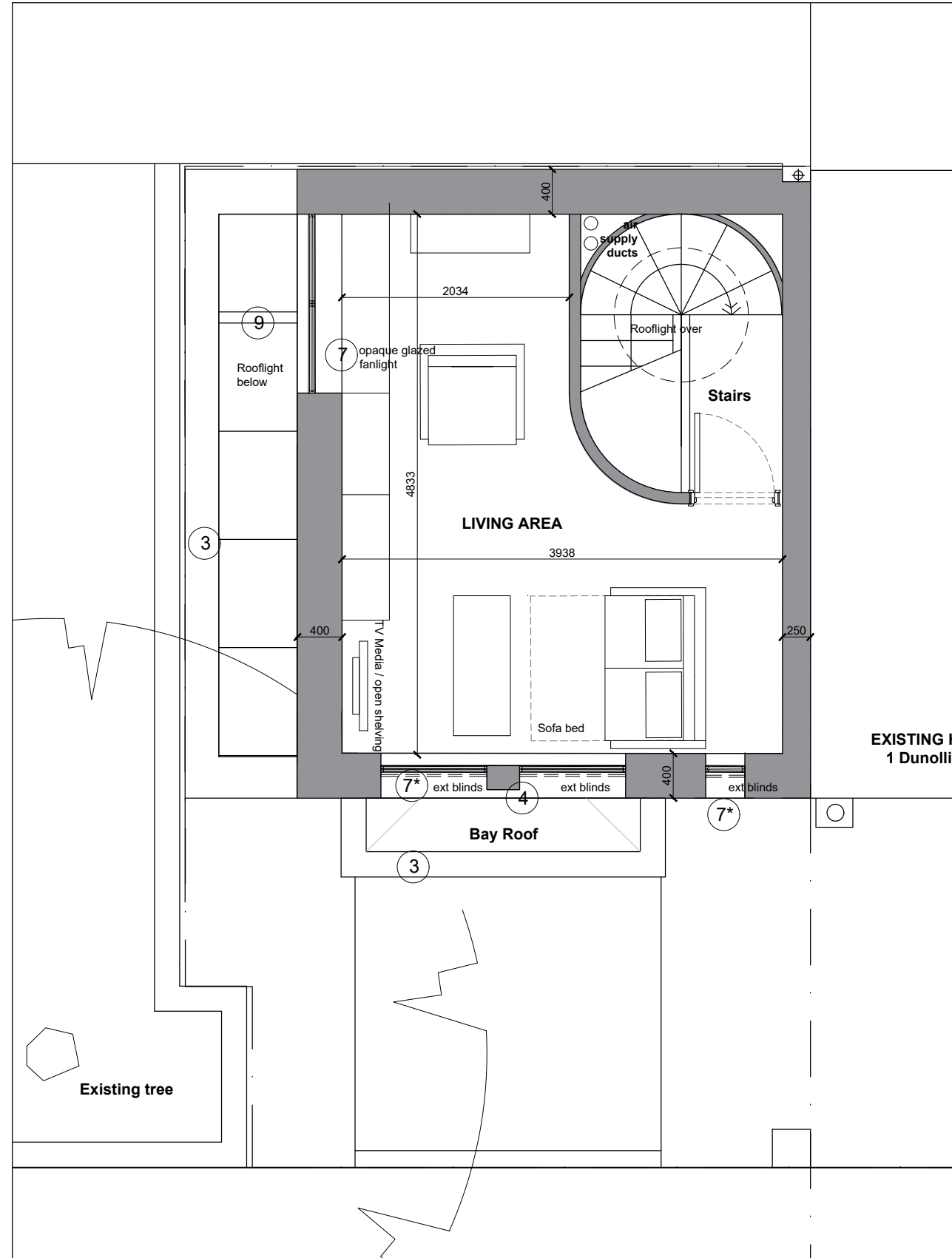

PROPOSED FIRST FLOOR PLAN

- ### NOTES
- 1 extensive 'sedum green roof'
  - 2 Fairfaced Brickwork to match existing stock brickwork. Second hand London stock bricks
  - 3 Reconstituted 'Portland' stone parapet copings
  - 4 Reconstituted 'Portland' stone window reveals cills & lintels.
  - 5 Welded steel railings Bronze/grey ppc coated
  - 6 Gutters, hoppers & downpipes - all to be light grey zinc.
  - 7 Aluminium framed triple glazed window system Bronze/grey ppc coated.
  - 7\* Glazing as 7 with external motorised solar blinds set into window reveal channels
  - 8 Natural stone paving.
  - 9 Frameless glass triple glazed continuous rooflights
  - 10 Frameless glass balustrade
- NEW WALLS

Do not scale from this drawing  
 All dimensions are to be checked on site  
 Any discrepancies are to be reported immediately to the Architect or Main Contractor

COPYRIGHT © 2014  
 ALL RIGHTS DESCRIBED IN THE CHAPTER IV OF THE COPYRIGHT DESIGN AND PATENTS ACT 1988, HAVE BEEN GENERALLY ASSERTED

Notes:

P6	06.04.20	Spec notes updated	FB
P5	29.01.20	Revised Bay - Planning Application	FB
P4	31.10.19	Planning Application	FB
P3	25.10.18	Main Roof spec revised	FB
P2	12.10.18	Revised 1st floor windows	FB
P1	25.09.18	New Scheme as Pre-app requirements	FB

Client  
 Karena Mond  
 1 Dunollie Road  
 London NW5 2XN

Project  
**Garage Site House**  
 Garages 1 Dunollie Road London NW5 2XN

Drawing  
 First & Roof Plans  
 General Arrangement  
 Proposed

Project No. Drawing No. Issue Status  
**KM2017 SK 13 P6 P**

Scale Date Drawn By Checked By  
 1:50@A3 Oct 2017 FB FB

**FRANCIS BIRCH ARCHITECT**  
 Francis Birch Dipl Arch (Oxford) RIBA Architect  
 11 North Hill Avenue, Highgate, London N6 4RJ  
 T: 0208 342 8602  
 M: 07432 553861  
 E: fbirch123@gmail.com

