



EXTERNAL SEATS : 12no.		EXTERNAL BARRICADE : 4no.		
 <p>chairs</p> <p>table 600x600</p> <p>chairs</p>	<p>TABLES &amp; CHAIRS EXTERIOR FURNITURE</p> <p><b>6no. chairs - Etoile archivolto by Green.</b> colour Green 570w 575d 840h</p> <p><b>3no. tables - surfside square table</b> colour white and aluminum. 600w 600d 780h.</p> <p>exterior grade furniture made from polypropylene and powder coated in green and white finish.</p>	 <p>WEIGHTEND BARRICADE</p> <p><b>2no.</b> <b>W:1600mm / 1000mm</b> <b>H: 980mm(Pole Height)</b> exterior Weightend Barricade PVC mesh banner</p> <p>PLAN</p> 	<p>FRONT ELEVATION</p> 	<p>SIDE ELEVATION</p> 

NOTE:  
ALL EXTERNAL FURNITURE  
AND BARRICADE TO BE  
TAKEN INSIDE WHEN STORE  
IS CLOSED

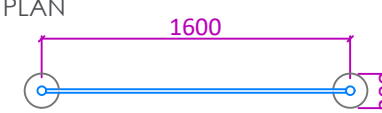
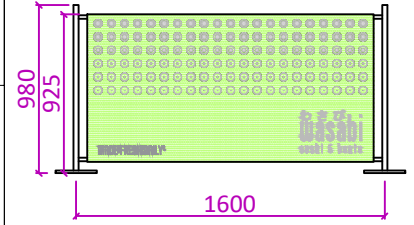
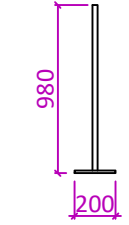
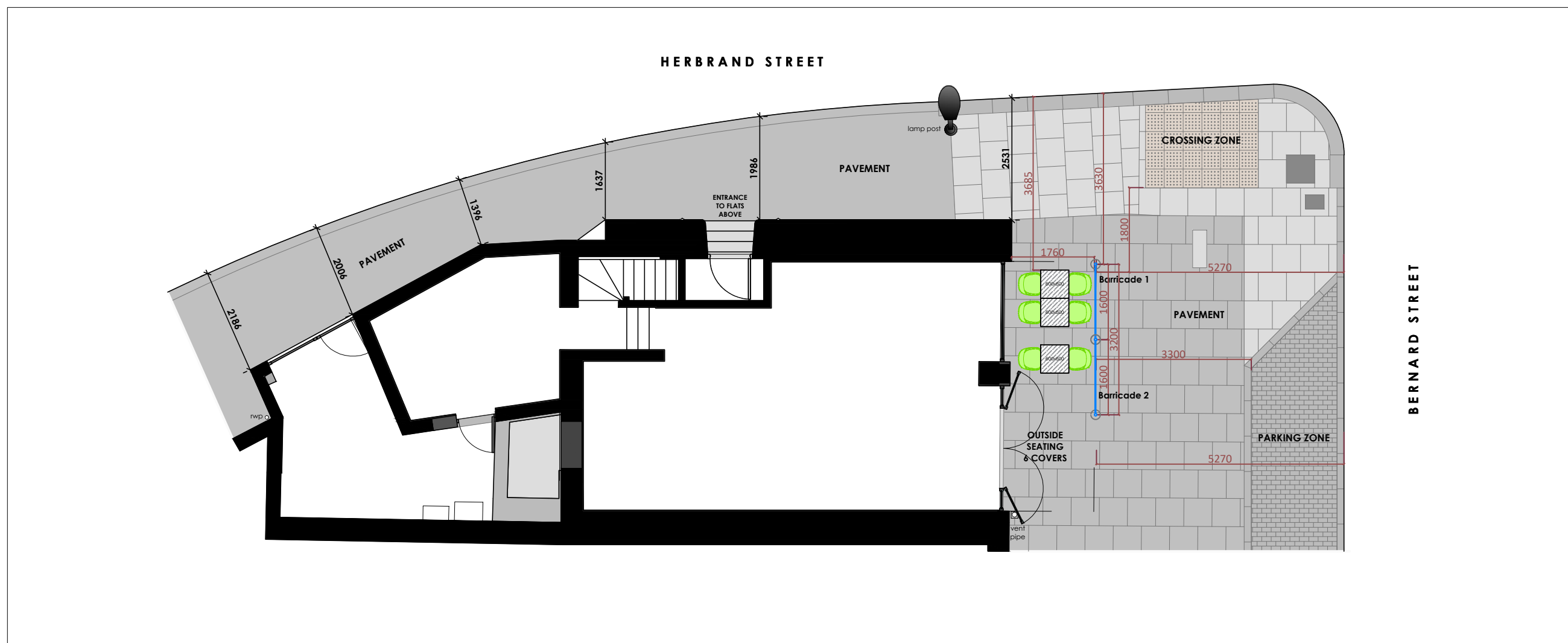

Existing External Seating Plan  
Scale 1:50

Scale 1:100 @ A3

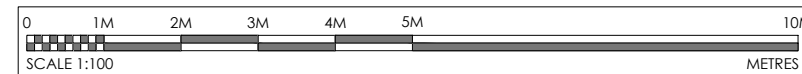

<p>This drawing is the copyright of Wasabi Ltd. This drawing cannot be copied, reproduced, retained or disclosed to any unauthorised person without prior permission in writing from the designer.</p>	<p>This drawing represents a performance guide upon which the contractor/subcontractor must base his/her working drawings &amp; details. Include all necessary tolerances prior to manufacture and installation Contractor to must undertake a full survey of the area to establish all dimensions &amp; ensure accurate setting out. Advise on suitability of all details shown to ensure structural stability, ease and economy of construction Refer to digital master artwork in regard to all graphic work shown</p>	NO.	Description	Drawn	Date	Description	Project	Client	
		R1	ISSUED FOR PLANING	J	08/02/2018	Proposed External Seating plan	Wasabi Russell Square	3 Bernard St, Bloomsbury, London WC1N 1LU	Wasabi.Co.Ltd Unit5, Origin Business Park, Rainsford Road, London NW10 7FW T 020 7428 1550 F 020 7428 5855
		R2	ISSUED FOR PLANING	J	13/06/2018				
				Scale	Drawn by	Date	Status	Revision	Drawing No
		1:100@A3	J./AF	08.02.2018	For Planing	R2	162-W-221-E		