

Consented Drawing Planning reference
2015/0487/P dated 22nd December 2016



Fourth Floor Plan
GA.04 1:200@A3_1:100@A1

Revisions				
A	06/10/14	General drawing revisions	K	03/07/15
B	08/10/14	Amendment to Staircase arrangement		
C	07/11/14	Amendment to drawings generally		
D	20/11/14	Amendment to drawings generally		
E	24/11/14	Amendment to drawings generally		
F	18/12/14	Amendment to drawings generally		
G	07/01/15	Amendment to drawings generally		
H	15/01/15	Submitted for Planning Application		
J	24/06/15	Submitted for information		

Information contained within this drawing is the sole copyright of 21st Architecture Ltd, and is not to be reproduced without express permission. No implied licence exists. This drawing not to be used for land transfer or valuation purposes. Do not scale from this drawing. All dimensions & levels are to be checked on site by the contractor. Issued for purposes indicated only. Drawing errors and omissions to be reported to the architect.

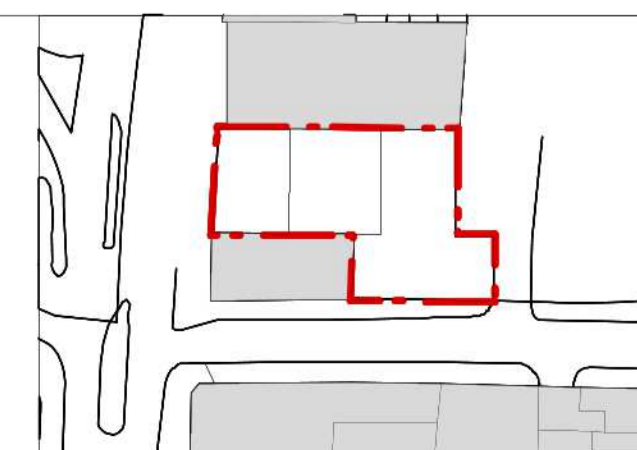

Client
SRE Haverstock Hill Ltd
Project
Marine Ices
Haverstock Hill, London, NW3 2BL

Drawing Title
Proposed Fourth Floor
General Arrangement

21st
Architecture Ltd
Twenty First Architecture Ltd,
314 Goswell Road,
London,
EC1V 7AF
Tel: +44(0)20 7862 0282
www.21starchitecture.com

Status	Planning	Drawn	JSP	Checked	TJS
Scale	1:100 @ A1 1:200 @ A3	Date	Aug 2014		
Drwg. No.	177_GA_04	Revision	K		