

Consented Drawing Planning reference  
2015/0487/P dated 22nd December 2016

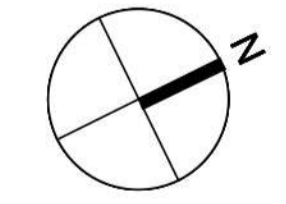

**A**  
GA.01 **First Floor Plan**  
1:200@A3\_1:100@A1

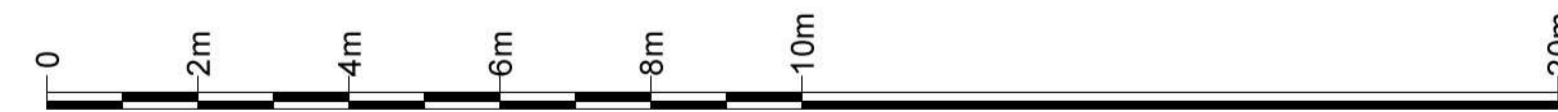

Revisions		
A	06/10/14	General drawing revisions
B	08/10/14	Amendment to Staircase arrangement
C	07/11/14	Amendment to drawings generally
D	20/11/14	Amendment to drawings generally
E	24/11/14	Amendment to drawings generally
F	18/12/14	Amendment to drawings generally
G	07/01/15	Amendment to drawings generally
H	15/01/15	Submitted for Planning Application

Information contained within this drawing is the sole copyright of 21st Architecture Ltd, and is not to be reproduced without express permission. No implied licence exists. This drawing not to be used for land transfer or valuation purposes. Do not scale from this drawing. All dimensions & levels are to be checked on site by the contractor. Issued for purposes indicated only. Drawing errors and omissions to be reported to the architect.

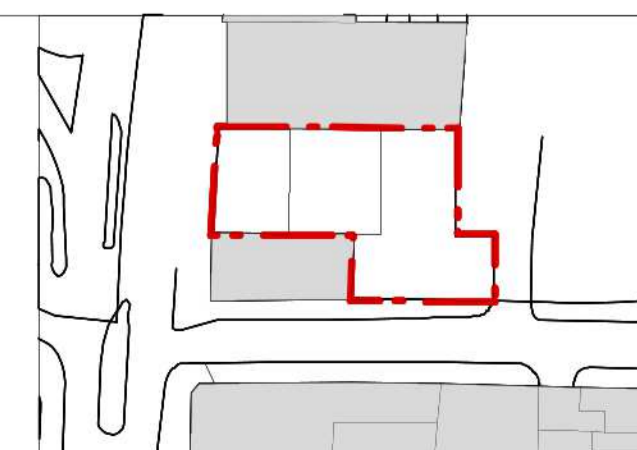

Client	SRE Haverstock Hill Ltd	
Project	Marine Ices Haverstock Hill, London, NW3 2BL	
Drawing Title	Proposed First Floor General Arrangement	
Status	Planning	Drawn JSP Checked TJS
Scale	1:100 @ A1 1:200 @ A3	
Drwg. No.	177_GA_01	Date Aug 2014 Revision H

**21st Architecture Ltd**  
Twenty First Architecture Ltd,  
314 Goswell Road,  
London,  
EC1V 7AF  
Tel: +44(0)20 7862 0282  
www.21starchitecture.com