

Consented Drawing Planning reference 2015/0487/P dated 22nd December 2016

-  London Stock Brick
-  Grey Brick
-  Glazing
-  Opaque glazing
-  Black Metal
-  Champagne Cladding
-  Off-white Cladding

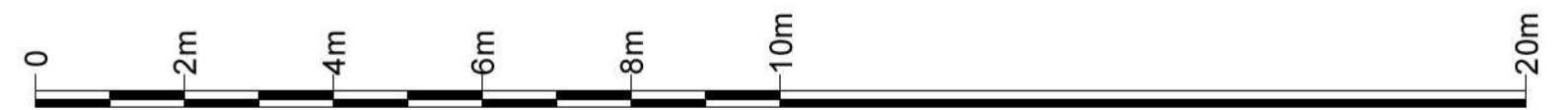

**A Proposed South East Elevation**  
 GE.01 1:200@A3\_1:100@A1



Revisions		
A	26/11/14	General drawing revisions
B	15/12/14	General drawing revisions
C	07/01/15	General drawing revisions
D	15/01/15	Submitted for planning

Information contained within this drawing is the sole copyright of 21st Architecture Ltd, and is not to be reproduced without express permission. No implied licence exists. This drawing not to be used for land transfer or valuation purposes. Do not scale from this drawing. All dimensions & levels are to be checked on site by the contractor. Issued for purposes indicated only. Drawing errors and omissions to be reported to the architect.

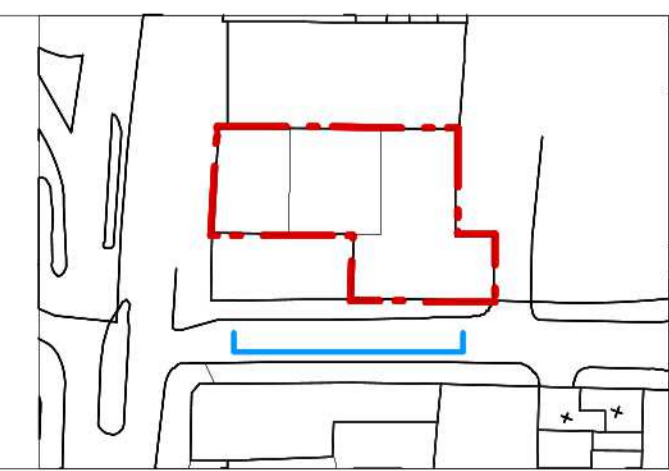

Client	SRE Haverstock Hill Ltd
Project	Marine Ices Haverstock Hill, London, NW3 2BL
Drawing Title	Proposed South East Elevation General Arrangement

 21st Architecture Ltd	Status: Planning Scale: 1:100 @ A1 1:200 @ A3 Drwg. No.: 177_GE_01	Client: Twenty First Architecture Ltd, 314 Goswell Road, London, EC1V 7AF Tel: +44(0)20 7962 0282 www.21starchitecture.com
	Drawn: IS Checked: TJS Date: Nov 2014 Revision: D	