

Consented Drawing Planning reference  
2015/0487/P dated 22nd December 2016



A  
GA.02  
**Second Floor Plan**  
1:200@A3\_1:100@A1

Information contained within this drawing is the sole copyright of 21st Architecture Ltd, and is not to be reproduced without express permission. No implied licence exists. This drawing not to be used for land transfer or valuation purposes. Do not scale from this drawing. All dimensions & levels are to be checked on site by the contractor. Issued for purposes indicated only. Drawing errors and omissions to be reported to the architect.

Revisions		
A	06/10/14	General drawing revisions
B	08/10/14	Amendment to Staircase arrangement
C	07/11/14	Amendment to drawings generally
D	20/11/14	Amendment to drawings generally
E	24/11/14	Amendment to drawings generally
F	18/12/14	Amendment to drawings generally
G	07/01/15	Amendment to drawings generally
H	15/01/15	Submitted for Planning Application

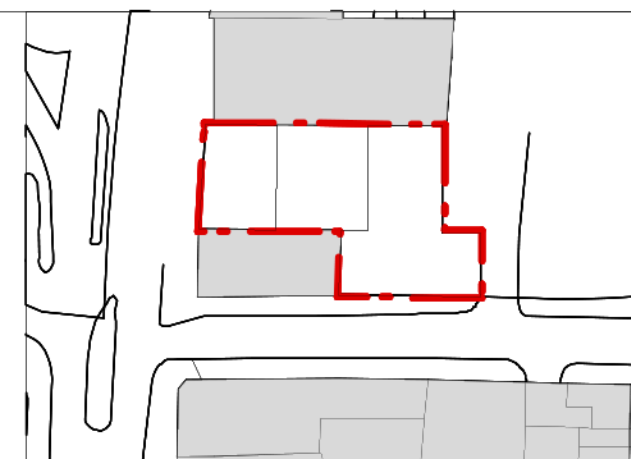

Client	SRE Haverstock Hill Ltd	
Project	Marine Ices Haverstock Hill, London, NW3 2BL	
Drawing Title	Proposed Second Floor General Arrangement	

	Twenty First Architecture Ltd, 314 Goswell Road, London, EC1V 7AF Tel: +44(0)20 7062 0262 www.21starchitecture.com		
	Status	Planning	Drawn JSP
	Scale	1:100 @ A1 1:200 @ A3	Checked TJS
	Drwg. No.	177_GA_02	Date Aug 2014
			Revision H