

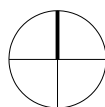

Site Location Plan - Existing 1:1250@A3

Ordnance Survey, (c) Crown Copyright 2019. All rights reserved. Licence number 100022432



SCALE @ 1:1250

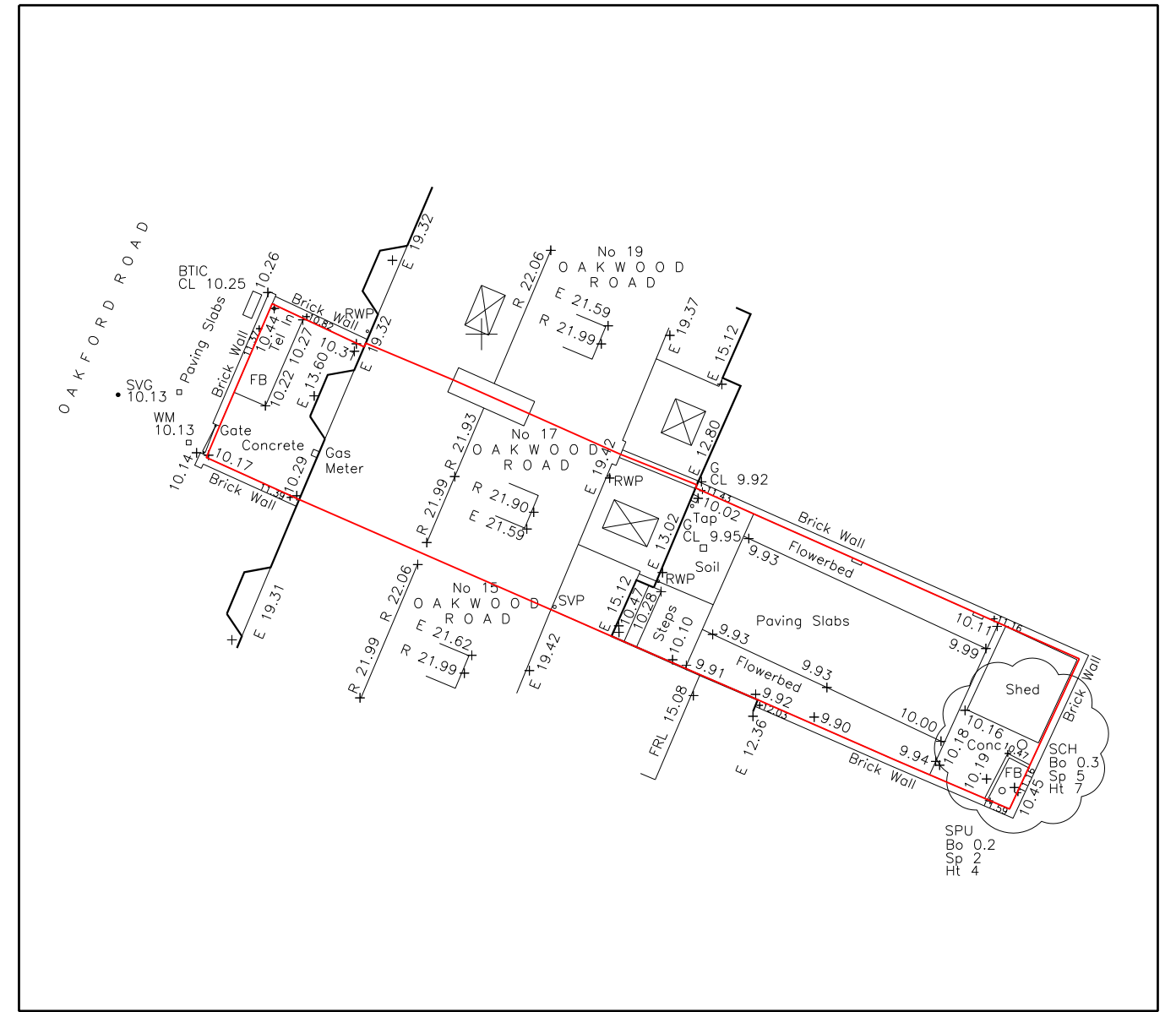

Block Plan / Topographical Survey - Existing 1:200@A3

Site Boundary

REV ~ - Lawful Development Submission - April 2020

<h1>BLOCK³ ARCHITECTS</h1> <p>CLEE VIEW, BAVENEY WOOD, NR KIDDERMINSTER, DY14 8JB T +44 (0)1299 270 436 E info@b3a.co.uk W www.b3a.co.uk</p>		<p>TITLE: O.R.L. 17 Oakford Road, Kentish Town, London Site Location and Block Plans - Existing</p>	
		<p>DRG. NO: L (90) 000</p> <p>DATE: April 2020</p>	<p>SCALE: 1:1250 @ A3</p> <p>REV: ~</p>