

PROPOSED CROSS SECTION A-A

1 : 50 @ @ A1 / 1:100 @ A3

Notes
 THIS DRAWING IS COPYRIGHT OF FORM.
 DO NOT SCALE FROM THIS DRAWING WORK ONLY TO FIGURED DIMENSIONS.
 THE CONTRACTOR IS TO VERIFY ALL DIMENSIONS ON SITE BEFORE COMMENCING WORK. ALL ERRORS AND OMISSIONS ARE TO BE REPORTED TO THE ENGINEER.
 THIS DRAWING IS TO BE READ IN CONJUNCTION WITH ALL RELEVANT ARCHITECTS, SERVICES ENGINEERS AND ENGINEERS DRAWINGS AND SPECIFICATIONS.

NOTE:
 AS AGREED WITH CONTRACTOR CAVITY DRAIN GULLEY IS TO BE PLACED ON TOP OF RETAINING WALL TOES. CONTRACTOR TO ADJUST LEVEL OF BASEMENT ACCORDINGLY

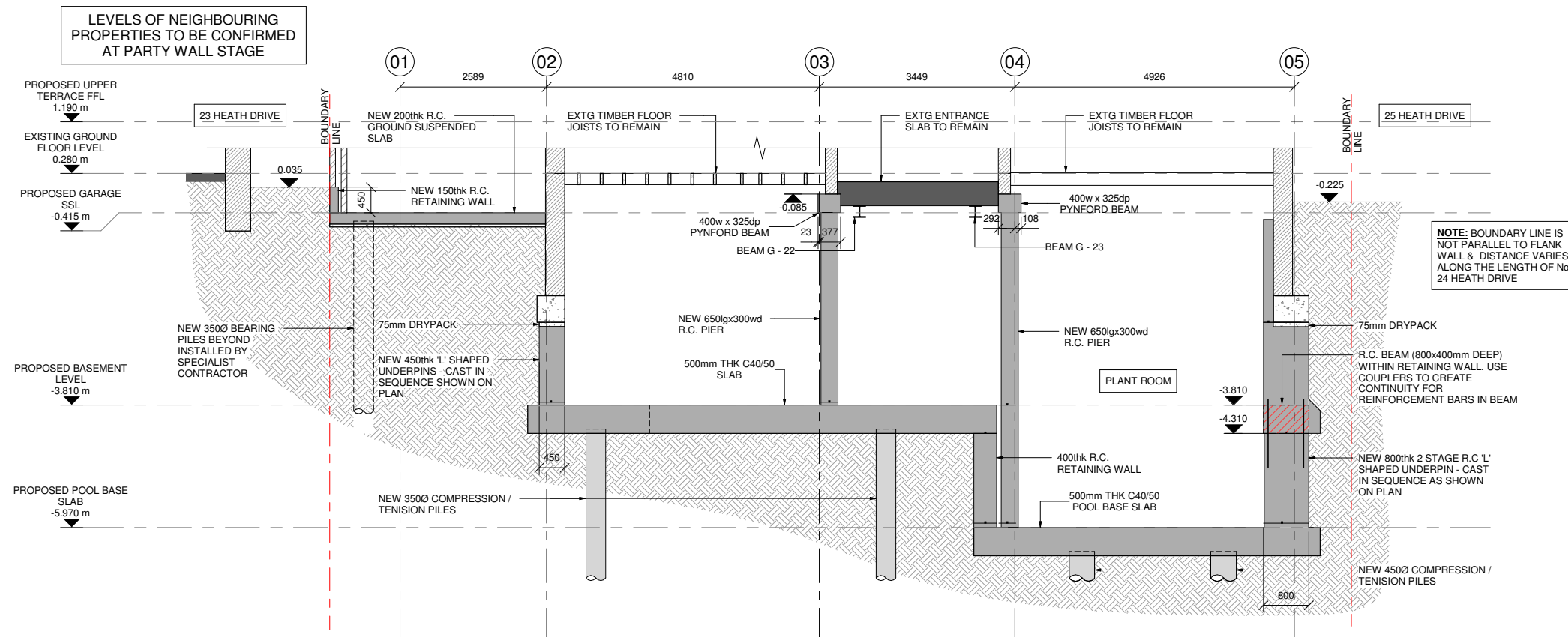

PROPOSED CROSS SECTION B-B

1 : 50 @ @ A1 / 1:100 @ A3

SEE TEMPORARY WORKS ENGINEERS DRAWINGS FOR SIZE OF TEMPORARY TOES & HEELS FOR ALL STAGE UNDERPINS

Rev.	Date	Amendment	Drawn	Chkd
C3	03.04.20	CONC. ENCASED BEAM ADDED	PE	ROM
C2	19.12.19	SLAB LOWERED	PE	ROM
C1	21.11.19	ISSUED FOR CONSTRUCTION	PE	BR
P4	12.08.19	REVISED TO SUIT COMMENTS	AON	ROM
P3	19.07.19	REVISED TO SUIT COMMENTS	PE	ROM
P2	15.02.19	REVISED TO SUIT NEW SCHEME	P.E	B.R
P1	25.01.19	ISSUED FOR PLANNING	P.E	ROM

Drawing Status **CONSTRUCTION**

Form

Job Title
**24 HEATH DRIVE
 LONDON
 NW3 7SB**

Drawing Title
PROPOSED CROSS SECTIONS A - A & B - B

Form Structural Design Ltd 77 St John Street London EC1M 4NN
 T:020 7253 2893 E:studio@form-sd.com W:www.form-sd.com

Date	Scale	Drawn	Checked
JAN 19	1 : 50	P.E	ROM
Job No. 162637	Drawing No. A(28)101	Revision C3	