

LEGEND



SITE BOUNDARY



EXTENT OF EXISTING BOUNDARY FENCE TO BE REPLACED WITH SOLID-FACED BRICK WALLS (RETAIN THE SAME FENCE HEIGHT AND CONTOUR) REFER DRAWINGS 00.102 & 20.130 TO 135 BRIDGING TO T2, T3 & T5 WHERE REQUIRED REFER TO P&M'S SK13, 14 & 15 REFER WAS' ARBORICULTURAL METHOD STATEMENT

NOTE 1

RE-GLAZE EXISTING GLAZINGS (WINDOWS AND EXTERNAL GLAZED DOORS) TO BE WITH "THIN" DOUBLE GLAZED UNITS. THE EXISTING FENESTRATIONS OF WINDOW AND DOORS TO BE RETAINED AND UNCHANGED REFER DRAWINGS 20.120 TO 129

- ① MODIFY EXISTING BATHROOM WALL
- ② RECONFIGURE EXISTING BATHROOM LAYOUT
- ③ MODIFY EXISTING STEPS & REPOSITION EXISTING DOOR OPENING (BEDROOM 5)
- ④ INSTALLATION OF A ROOFLIGHT (FLUSH)
- ⑤ CREATE A WALK-IN-PANTRY WITH A CONCEALED DOOR OFF THE RECESSED ALCOVE
- ⑥ REVISE KITCHEN WORKTOP TO INCORPORATE A DOUBLE-OVEN, PULL-OUT PANTRY AND A FULL HEIGHT FRIDGE/FREEZER
- ⑦ EXTEND EXISTING KITCHEN ISLAND TO INCLUDE AN EXTRA STORAGE AREA
- ⑧ OMITTED
- ⑨ OMITTED

WELL ROAD

5 WELL ROAD

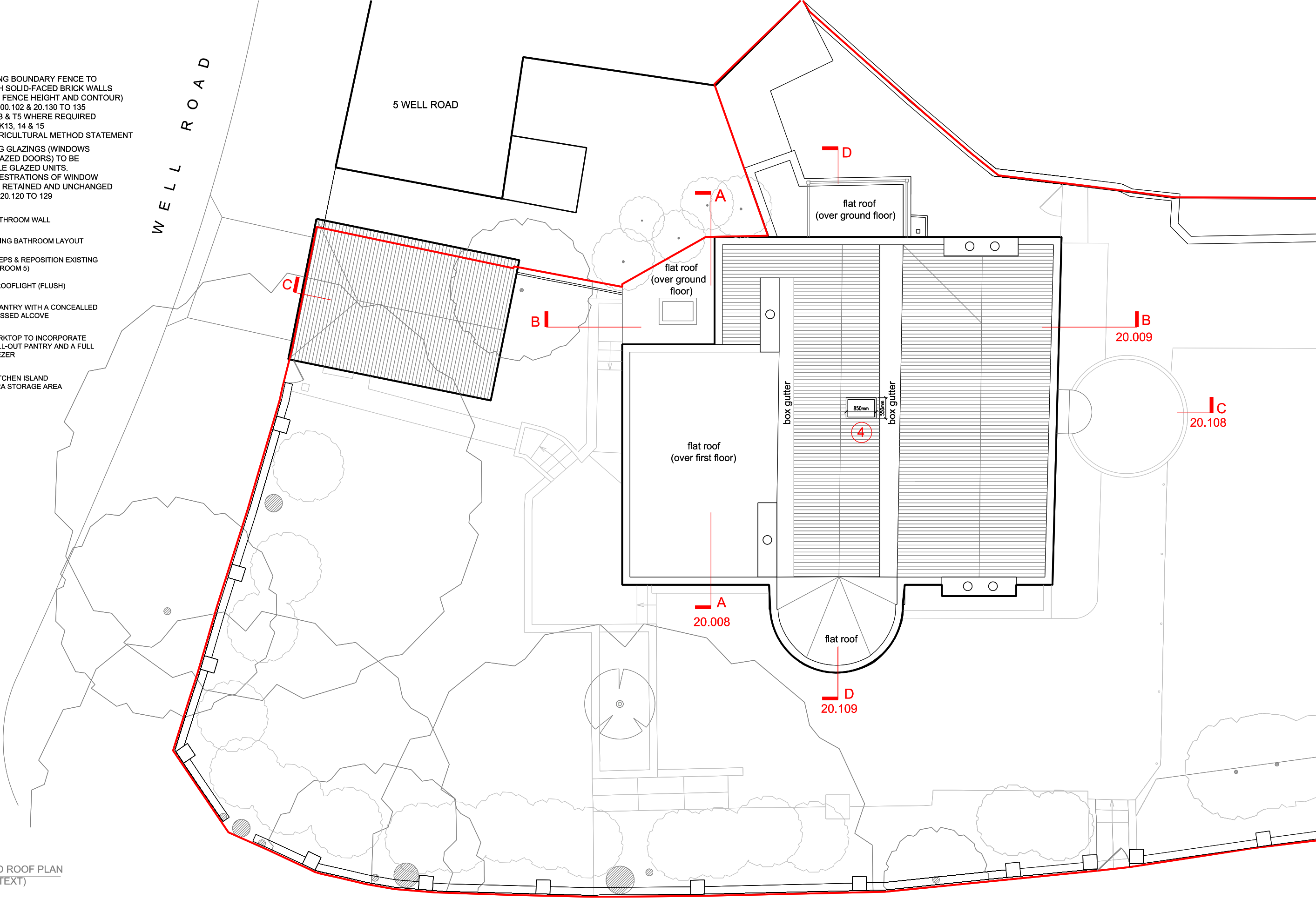

1 PROPOSED ROOF PLAN (SITE CONTEXT)

REVISION	DATE	DESCRIPTION
-	25.01.2018	ISSUED FOR INFORMATION
A	01.03.2018	ISSUED FOR PRE-PLANNING APPLICATION ADVICE - DRAFT
B	20.12.2019	ISSUED FOR PLANNING AND LISTED BUILDING CONSENT APPLICATIONS
C	06.04.2020	ISSUED FOR PLANNING AND LISTED BUILDING CONSENT APPLICATIONS - REVISED AS PER PLANNERS' COMMENTS: THE PROPOSED ROOFLIGHT RELOCATED AND REDUCED IN SIZE. LEGEND REVISED (ITEMS 8 & 9 OMITTED)

NOTES:  
 - THIS IS A "SCHEME LEVEL DRAWING" AND IS INTENDED TO ILLUSTRATE THE GENERAL ARRANGEMENT OF THE PROJECT PROPOSALS FOR THE PURPOSE OF PLANNING APPLICATION  
 - THIS DRAWING MUST NOT BE USED FOR CONSTRUCTION  
 - DO NOT SCALE FROM THIS DRAWING  
 - ALL DIMENSIONS MUST BE VERIFIED FROM SITE



CLIENT  
MR RON PASCALOVICI

PROJECT  
26 CHRISTCHURCH HILL  
LONDON NW3 1LG

TITLE  
PROPOSED ROOF FLOOR PLAN  
(WITH SITE CONTEXT)

DWG No  
1069.20.103\_C

1:50 @ A1  
SCALE 1:100 @ A3

**ERICA JONG ARCHITECTS**  
 ARCHITECTURE DESIGN MANAGEMENT

48 Fairhazel Gardens London NW6 3SJ  
 T [0]207 372 5768  
 E info@ericajongarchitects.com  
 www.ericajongarchitects.com