

**Glazed Light**  
As Proposed 1:20

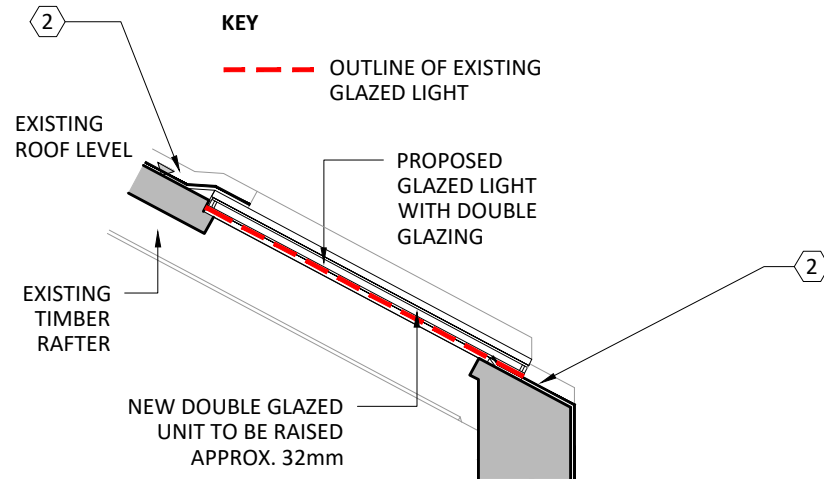

**Section A-A**  
As Proposed 1:20

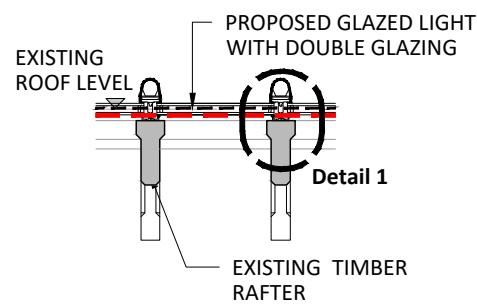

**Section B-B**  
As Proposed 1:20

- Notes:
1. New glazing to glazed light as The Standard Patent Glazing Company Rafterline aluminium glazing bar with double glazing and lead cloaked timber roll fixed to cap. Ref. UCL/08.
  2. REMOVE EXISTING PERIMETER LEAD AS REQUIRED TO ALLOW WORKS TO BE UNDERTAKEN. AS REQUIRED PROVIDE NEW LEAD COVERING TO CLAUSE H71/110

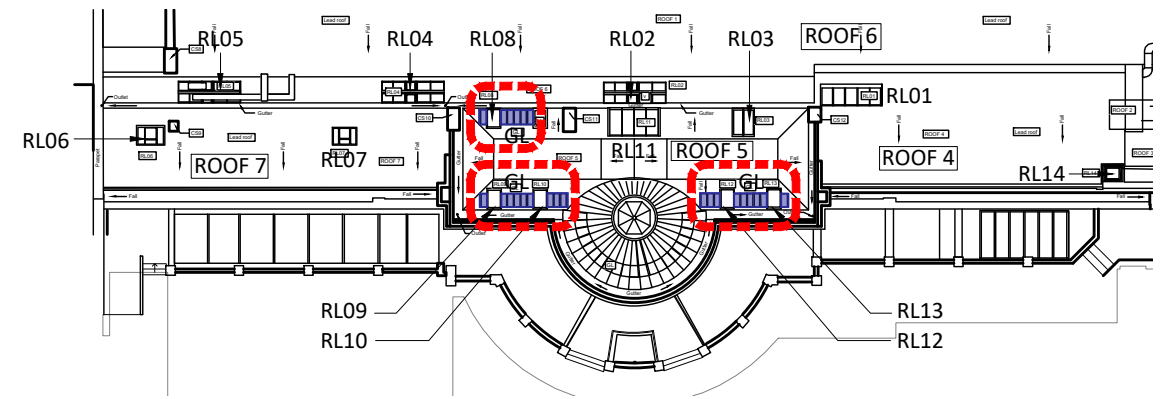

**Glazed Light Location Plan**  
As Existing

NTS

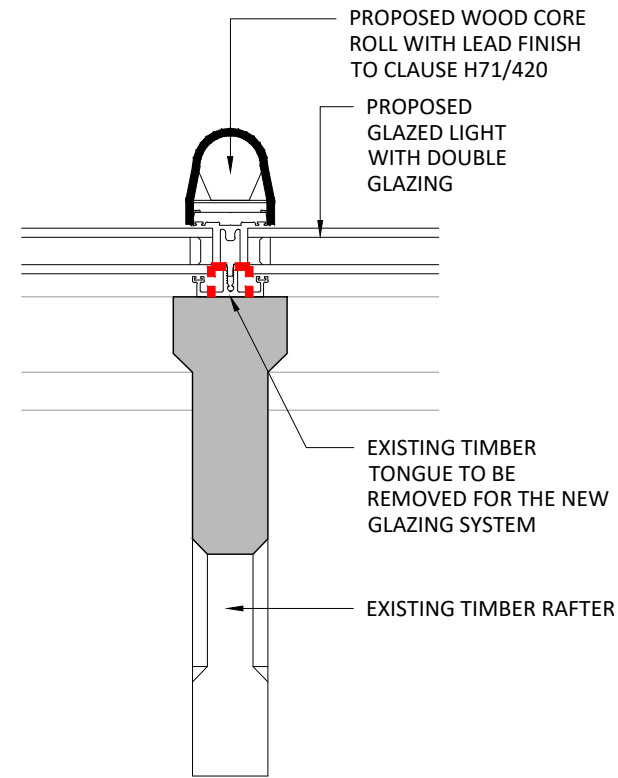

**Detail 1 - Typical Glazed Light Detail**  
As Proposed 1:5

rev.	description	date	chkd.
A	Rooflight details updated.	28 Feb 20	

client :  
UCL

project :  
The Slade School of Fine Art  
Gower St, London, WC1E 6BT  
External Refurbishment

drawing title :  
Glazed Light  
As Proposed

**FulkersBaileyRussell**  
london | gravesend | brighton | bristol | leeds | reading | manchester  
info@fulkers.co.uk // www.fulkers.co.uk // 01474 369175

drawn:SL chkd: date: Jan 2020

status: **Planning** scale: As shown

proj no: 19-2306

drg no: 200-17 rev no: A

