

- Notes:
1. New glazing as The Standard Patent Glazing Company No.7 'Heritage' lead covered steel glazing bar with double glazing. Ref. UCL/07 and UCL/04.

**Rooflight RL01**

As Proposed

1:20

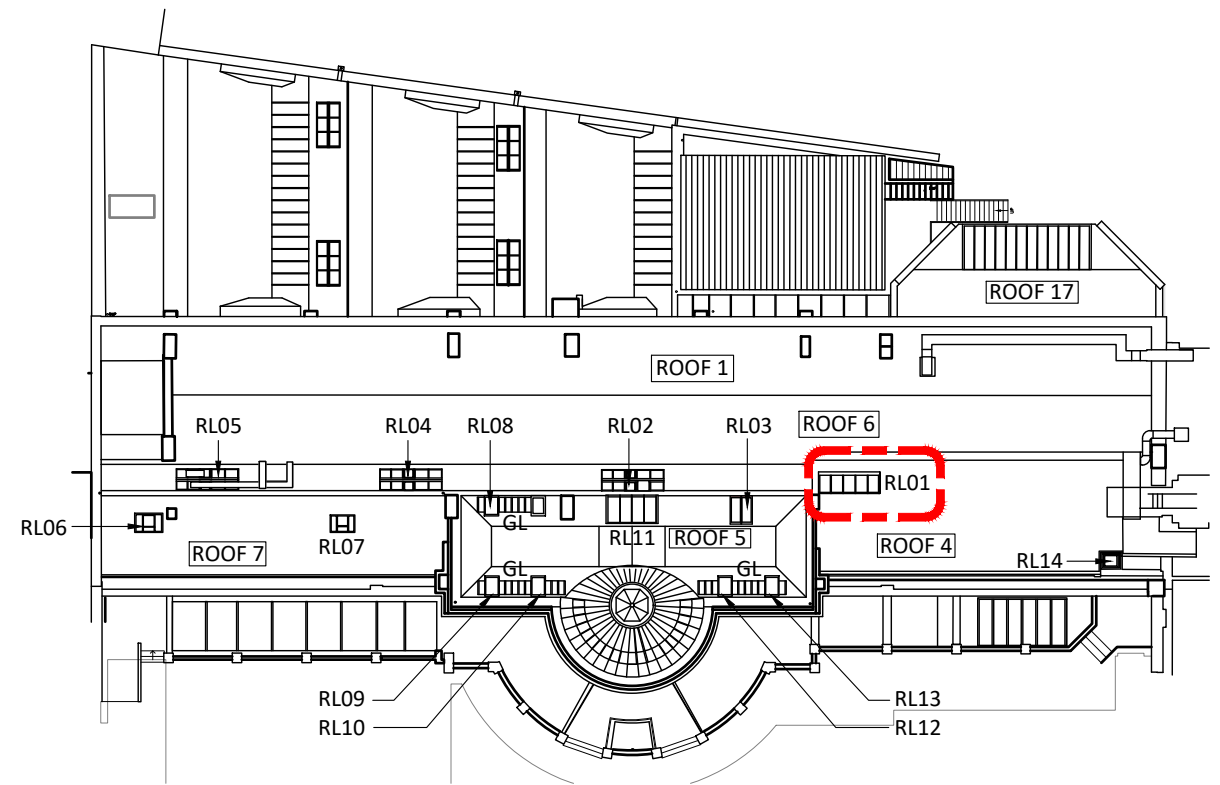

**Rooflight Location Plan**

NTS

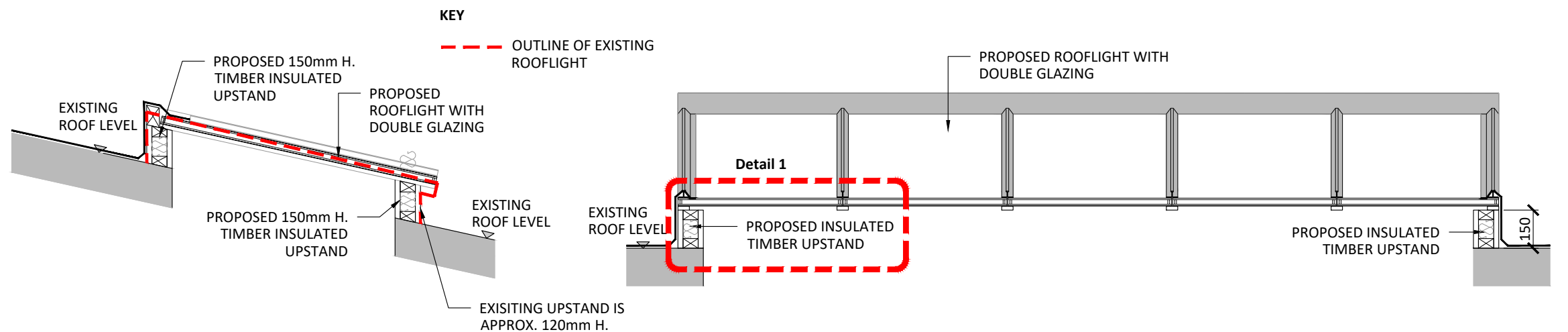

**Section A-A**

As Proposed

1:20

**Section B-B**

As Proposed

1:20

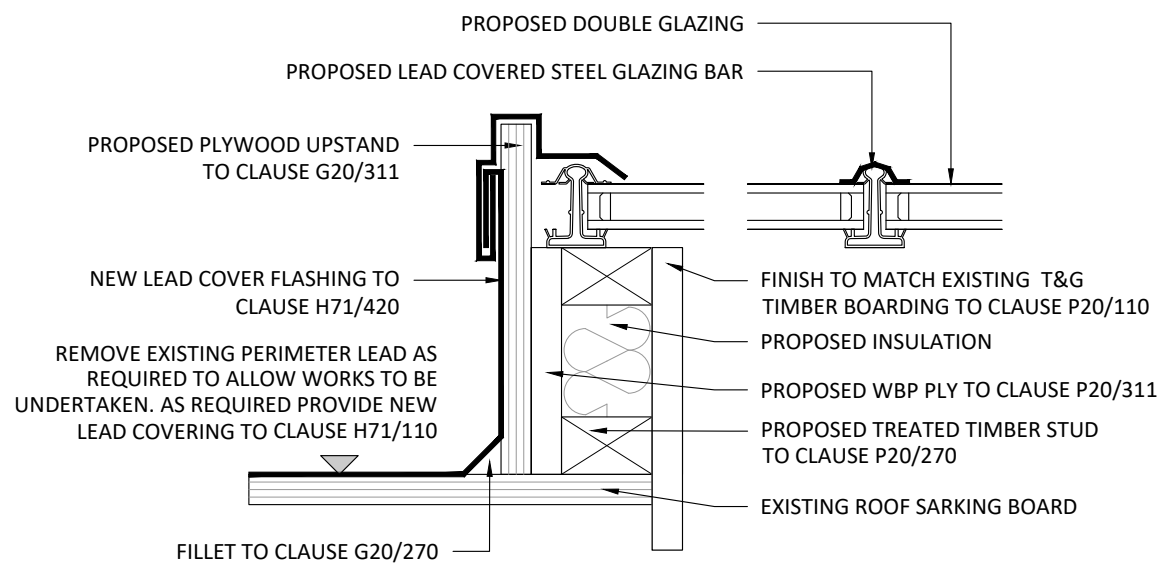

**Detail 1 - Typical Rooflight Detail**

As Proposed

1:5

- B Specification notes updated 09/03/20
- A Rooflight details updated. 28 Feb 20

rev.	description	date	chkd.

client : UCL

project : The Slade School of Fine Art  
Gower St, London, WC1E 6BT  
External Refurbishment

drawing title : Rooflight RL01  
As Proposed

**FulkersBaileyRussell**  
london | gravesend | brighton | bristol | leeds | reading | manchester  
info@fulkers.co.uk // www.fulkers.co.uk // 01474 369175

drawn:SL chkd: date: Jan 2020

status: **Planning** scale: As shown

proj no: 19-2306

drg no: 200-10 rev no: B

