

Aberdare Gardens

(No. 43)

(No. 41)

No. 39

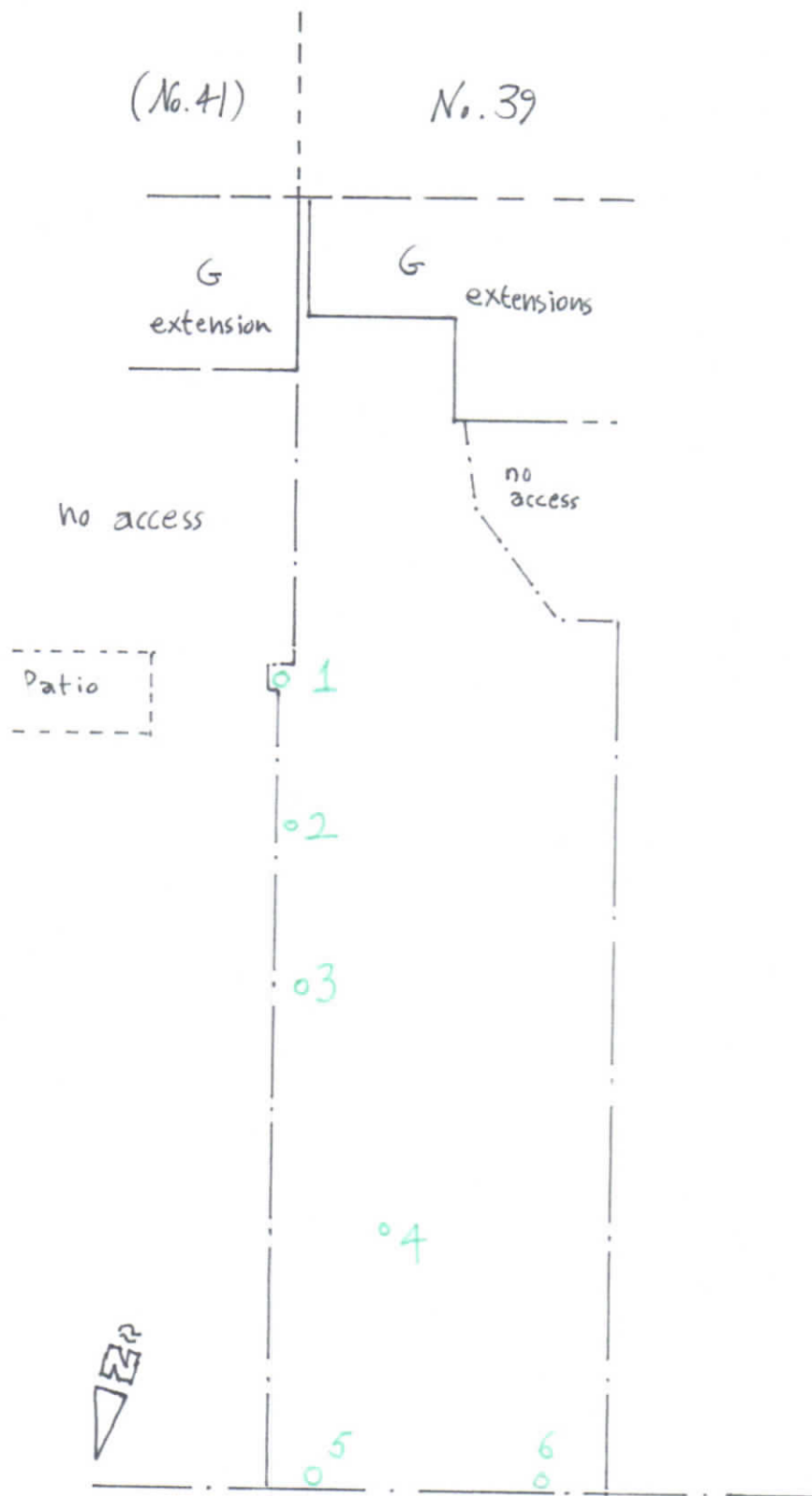

Trees at 39 Aberdare Gardens,
London, NW6 3AJ.
ref: 1-38-3647/P
drawn to scale 1:200@A4

The Old School
Tilley
HRS 1RN
21 Wheatley, Oxford
& Harpenden, Herts.

01582 808020
01544 231006

admin@treescan.co.uk

PHOTO



The green dashed line indicates the proposed pruning

SCHEDULE

Works to tree or trees at 39 Aberdare Gardens, London, NW6 3AJ.

Please read in conjunction with plan 1-38-3647/P appended.

Tree number	Tree type	Height	Stem diameters	Comments
1	false acacia	18	475	Reduce to a height of about 14m and commensurately in spread = to just outside/above the evident old reduction points.
5	common lime	17	400	Carry out a thorough crown clean
6	common lime	17	400	

NOTES:

All tree work should be carried out to BS 3998 : 2010 'Tree Work - Recommendations'. The Wildlife and Countryside Act 1981 protects with certain exceptions all birds and their nests. It is an offence to destroy such nests or take or injure such birds in the course of tree works operations. If a tree is a bat-roost, a licence to work on the tree must first be obtained from the relevant Statutory Nature Conservation Organization (in England : Natural England 0845 601 4523.) Acting without a licence is likely to be justifiable only in acute emergencies threatening human life and where all other legally available option such as footpath diversion, fencing and warning signs cannot be applied.

'Crown cleaning' – an umbrella term now covered by several separate sections in BS3998:2010 - should be understood to mean: removal of foreign objects (section 7.13),; removal of ivy to the extent needed to facilitate inspection (section 7.12), typically trimming back (e.g. with a hedge cutter or secateurs) to near the line of the trunk or branches, and/or removing selected stems so that the structure of the tree can be seen sufficiently. Dead wood can be an important ecological feature. Treatment of dead wood under 'crown cleaning' shall mean (section 7.3.2) shorten and retain if safe to do so, thus retaining some resource for invertebrates, etc.