

Removal and reinstatement of fall arrest system subject to specialist input / design.

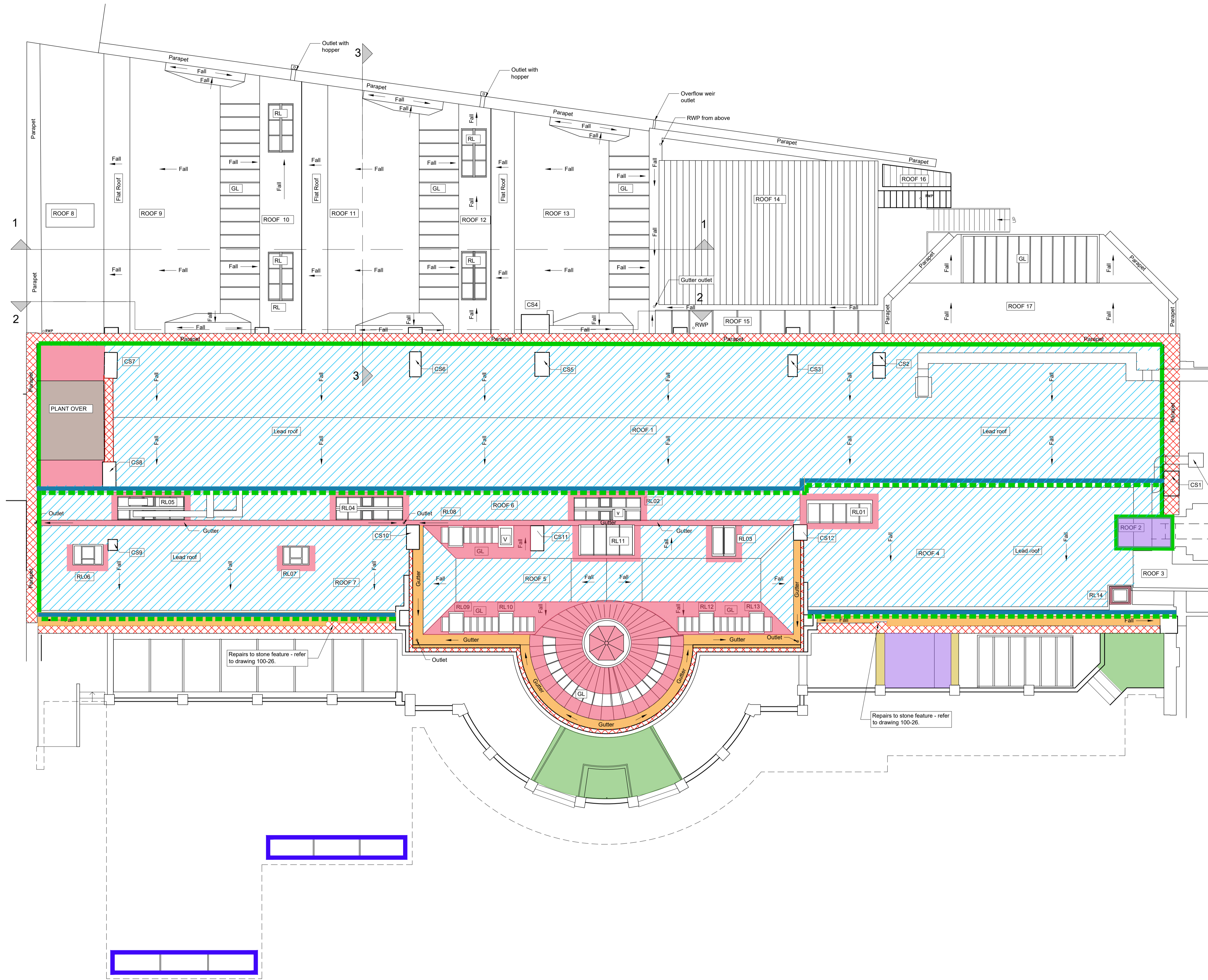
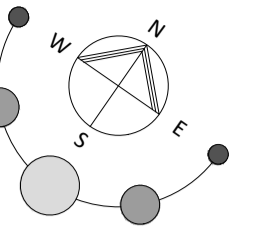

Legend

- Isolated lead welded repairs to lead where split and defective
- Localised lead replacement to section H71. Refer to drawings 200-10, 11, 12, 13, 14, 15, 16, 17 & 18.
- Remove existing flashing and refix to clause C41/820 in gauged mortar 1:1.6 or proprietary lead flexible sealant to clause Z22/310A, pointed to match existing. Replacement lead as Section H71.
- New lead flashing below replacement clerestory windows as Section H71
- Remove, repair, replace and re-commission plant on steel beams to allow replacement of defective roof below.
- Replace cast iron gutters and down pipes to clause R10/315 and R10/375, fixed to new timber fascia to clause P20/110. Decorate on completion to Section M60
- Take up and re-bed coping stones on new D.P.C and level bed of 1:1.6 gauged mortar. See item 3 for flashing repairs. Repoint stone coping in gauge 1:1.3:10-12 cement/stone dust/ lime/ sharp sand mortar to match existing. Repoint remaining brickwork to clause C41/810 with 1:1.6 gauged mortar to match existing.
- Provisional works. On inspection by structural engineer remove defective render and concrete to soffit and expose I beams. Treat metalwork as recommended by structural engineer and re-plate over to recommended specification. Localised stonework repairs and replacements to clause C41/240 and C41/245.
- Minor overhaul to copper roof to section H73
- New replacement glazing system to be Stalip Planidur system to replacement steel angle frame and verge flashing to extend to existing gutter / soakaway detail.
- Remove secret gutters and clear away. Replace timber sarking with WBP plywood to clause H71/630. Provide lead gutter linings to clause H71/200 complete with lead cover flashings to clause H71/450.
- Replace York stone copings with new to clause C41/240. Bedded and pointed on 1:1.6 gauged mortar.

KEY

- RL Rooflight
- GL Glazing
- V Vent
- CS11 Chimney stack (and ref number)

Existing redundant vent to be removed and cleared away from site & area made good upon removal.

Repairs to stone feature - refer to drawing 100-26.

Repairs to stone feature - refer to drawing 100-26.

D	North point added.	17.03.20
C	Specification clauses added.	09.03.20
B	Proposals for main roof revised.	28.02.20
A	Layout Updated	17.02.20

rev.	description	date	chkd.

client : UCL

project : The Slade School of Fine Art
Gower St, London, WC1E 6BT
External Refurbishment

drawing title : Roof Plan
Proposed Roof Repairs

FulkersBaileyRussell

london | gravesend | brighton | bristol | leeds | reading | manchester
info@fulkers.co.uk // www.fulkers.co.uk // 01474 369175

drawn: CK chkd: date: Jan 2020

status: **Planning** scale: 1:100 @ A1

proj no : 19-2306

drg no : 200-01 rev no: D

Roof Plan
Proposed Roof Repairs

1:100

