

9 Regents Park Terrace, London, NW1 7EE
[REDACTED]

MONITORING

LEVEL MONITORING

for Subsidence Management Services

9 Regents Park Terrace, London, NW1 7EE

Client: Subsidence Management Services

Client Contact: Martel Hawkins



Report Date: 6 January 2020



SubsNetuk

Level Monitoring Readings

The following table shows the reading levels of the various Level Monitoring Station points.

Date	1	2	3	4	5
09/01/2019	7.6612	9.1507	10.0000	9.1540	9.7077
18/03/2019	7.6621	9.1497	10.0000	9.1534	9.7064
05/06/2019	7.6634	9.1525	10.0000	9.1548	9.7079
19/08/2019	7.6631	9.1510	10.0000	9.1540	9.7073
29/10/2019	7.6637	9.1521	10.0000	9.1551	9.7077
23/12/2019	7.6629	9.1515	10.0000	9.1541	9.7076

Level Monitoring Difference Graphs

The following graphs display the progressive movement that each Level Monitoring Station recorded at each separate site visit date to give an overall look at how much the property is moving.



Level Monitoring Displacement Map

The following image shows an isometric representation of the movement of the property, based on the Level Monitoring Stations that were installed.

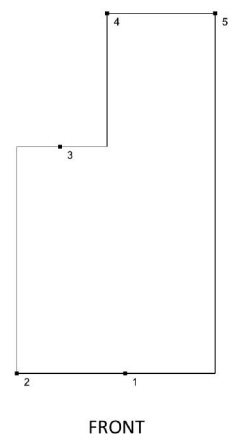
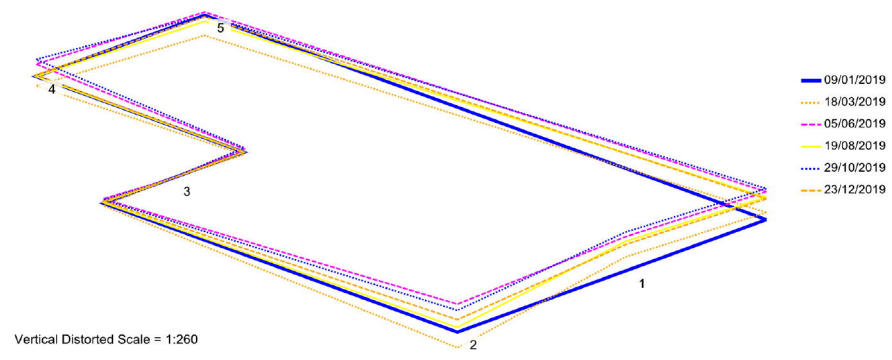

Site Visit Notes

Datum is level station 3, it has an assumed value of 10,000m. No suitable remote datum, so no secondary TBM available. If this is not suitable, please advise if a deep datum is required.

Site Visit: 9 January 2019

Cant see through house as house is like a maze & large drop to rear. Have had to do 2 separate surveys. May need a deep datum to rear. Relative survey.