

## Key

- AHU** Office fresh air supply & extract air handling unit. Length - 9m, Width - 4m, Height - 3m
- GEN** Office back-up electrical generator. Length - 5m, Width - 2m, Height - 2.5m
- VRF** Office variable refrigerant flow external air cooled condenser. Provides heating and cooling to the office areas. 1 no. per office tenancy. Width - 2m, Depth - 1m, Height - 2m
- WC** Toilet extract air handling unit. Length - 6m, Width - 1m, Height - 2.7m
- SAT** Future tenant satellites. Height - 2m
- FT** Future tenant refrigerant external air cooled condenser. 1 no. per floor. Width - 1m, Depth - 0.5m, Height - 1m
- A8** Future gym tenant plant area.
- Primary core risers (below plant support deck. Access required)
- Ductwork to/from plant and risers
- Plant access

- Plant
- Terrace
- Green roof
- Riser

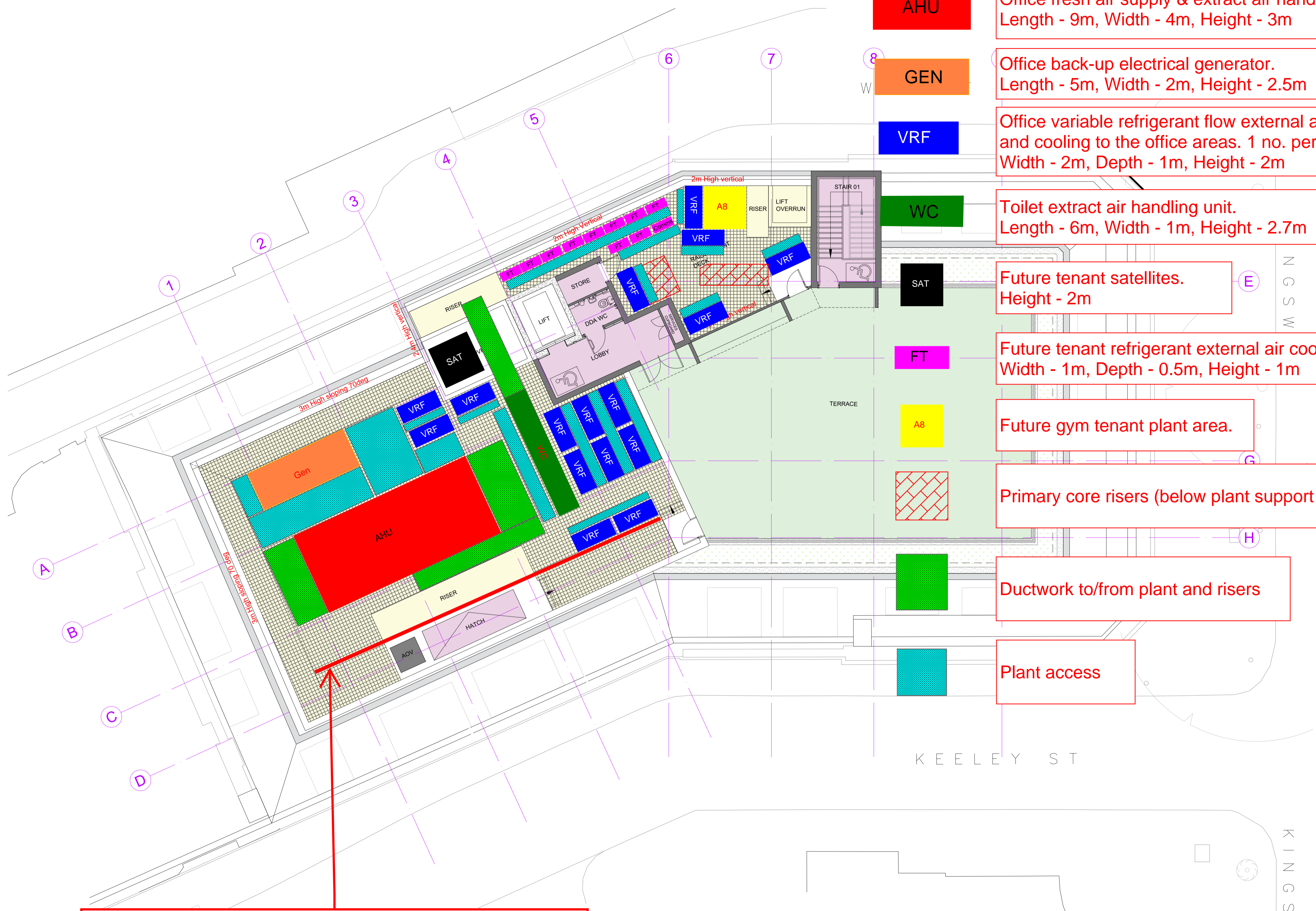

Indicative adjusted Keeley Street Plant Screen

**4541 - 65 Kingsway**  
**Base Scheme Updated Roof Plant Layout**  
**Planning Update**  
**WPP / JB**  
**13.03.2020**

01 Proposed Roof Plan  
 20.211 1:100@A1, 1:200@A3

Absailing requirement TBC by Ashdown Phillips

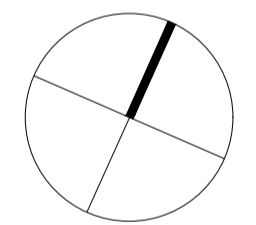

**DRAFT**

Rev.	Description	By	Date
----	T1 Issued for Tender	AC	06.03.20

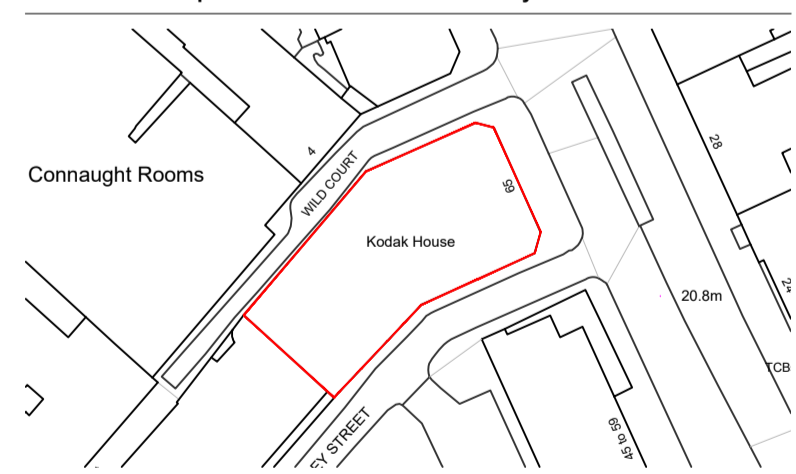

Client  
Kings Keeley Limited C/o Clearbell Capital LLP

Project  
65 Kingsway - Base Scheme

Title  
Proposed Roof Plan

Status	Purpose of Issue	RIBA stage
D2	For Stage 3	3

Project No.	Drawn	Checked	Scale	Rev.
1914	FB	TJ	1:100 @ A1 1:200 @ A3	----

Drawing No.  
**1914-BG-01-R1-DR-A-20.210**

Do not scale from this drawing. The Contractor is to take and check all dimensions on site before work commences. Discrepancies must be reported to the Architect. Subcontractors must verify all dimensions on site before making a shop drawing or commencing manufacturing. This drawing is copyright. ©

© Copyright Barr Gazetas Ltd.  
 A 10 Heddon Street, London, W1B 4BG  
 T 0207 638 5981  
 W www.barrgazetas.com