

**LEGEND**

- AREA OUTSIDE SCOPE OF WORKS, EXCEPT FOR MAKING GOOD WHERE DISTURBED
- INTERNAL STRIP-OUT AND DEMOLITIONS**
- CAREFULLY REMOVE NON LOAD-BEARING WALLS, DOORS, FRAMES, GLAZED PARTITIONS, WALL LININGS, ALL ASSOCIATED FIXINGS, ETC. TO UNDERSIDE OF STRUCTURAL SLAB / SOFFIT / BEAM / COLUMN. MAKE GOOD ALL ABUTMENTS AND JUNCTIONS INCLUDING AT FLOOR, WALL, SOFFIT AND CEILING, AS APPROPRIATE.
- CAREFULLY REMOVE ALL FLOOR FINISHES AND SUSPENDED CEILINGS; TO INCLUDE ALL SKIRTINGS, UNDERLAY. MAKE GOOD ALL ABUTMENTS AS APPROPRIATE. ALL RAISED FLOOR PANS / TILES WITH FLOORBOXES TO BE REMOVED.
- CAREFULLY REMOVE COUNTERTOPS BASE AND WALL UNITS, SHUTTERS, APPLIANCES, ETC. MAKE GOOD ALL ABUTMENTS, AS APPROPRIATE.
- CAREFULLY REMOVE ALL WINDOW CILLS, RADIATORS, BACKBOARDS, SECONDARY GLAZING, BLINDS, CURTAINS & ANY MISCELLANEOUS.
- CAREFULLY REMOVE EXISTING EDGE PROTECTION.
- CAREFULLY FORM NEW OPENING IN EXISTING SLAB FOR SERVICES PENETRATIONS, REFER TO M&E CONSULTANTS DRAWINGS FOR SIZES. REFER TO STRUCTURAL ENGINEERS FOR DETAILS OF OPENING WORKS
- CAREFULLY FORM NEW OPENING IN WALL
- CAREFULLY FORM NEW OPENING IN WALL AT HIGH LEVEL ABOVE FALSE CEILINGS
- CAREFULLY REMOVE EXISTING SKIRTING AND NOSING TO STAIRS. EXISTING FLOOR FINISH RETAINED.
- NEW W800xH200mm HOLE TO BE FORMED ABOVE DOORSET
- CAREFULLY REMOVE EXISTING FINISHES FROM HANDRAILS, BRACKETS, FIXINGS AND BALUSTRADES AND PREPARE READY FOR REDECORATION.
- PTS - PENETRATION THROUGH SLAB
- PTW - PENETRATION THROUGH WALL

**SERVICES STRIP-OUT AND DEMOLITIONS**

CAREFULLY REMOVE ALL REDUNDANT SERVICES TO M&E STRIP-OUT SCOPE. MAKE GOOD ALL SURFACES FOLLOWING STRIP-OUT INCLUDING INFILLING, FIRE-STOPPING, CAPPING, FINISHING, RE-WATERPROOFING, RE-INSULATING AND RE-CLADDING, ANY PENETRATIONS IN THE SLAB AND THE EXTERIOR WALL AS APPROPRIATE.

FOR CAPPING / TERMINATION DETAILS TO ANY SERVICES REMOVED OR RELOCATED AS A RESULT OF STRIP-OUT WORKS, REFER TO M&E CONSULTANTS DRAWINGS / SPECIFICATION

**GENERAL NOTES**

ALL FF&E & FURNITURE, AND ALL WALL MOUNTED ITEMS ARE TO BE CAREFULLY REMOVED AND DISPOSED OF IN ACCORDANCE WITH UCL REQUIREMENTS

**ALL STRIP-OUT, DEMOLITION AND REMOVAL OF ASBESTOS-CONTAINING MATERIALS ARE TO BE CAREFULLY UNDERTAKEN AND CERTIFIED PRIOR TO ALL OTHER STRIP-OUT AND DEMOLITION WORKS.**

ALLOW FOR MAKING GOOD ALL WALLS, FLOORS AND SURFACES DAMAGED DURING STRIP-OUT WORKS. INCLUDE FOR INFILLING, FIRE-STOPPING, CAPPING, FINISHING, RE-WATERPROOFING, RE-INSULATING AND RE-CLADDING, ANY PENETRATIONS IN WALLS, SLAB AND THE EXTERIOR WALLS AS APPROPRIATE.

DEMOLITIONS CONTRACTOR TO PROTECT ALL LISTED FEATURES DURING STRIP-OUT.

CONTRACTOR / DEMOLITIONS CONTRACTOR TO PROVIDE DUST PROOF HOARDING AROUND SITE OF WORKS AS APPROPRIATE

DEMOLITION CONTRACTOR TO ALLOW FOR SCRABBLING / LEVELING / LINING OF SURFACES, AS APPROPRIATE FOLLOWING STRIP-OUT AND DEMOLITION WORKS.

DEMOLITIONS CONTRACTOR TO CONSULT STRUCTURAL ENGINEER PRIOR TO UNDERTAKING ANY DEMOLITIONS WORKS TO (INCLUDING FORMING ANY PENETRATIONS THROUGH) EXISTING LOAD BEARING ELEMENTS.

ALL WORKS - INCLUDING DESIGN, SETTING-OUT, DETAILING, FIXTURES, FITTINGS AND FINISHES - ARE TO MATCH PHASE 1A & 1B WORKS, UNLESS AGREED OTHERWISE.

DRAWING TO BE READ IN CONJUNCTION WITH ALL CURRENT, AND RELEVANT, ARCHITON DRAWINGS, SCHEDULES AND SPECIFICATIONS.

ALL WORKS TO BE FULLY COORDINATED WITH M&E AND STRUCTURAL PROPOSALS, AS APPROPRIATE.

ALL SETTING-OUT INFORMATION TO BE CHECKED AGAINST SITE DIMENSIONS.

ALL WORKS TO BE IN ACCORDANCE WITH ALL STATUTORY REQUIREMENTS. WHERE AMENDED PROPOSALS DIFFER FROM THOSE APPROVED BY LA, NEW APPROVALS TO BE OBTAINED PRIOR TO COMMENCING WORKS.

FIRE RATED COMPONENTS TO BE IN ACCORDANCE WITH OVER-ARCHING FIRE STRATEGY FOR THE IOE.

ACOUSTIC RATED COMPONENTS TO BE IN ACCORDANCE WITH ACOUSTIC STRATEGY PREPARED BY BURO HAPPHOLD.

**ENSURE NO STRIP OUT, DEMOLITION OR BUILDING WORKS ARE UNDERTAKEN WITHOUT THE REQUIRED LISTED BUILDING AND PLANNING CONSENTS FROM THE LOCAL AUTHORITY AND ENGLISH HERITAGE.**

DRAWINGS ARE BASED ON INFORMATION PROVIDED BY UCL.

- DRAWINGS TO BE READ IN CONJUNCTION WITH:-
- ARCHITECTURAL DRAWINGS, SCHEDULES AND SPECIFICATIONS.
  - STRUCTURAL DRAWINGS AND SPECIFICATIONS.
  - M&E DRAWINGS AND SPECIFICATIONS.
  - ACOUSTIC REPORTS.
  - FIRE STRATEGY.

ALL WORKS TO BE FULLY CO-ORDINATED WITH MEP / STRUCTURAL PROPOSALS, AS APPROPRIATE.

ALL SETTING-OUT INFORMATION TO BE CHECKED AGAINST SITE DIMENSIONS

ALL WORKS TO BE IN ACCORDANCE WITH ALL STATUTORY REQUIREMENTS. WHERE AMENDED PROPOSALS DIFFER FROM THOSE APPROVED BY LA, NEW APPROVALS TO BE OBTAINED PRIOR TO COMMENCING WORKS.

FIRE RATED COMPONENTS TO BE IN ACCORDANCE WITH OVER-ARCHING FIRE STRATEGY FOR THE IOE.

ACOUSTIC RATED COMPONENTS TO BE IN ACCORDANCE WITH ACOUSTIC STRATEGY - PREPARED BY B.H.

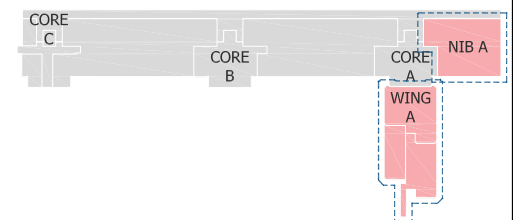

**1 LEVEL 9 - KEY PLAN**  
FOR REFERENCE NTS

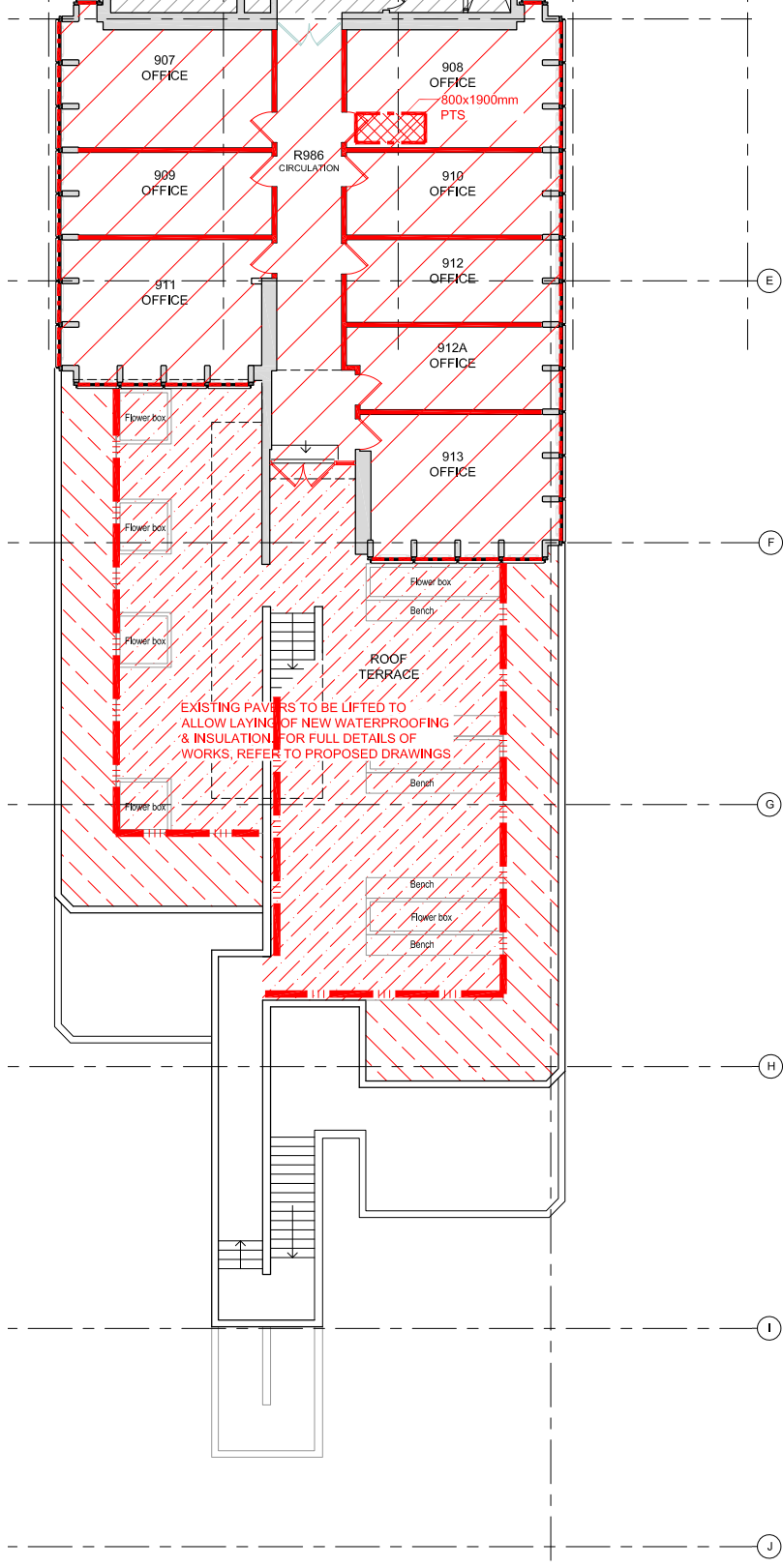

**2 LEVEL 9 - NIB A / WING A**  
DEMOLITION PLAN 1:100

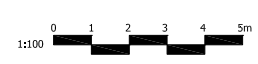

D	ISSUED FOR PLANNING	20.03.2020
C	PRELIMINARY ISSUE - FOR COMMENT	06.03.2020
B	Minor amendments incorporated	18.02.2020
A	Issued For Comments	17.02.2020
Rev	Description	Date

**overbury** Client

Job title  
University College London  
Institute of Education  
Phase 2  
20 Bedford Way, WC1H 0AL

Drawing title Level 9 Nib A & Wing A Demolition Plan Planning Application 2		
Scale 1:100 @ A1	Date Mar 20	Drawn IL

**ARCHITON LLP**  
CHARTERED ARCHITECTS - DESIGN  
PLANNING CONSULTANTS - DEVELOPMENT  
BUILDING COST MANAGEMENT

REGENCY HOUSE  
17 WEST STREET  
EPSOM KT18 7RL  
Email: info@architon.com

TEL: 01372 745600  
FAX: 01372 745016

Drawing No 3147-P2-2902 D	ARCHITON LLP certified to: BS EN ISO 9001 BS EN ISO 14001 IIP Accreditation
------------------------------	-----------------------------------------------------------------------------------------