

REV	DATE	KEY
P01	21/07/17	Issue for Planning
P02	30/11/17	Revised Issue for Planning with amendments
P03	02/03/18	Revised Issue for Planning with amendments
P04	25/02/20	Revised Issue for Planning with minor amendments
P05	13/03/20	Revised Issue for Planning with minor amendments

CONSULTANTS	
CLIENT:	WESTBROOK PARTNERS/ 1921 Mortimer Investments Limited
STRUCTURAL ENGINEER:	HEYNE TILLET STEEL
MECHANICAL ENGINEER:	THORNTON REYNOLDS
COST CONSULTANT:	LESLIE CLARK
PROJECT MANAGER:	RADCLIFFES CC
FIRE ENGINEER:	AFFINITY FIRE
APPROVED INSPECTOR:	BRCS
PLANNING CONSULTANT:	DP9
DAY LIGHT/ SUNLIGHT:	POINT 2 SURVEYORS
PARTY WALL CONSULTANT:	POINT 2 SURVEYORS
RESIDENTIAL ARCHITECT	COVE BURGESS

NOTE	
1.	Do not scale from this drawing.
2.	All dimensions to be checked on site by the contractor and such dimensions to be his responsibility.
3.	Report all drawing errors, omissions and discrepancies to the architect.
4.	This document may be issued in an uncontrolled CAD format to enable others to use it as background information to make alterations and/or additions. In that instance the file will be accompanied by a PDF version. It is for those making such alterations and additions to ensure that they make use of current background information.
AHMM Ltd accepts no liability for any such alterations or additions to the background information or arising out of changes to background information which occur prior to alterations of additions being made.	

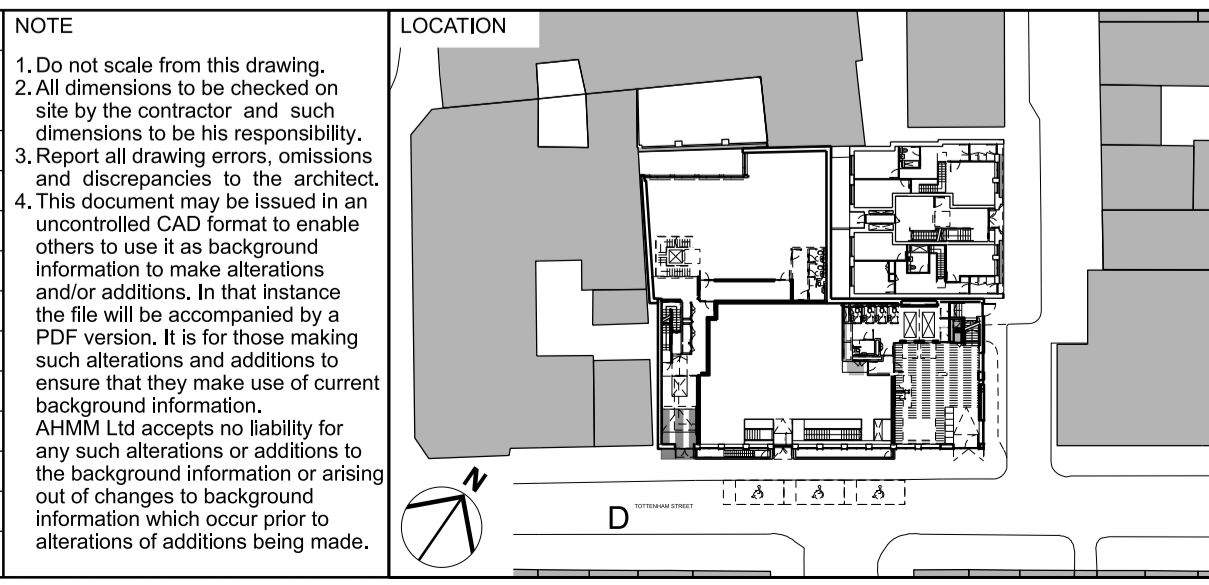

ALLFORD HALL MONAGHAN MORRIS
 ARCHITECTS Ltd
 MORELANDS, 5-23 OLD STREET LONDON EC1V 9HL
 TEL 020 7251 5261 FAX 020 7251 5123 WEB WWW.AHMM.CO.UK

job title
ARTHUR STANLEY HOUSE

drawing title / location
**PROPOSED GA ELEVATION
 WEST ELEVATION**

drawn by	checked	scale	status
LV	GH	1:100@A1; 1:200@A3	PLANNING

project	zone	source	classification	drawing no.	revision
15068				(00)_P204	P05