

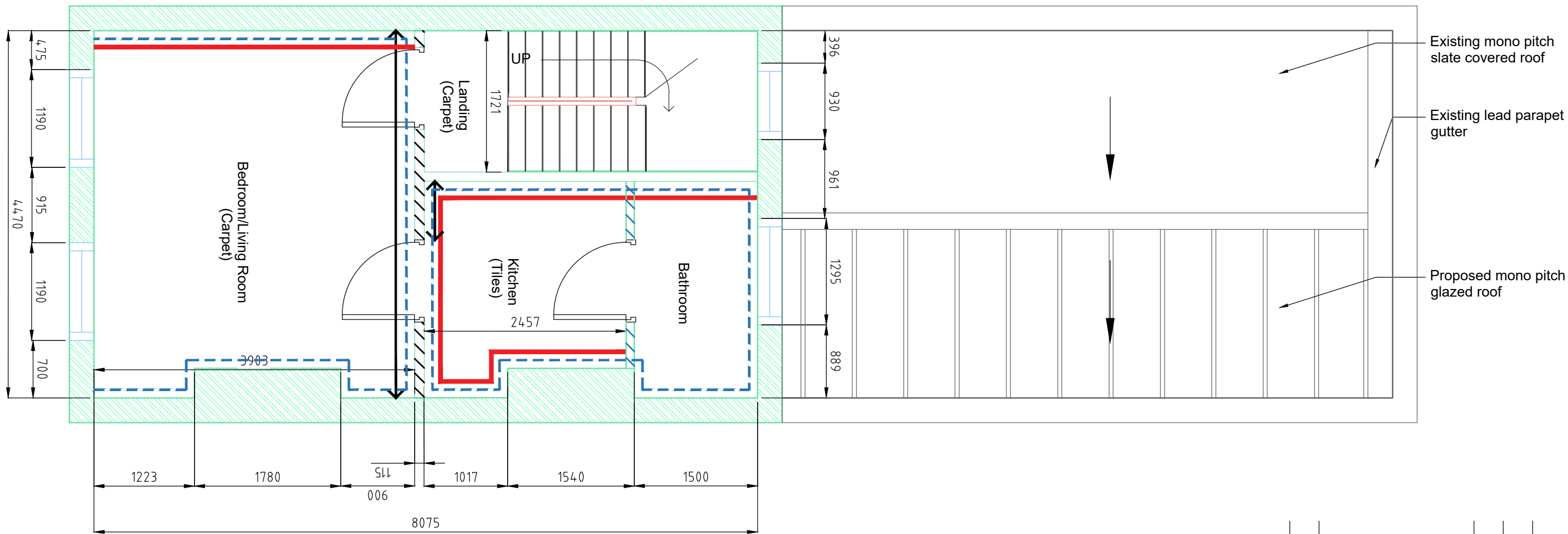

Do not scale this drawing. All Dimensions must be checked on site. This drawing and all details contained hereon are copyright and must not be reproduced without written permission from Property Tectonics.

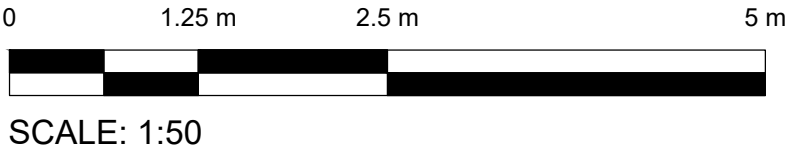

- Existing Timber Picture Rail
- Existing Moulded plaster Cornice
- Missing Lath and Plaster
- Timber Lath and Plaster Partition
- Existing Timber Stud Partition to be demolished

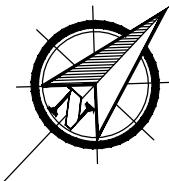

A	Timber stud to be demolished	JN	/	27.02.2020
REV	DESCRIPTION	AUTH	APP	DATE



**Hatfield**  
2nd Floor Titan Court, 3 Bishop Square  
Hatfield, AL10 9NA  
Telephone: 01707 243408  
Email: Hatfield@Property-Tectonics.co.uk

**JOB TITLE**  
250 Grays Inn Road  
London  
WC1X 8JR

**DRAWING TITLE**  
Existing First Floor  
General Arrangement Plan

DATE 13.03.19	DRAWN RZ
SCALE 1:50 @ A3	CHECKED
DRAWING NUMBER <b>J9648-002</b>	REVISION <b>A</b>