

2). CONTRACTOR IS TO REFER TO THE ENGINEER'S DRAWINGS BEFORE PROCEEDING WITH WORKS.
3). ALL DRAWINGS AND DESIGNS ARE COVERED BY DESIGN RIGHT (INTELLECTUAL PROPERTY) AND MAY NOT BE DISTRIBUTED, COPIED OR ISSUED WITHOUT WRITTEN PERMISSION OF THE ARCHITECT.
4). ALL DESIGN CONCEPTS CONTAINED ON THIS DRAWING ARE THE SOLE PROPERTY OF THE ARCHITECT AND NO ADAPTIONS, REPRODUCTIONS OR COPIES MAY BE MADE WITHOUT WRITTEN PERMISSION OF THE ARCHITECT.
5). THESE DRAWINGS MAY BE SUBJECT REVISION FOR THE PROPER CARRYING OUT OF THE WORKS.
6). LOCAL AUTHORITY AND STATUTORY REQUIREMENTS MAY OVERRIDE THESE DRAWINGS AND AMENDMENTS MAY BE REQUIRED.
7). SAMPLES OF MATERIALS WILL BE REQUIRED TO BE SUPPLIED BY THE CONTRACTOR. THE CONTRACTOR SHALL NOT RELY SOLELY OF THE WRITTEN DESCRIPTION CONTAINED WITHIN THE WORDING ON THESE DRAWINGS.
8). ALL FINISHES SHALL BE TO THE ARCHITECTS SATISFACTION.
9). ALL CRITICAL DIMENSIONS SHALL BE APPROVED BY THE ARCHITECT BEFORE CONSTRUCTION.
10). ANY DISCREPANCY BETWEEN THIS DRAWING AND ON-SITE DIMENSION SHALL BE REFERRED TO THE ARCHITECT FOR CLARIFICATION AND INSTRUCTION BEFORE WORKS ON THAT PART SHALL COMMENCE. REVISIONS

NO	DATE	DESCRIPTION	B
----	------	-------------	---

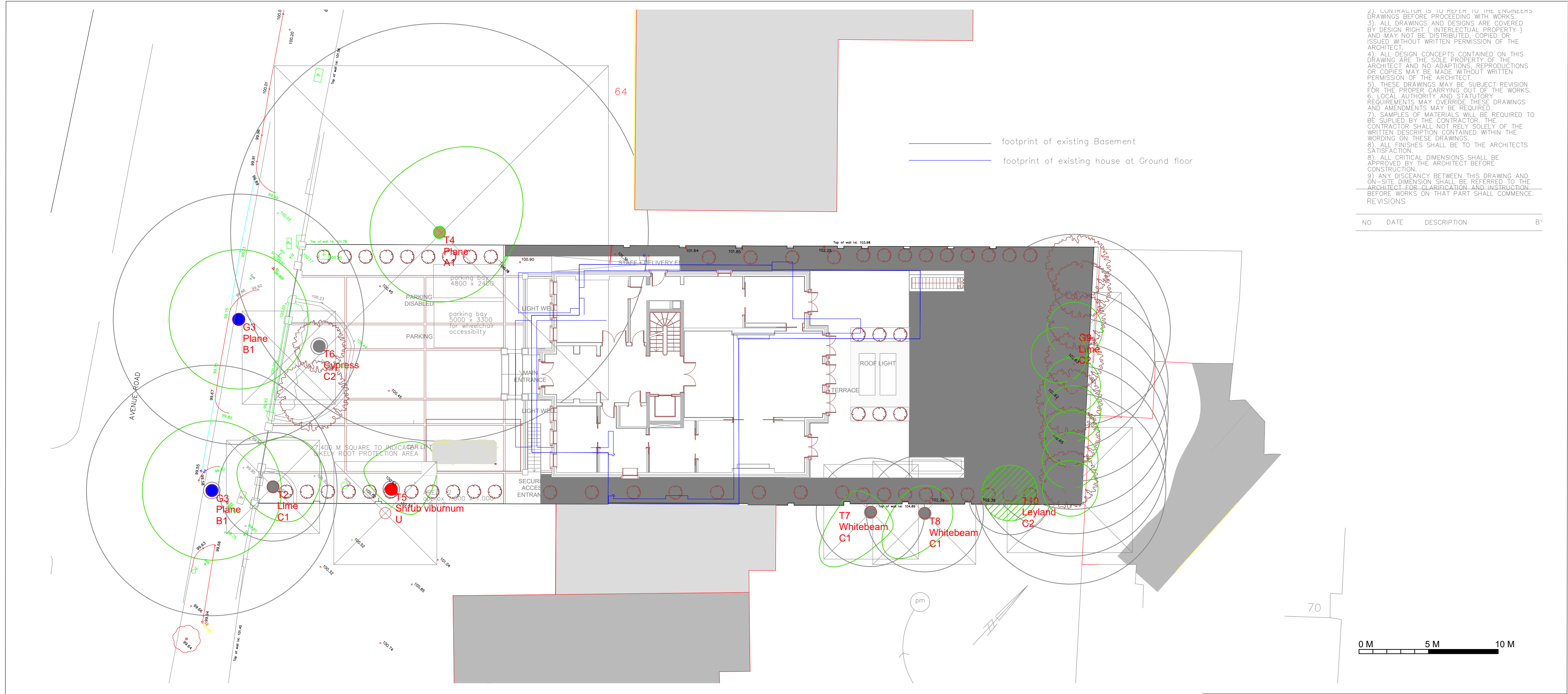

NOTE:
This survey is of a preliminary nature. The trees were inspected from the ground only on the basis of the Visual Tree Assessment method. No samples were taken for analysis. No decay detection equipment was employed. The survey does not cover the arrangements that may be required in connection with the laying or removal of underground services.

Branch spread in metres is taken at the four cardinal points to derive an accurate representation of the crown.

Root Protection Areas (RPA) are derived from stem diameter measured at 1.5 m above adjacent ground level (taken on sloping ground on the upslope side of the tree base).



Landmark Trees
20 Broadwick Street, London, W1F 8HT
Tel: 0207 851 4544 Mobile: 07812 989928
e-mail: info@landmarktrees.co.uk Web: www.landmarktrees.co.uk

Site: 62 Avenue Road	1:200@ A2
Drawing Title: Tree Constraints Plan	May 2019

Key:

- Category A High Quality
- Category B Moderate Quality
- Category C Low Quality
- Category U Trees Unsuitable for Retention

Category

Root Protection Area

Crown Spread

Tree Number

Species

Category

Tree Position Approximate (not shown on original survey)