

1 Front (NW) Elevation

01 - Existing - 1 to 50

2 Side (NE) Elevation

01 - Existing - 1 to 50

3 Front (NW) Elevation

01 - Proposed - 1 to 50

4 Side (NE) Elevation

01 - Proposed - 1 to 50

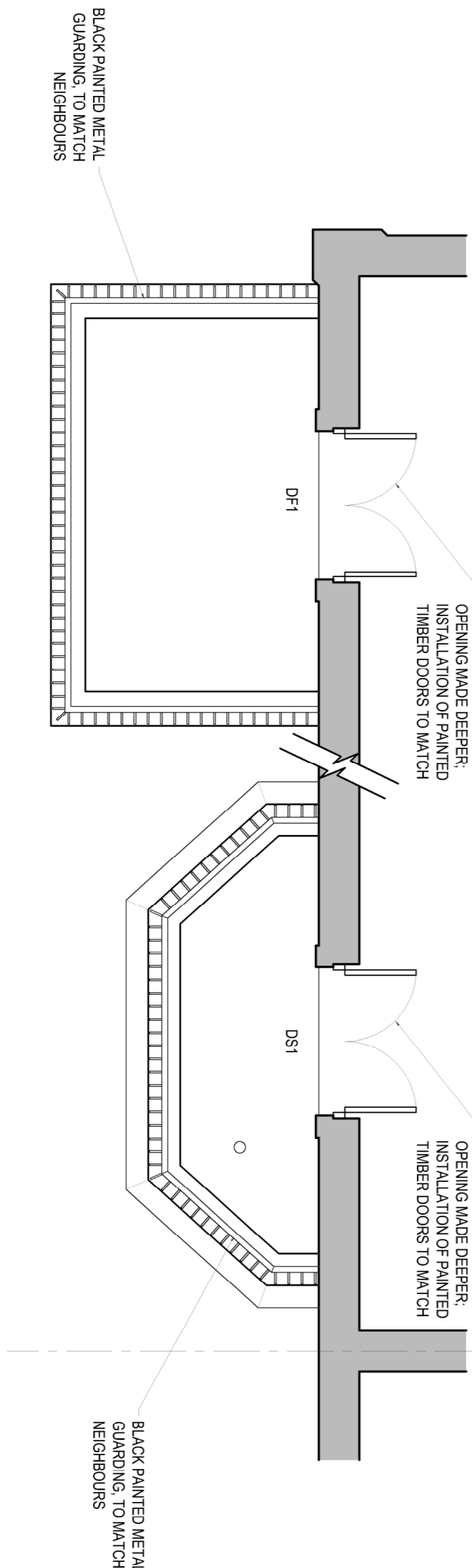
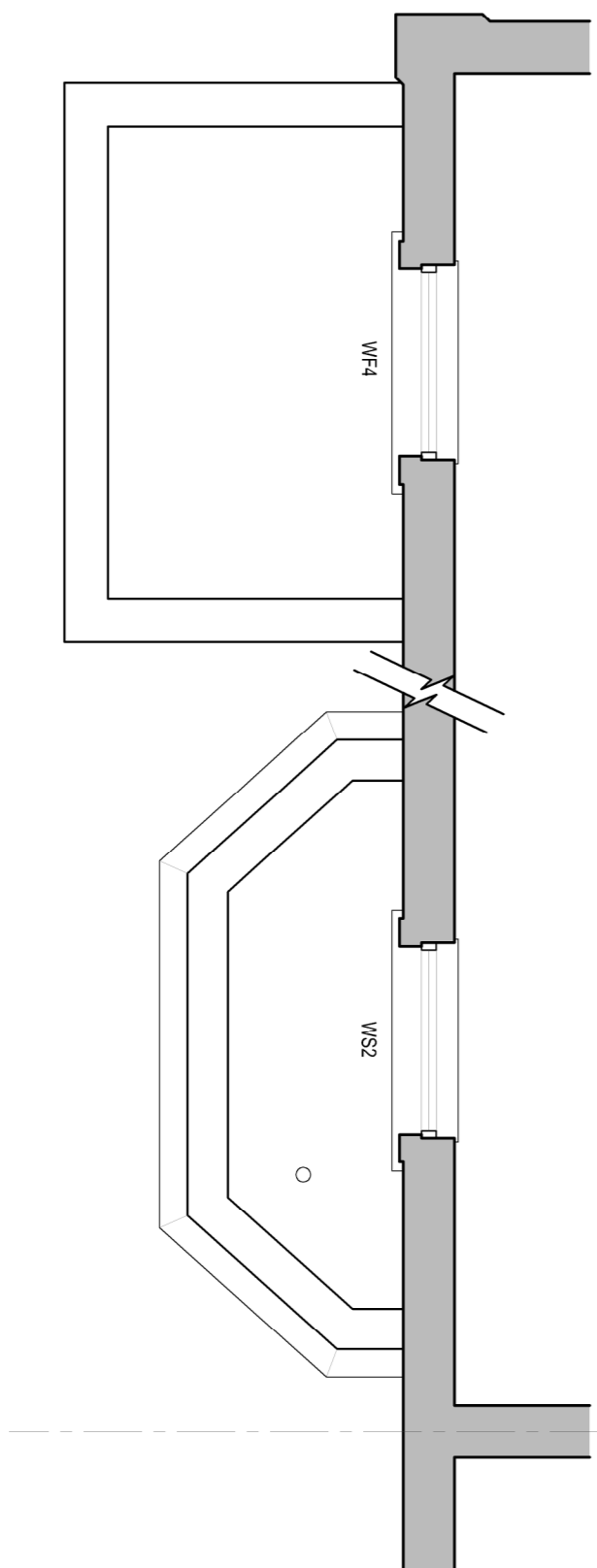

5 Split Part Plan

01 - Existing - 1 to 50

6 Split Part Plan

01 - Proposed - 1 to 50



The Studio, 74 Main Street, Great Gidding,

Huntingdon, PE28 5NU

T: 01832 293895

W: www.foliumarchitects.co.uk

Client:
IO Adamson Road Ltd

Project Title:
Renovation Works at
IO Adamson Road, Belsize Park,
London, NW15 3HK

Drawing Title:
Existing & Proposed Plans & Elevations

Scale: 1/50 @ A1 Date: March 2019

Project No: Stage: Dwg No: Rev:
279 P 01 a

Responsibility is not accepted for errors made by others in
scaling from this drawing. All construction information
should be taken from figured dimensions only.