

# Appendix 11: Tree Protection Plan

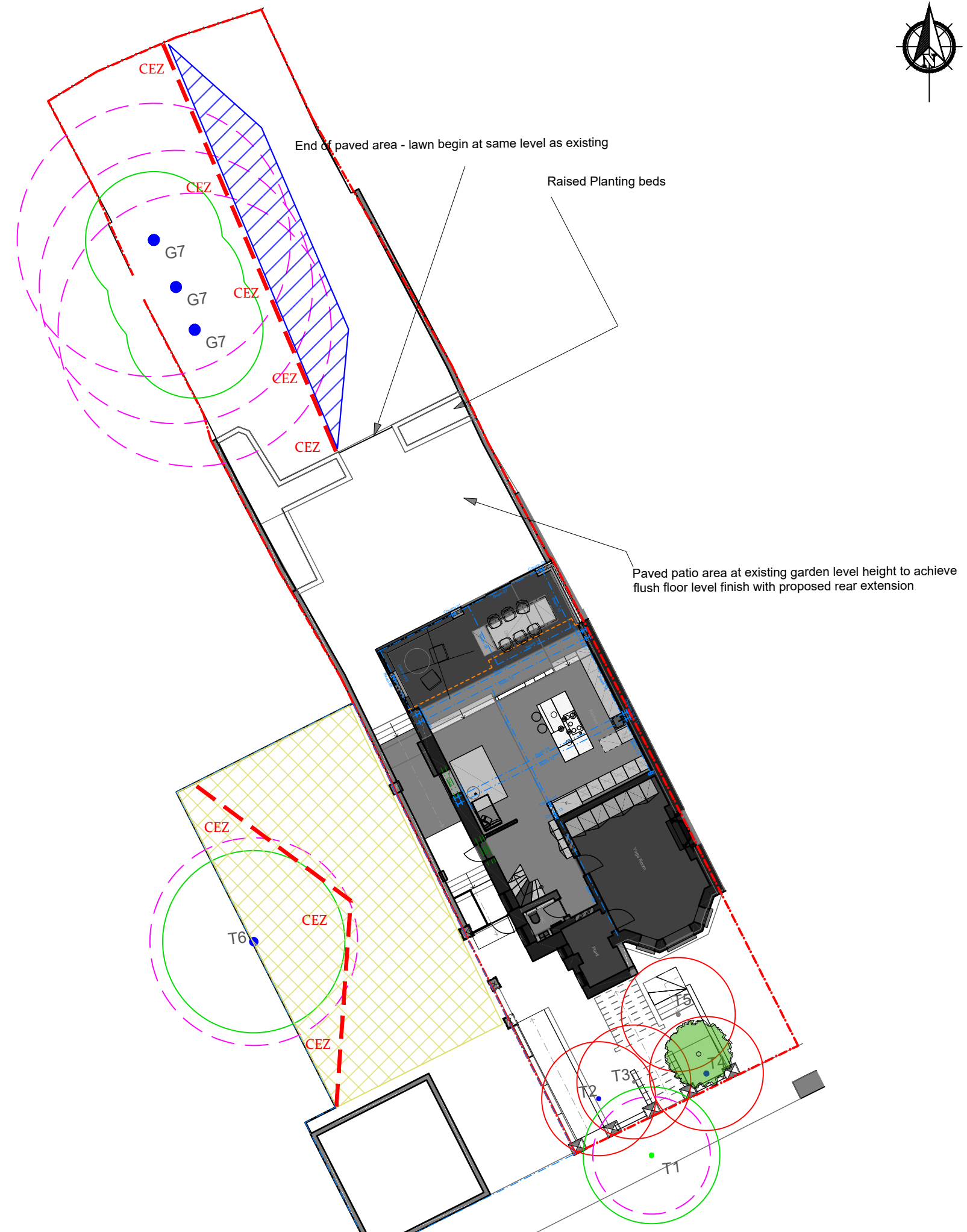

- At this site, operations are to occur in the following sequence:
1. Carry out tree work operations highlighted yellow in the tree data schedule (Appendix 2). All tree works are to be carried out by a competent and experienced arborist to current British Standards (see Appendix 5.9 for assistance finding a suitable arborist).
  2. Erect protective fencing along the position(s) shown by the dashed red line/s on the TPP.
  3. Lay ground protection and/or retain suitably hard-wearing existing hard surfaces within the area(s) shown by the diagonal blue lines on the TPP.
  4. Commence construction
  5. Remove tree protection when all construction activity has ended.
  6. Carry out tree planting and landscaping works.

- Temporary ground protection should be able to support any traffic entering or using the site without being distorted or causing compaction of underlying soil and might comprise one of the following:
1. For pedestrian-movements only, a single thickness of scaffold boards placed either on top of a driven scaffold frame, to form a suspended walkway, or on top of a compression-resistant layer (e.g. 100 mm depth of woodchip), laid onto a geotextile membrane;
  2. For pedestrian-operated plant up to a gross weight of 2 t, proprietary, inter-linked ground protection boards placed on top of a compression-resistant layer (e.g. 150 mm depth of woodchip), laid onto a geotextile membrane;
  3. For wheeled or tracked construction traffic exceeding 2 t gross weight, an alternative system (e.g. proprietary systems or pre-cast reinforced concrete slabs) to an engineering specification designed in conjunction with arboricultural advice, to accommodate the likely loading to which it will be subjected.

NOTE: If ground protection is to be laid near areas to be excavated, sheet piling should be used to shore up the sides of the excavations prior to being used (by pedestrians or machinery)

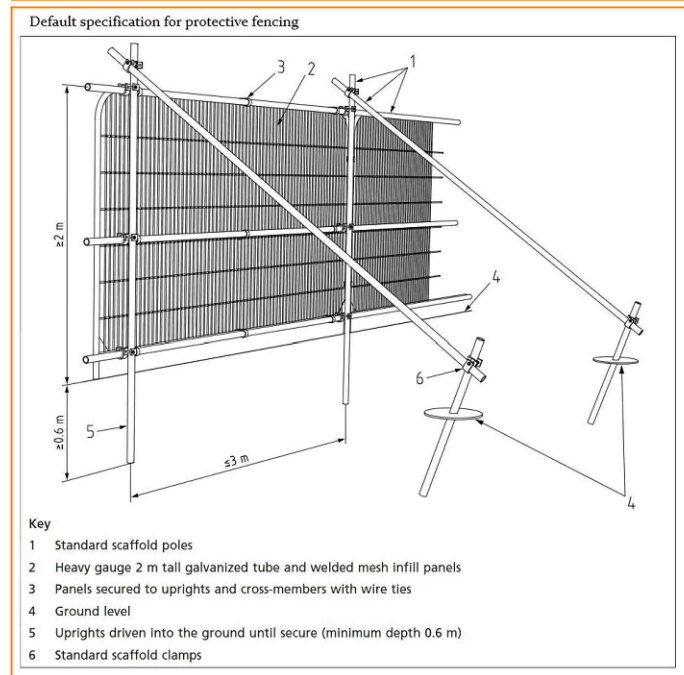

### Plan Legend

- Tree/s to be retained
- Tree/s to be removed

Centre colours

- Category A Tree
- Category B Tree
- Category C Tree
- Category U Tree

Groups are shown as polygons using the above colours to represent quality

- Root Protection Area (RPA)  
If amended, the original is a dotted blue circle
- Protective fencing
- Construction & storage exclusion zone
- Ground protection
- Existing hard surface to remain
- Suggested tree planting location for a new Malus 'Evereste' tree

Scale: 1:200 @ A3  
0 4m 8m

Site Address: 14 Prince Arthur Road Hampstead, London, NW3 6AU

Client: Mr and Mrs Holskjaer  
Drawing No: TH/A3/2171C/TPP

Job Ref: TH 2171C | Date: 25/03/2020

Trevor Heaps  
Arboricultural Consultancy Ltd



07957 763 533  
trevor@trevorheaps.co.uk  
www.trevorheaps.co.uk