

Furniture Legend



Tables:
600mm Ø black metal tables
6no. in total

Seats:
Timber wooden bench seats 1800x300mm with red metal frames 2no. in total
Black metal frame chairs 460mm wide x 570mm deep
8no. in total



Banners:
Fabric banners with brushed stainless posts 900mm high overall with typical artwork print. Positions and widths as shown on plan.
10no. posts with 6no. fabric banners in total

NOTE: All external furniture is free standing and stored within shop during non trading hours

TOTAL COVERS: 12no.

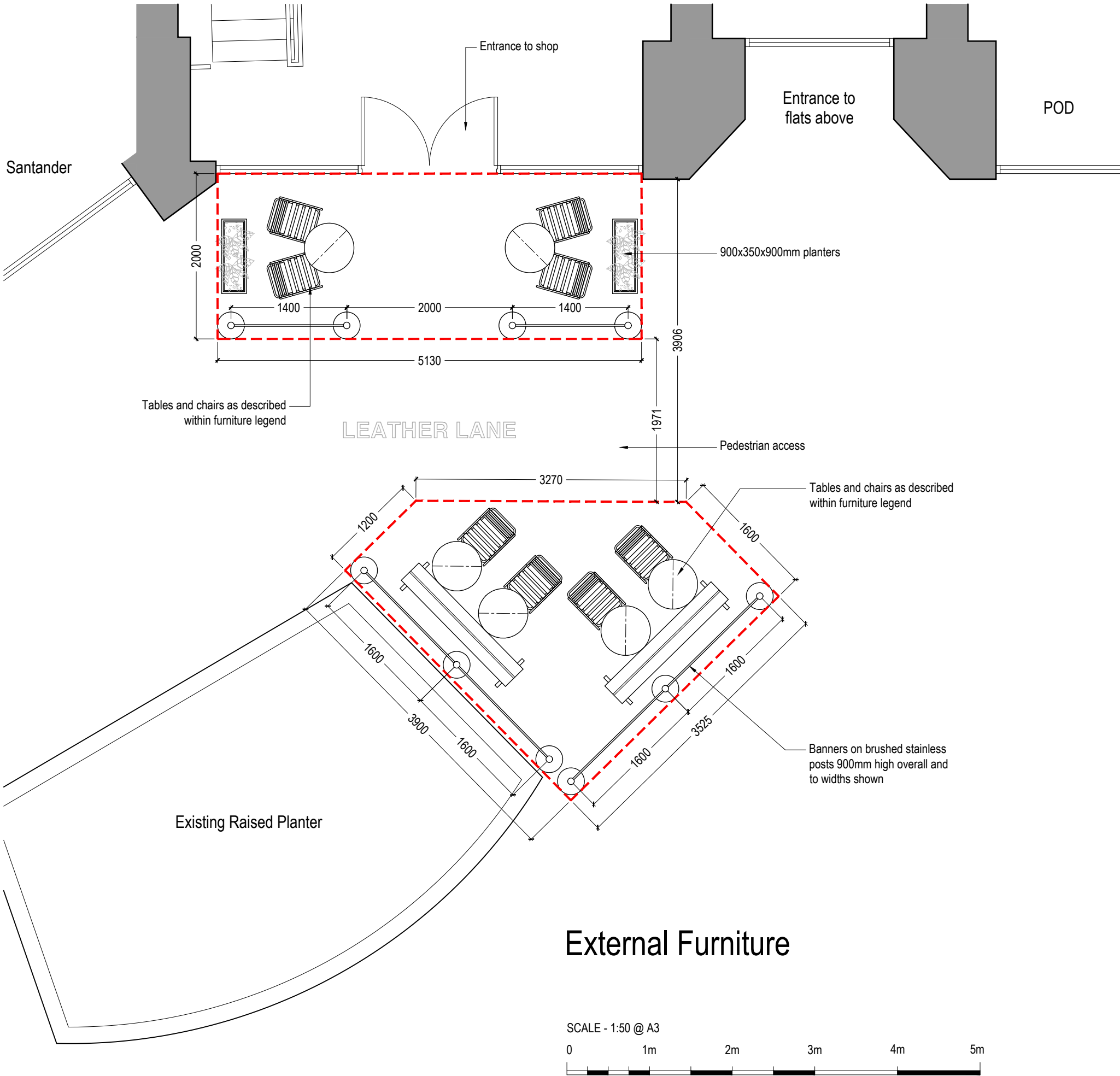

DO NOT SCALE FROM THIS DRAWING. THE AUTHOR OF THIS DRAWING TAKES NO RESPONSIBILITY FOR ANY DIMENSIONS OBTAINED BY MEASURING OR SCALING FROM THIS DRAWING AND NO RELIANCE MAY BE PLACED ON SUCH DIMENSIONS. ALL DIMENSIONS MUST BE CHECKED AND VERIFIED ON SITE BY THE CONTRACTOR BEFORE COMMENCING ANY WORK OR PRODUCING DRAWINGS. RML ARCHITECTURE MUST BE NOTIFIED IMMEDIATELY OF ANY ERRORS OR DISCREPANCIES PRIOR TO THE COMMENCEMENT OF WORK.

THIS DRAWING AND ALL INFORMATION CONTAINED WITHIN IS THE SOLE PROPERTY OF RML ARCHITECTURE LTD AND MAY NOT BE REPRODUCED IN WHOLE OR PART WITHOUT WRITTEN PERMISSION FROM RML ARCHITECTURE LTD.

REV	DESCRIPTION	DATE	BY
A	Remote seating location amended.	03-11-16	RML



CLIENT



PROJECT
COCO LEATHER LANE
10 LEATHER LANE
LONDON
EC1N

DRAWING TITLE
EXTERNAL SEATING

PROJECT No. 5502
DRAWN BY EA

SCALE 1:50 @ A3
DATE JUNE '16

DRAWING NO. 5502-P-07
REVISION A

DRAWING STATUS
APPROVAL

RMLArchitecture

12 Albion Street Brighton BN2 9NE
07973 151 494