

revision / date / amendments

- / 26/01/18 /	- First Issue
A / 02/02/18 /	- Addition of acoustic wall near bar in Jazz bar
B / 01/03/18 /	1. Indicative location of AHU + attenuator over stage. 2. Window numbers updated in line with window schedule.
C / 23/03/18 /	1. Tender Addendum (1). Indication of 4 post truss fixed at stage level for integrated automatic retractable acoustic baffles and integrated lighting rig. 2. Tender Addendum (2). New AHU + Attenuator over stage to be hung to existing relocated secondary beams in Flytower.
D / 12/04/18 /	- Window and door numbers updated
E / 01/06/18 /	1. Indication of 4 post truss fixed at stage level for integrated automatic retractable acoustic baffles and integrated lighting rig. 2. New AHU + Attenuator over stage to be hung to existing relocated secondary beams in Flytower.
F / 05/07/18 /	- Updated stage 4 fit out interior and kitchen layouts.
G / 31/07/18 /	2.2. Alteration to ventilation Strategy to allow higher ceiling heights 2.3. Alteration to ventilation Strategy to allow higher ceiling heights
H / 15/08/18 /	2.4. Alteration to ventilation Strategy
I / 29/01/19 /	2.5. New Sash Windows to facade
J / 29/05/19 /	2.7. Louver added to elevation for ventilation to WC's
K / 30/10/19 /	2.8. Colour coding added to revised drawing RevG
L / 29/01/19 /	Retrospective Planning for Dome Propping up works. Ref: 2019/0695/L
M / 11/02/2020	Proposed Dome LBC Application for: 1. Permanent Dome Truss. 2. Dome Front Pier PFCs. 3. Replacement of Dome Copper Roof
	1. Following review of PFC location, PFCs to be chased into front piers and concealed. PFC size 400 x 200 D x 10 T. 2. Retrospective Planning for removal of listed fabric around temporary propping up works for Dome Truss. 3. Removal and reinstatement of high level H/L. 4. Removal and reinstatement of low level L/L. 5. Change to consented proposal. Refer to colour coded legend and annotations 1-5.

LEGEND

- Proposed Works
- Existing Building Fabric (K&O date Camden Palace Theatre (1900))
- Existing Building Fabric Hope & Anchor (approx. 1850)
- Existing Building Fabric Bayham Place (from 1875)
- Existing Modern Building Fabric Bayham Place (from 2004)
- Building fabric to be demolished
- Demolition of Roofing / Elevation / Wall
- Proposed Excavation
- Remove and retain in alternate location
- Retain and protect existing
- Retain, make good, ease and adjusted
- Means of escape Route
- Private Members Route
- Koko Customer Route
- Public Route
- Artist Route
- Proposed Riser
- Proposed Risers Above
- RM.6.03 Room Number
- D4.02 Door Number
- W4.05 Window Number
- Hope & Anchor Demise
- Koko Demise
- Bayham Street & 45 Bayham Place Demise
- Blue Roof
- Original brickwork exposed

11.02.2020

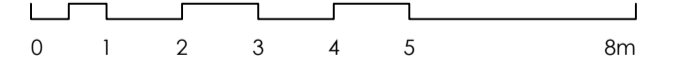
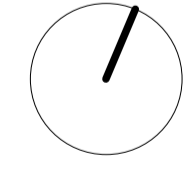

PLANNING

Archer Humphries Architects

Basement
Central House
142 Central Street
London, United Kingdom
EC1V 8AR
T: +44 (0) 20 7251 8555

project title	KOKO + Hope & Anchor + Bayham Place Camden, London
drawing title	Proposed Second Floor Plan
drawing number	AHA/KKG/GA/102
scale	1:100 (A1)
date	13.04.17
drawn	FR/PC
checked	DA
revision	M

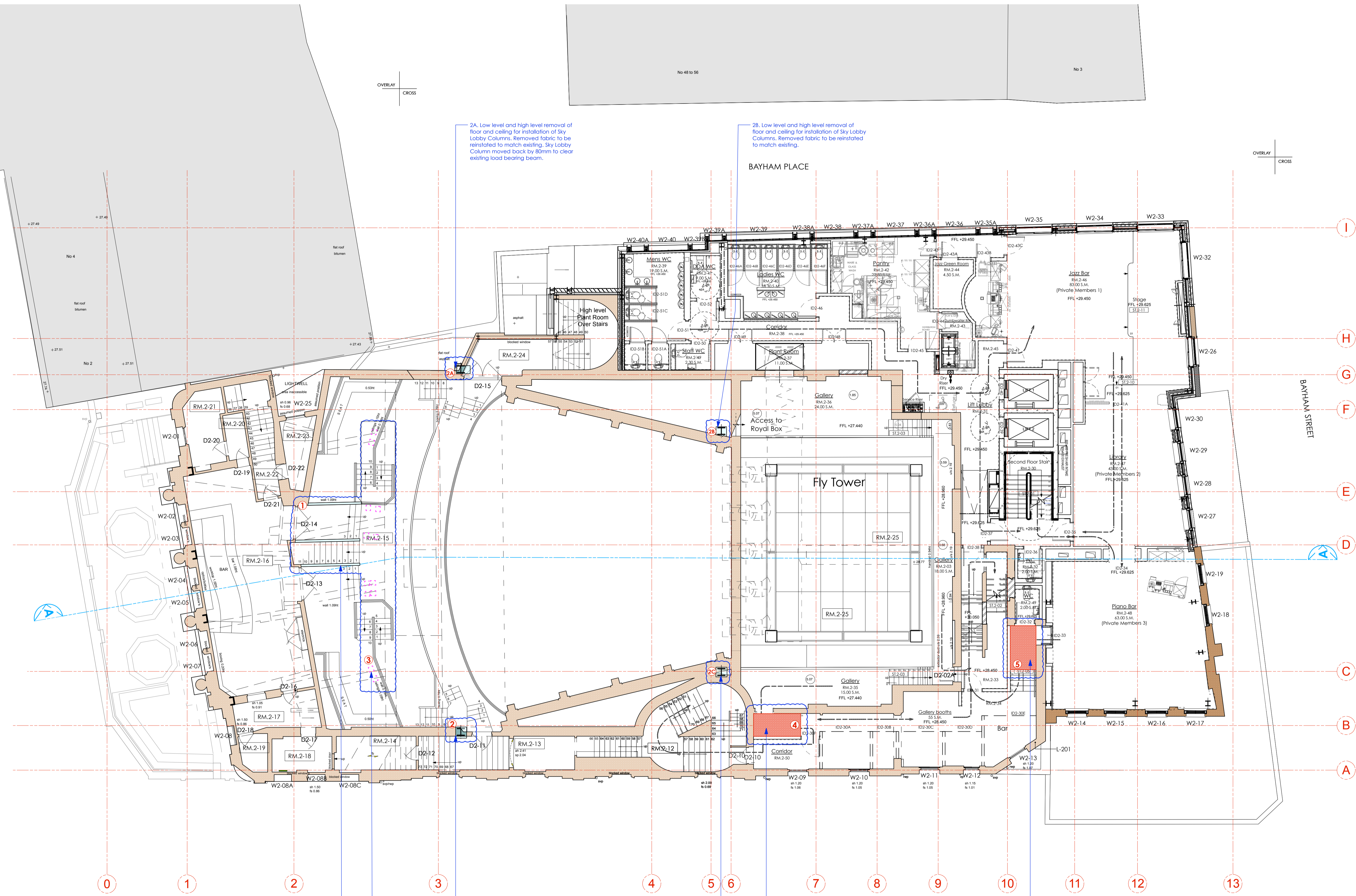

Legend for works under Retrospective application

- Removal and reinstatement of listed fabric at high level H/L
- Removal and reinstatement of listed fabric low level L/L
- Removal and reinstatement of listed walls
- Removal of listed walls / floors.
- Temporary Propping up for Dome Truss
- Change from consented proposal



1. Existing area of balustrade removed for installation of temporary propping up works for Dome truss. Balustrades to be replaced to match existing.

2. Low level and high level removal of floor and ceiling for installation of Sky Lobby Columns. Removed fabric to be reinstated to match existing.

3. Temporary Propping locations.

4. Area of floor to demolished for proposed consented works.

5. Area of floor to demolished further for proposed consented works.

2A. Low level and high level removal of floor and ceiling for installation of Sky Lobby Columns. Removed fabric to be reinstated to match existing. Sky Lobby Column moved back by 80mm to clear existing load bearing beam.

2B. Low level and high level removal of floor and ceiling for installation of Sky Lobby Columns. Removed fabric to be reinstated to match existing.

2C. Low level and high level removal of floor and ceiling for installation of Sky Lobby Columns. Removed fabric to be reinstated to match existing.